

PREVOST

Instruction Sheet

IS-10125

PROTECTOR AGAINST WATER SEEPAGE INSIDE THE EVAPORATOR COMPARTMENT BRUSHLESS DRIVE MOTOR CONTROL MODULE

NOTE: APPLICABLE TO BRUSHLESS DRIVE MOTOR #563586

H3-41 & H3-45 COACHES	From 2PCH334919C71 1409 up to 2PCH33493CC71 1872
H3-45 VIP MTH	From 2PCV334969C71 1411 up to 2PCVS3498BC71 1886
X3-45 COACHES	From 2PCG334919C72 9601 up to 2PCG33491BC73 5078
XLII MTH & ENTERTAINER	From 2PCY334979C72 9607 up to 2PCBS3499CC73 5070

MATERIAL

Kit #032937 includes the following parts:

Part No.	Description	Qty
033188	PROTECTOR	1
500443	SCREW ,SELF TAPPING PAN HEAD #8x1/2	5
IS-10125	Instruction Sheet	1
FI-10125	Feuille d'instructions	1

PROCEDURE



DANGER

Park vehicle safely, apply parking brake, stop engine and set battery master switch(es) to the OFF position prior to working on the vehicle.

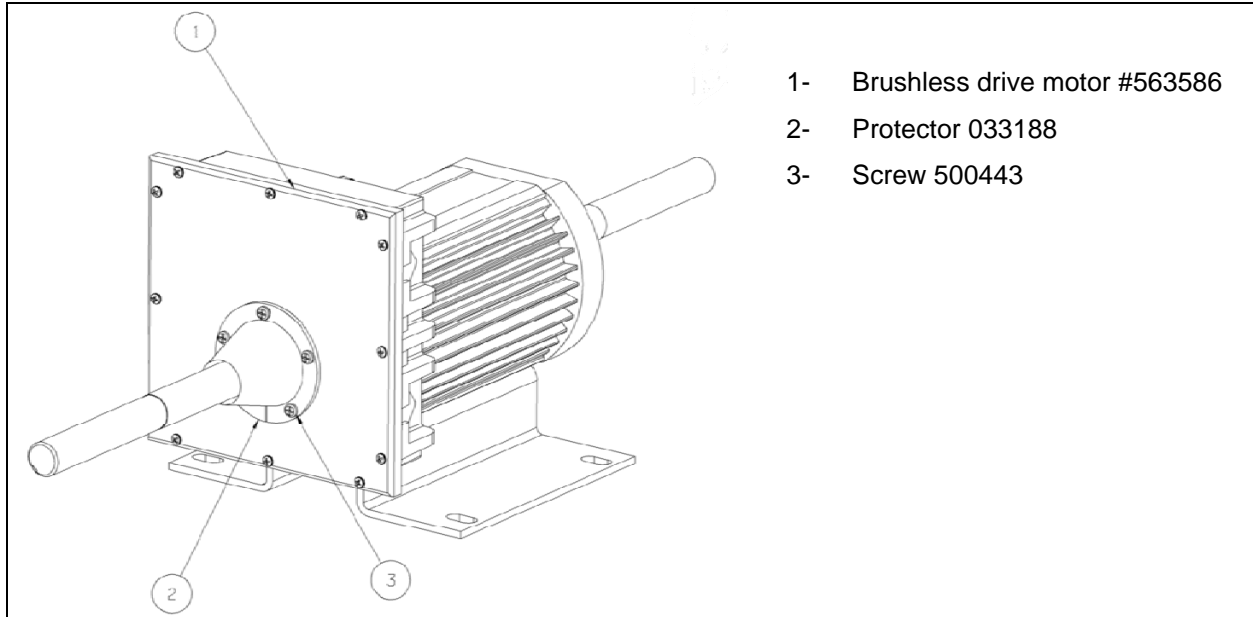

1. Place protector as shown on the image above. Make sure the protector parting cut is placed underneath.
2. Center protector and perform pre-drilling of a first hole through the module sheet metal. Fix protector with one screw.

Cautions, in order not to drill through the module internal components, DO NOT LET THE DRILL BIT GET DEEPER THAN ¼ INCH. Place electric tape on the drill bit as a limit reference.

3. Perform pre-drilling of a second hole and then add a screw.
4. Complete the other pre-drillings using the protector to position holes.
5. Remove protector. To assure watertightness, remove any steel filings that may remain between the protector flange and the sheet metal.
6. Finally, fix the protector with included screws.

In order to avoid water seepage, make sure that there is no gap between the protector flange and the sheet metal.