

PREVOST

Instruction Sheet

IS-94075A

REPLACEMENT OF A LOW COOLANT SENSOR ON THE SURGE TANK

Revision A :

FIGURE 3 HAS BEEN MODIFIED

Note: This instruction sheet applies to all Prévost vehicles made from 1978. The engine of these vehicles may be only of non-DDEC or mechanical type.

MATERIAL

Kit #064252 includes the following parts.

Part No.	Description	Qty
562436	Sensor	1
063939	Wiring Harness	1
050884	Coupling	1
501304	Plug	1
504012	Cable Tie	6
IS-94075	Instruction Sheet	1
FI-94075	Feuille d'instructions	1

PROCEDURE

Warning: Park vehicle safely, apply parking brake, stop engine and set battery master switch(es) to the OFF position prior to working on the vehicle.

Warning: Hot engine coolant is under pressure. To avoid skin burn, allow engine to cool down before working on the vehicle.

◇ OPEN ENGINE REAR DOORS.

◇ IF THERE IS INTERFERENCE BETWEEN JUNCTION BOX COVER AND THE SENSOR LOCATED ON THE SIDE OF THE SURGE TANK, THEN PERFORM PROCEDURE A FOLLOWED BY PROCEDURE B.

◇ OR ELSE PERFORM PROCEDURE B ONLY.

Note: This interference may happen at the junction box cover opening, in particular on 96 inch wide vehicles.

PROCEDURE A

Note: Perform the following procedure, only if there is interference between junction box cover and sensor.

1. Disconnect surge tank draining hose (Fig. 1).

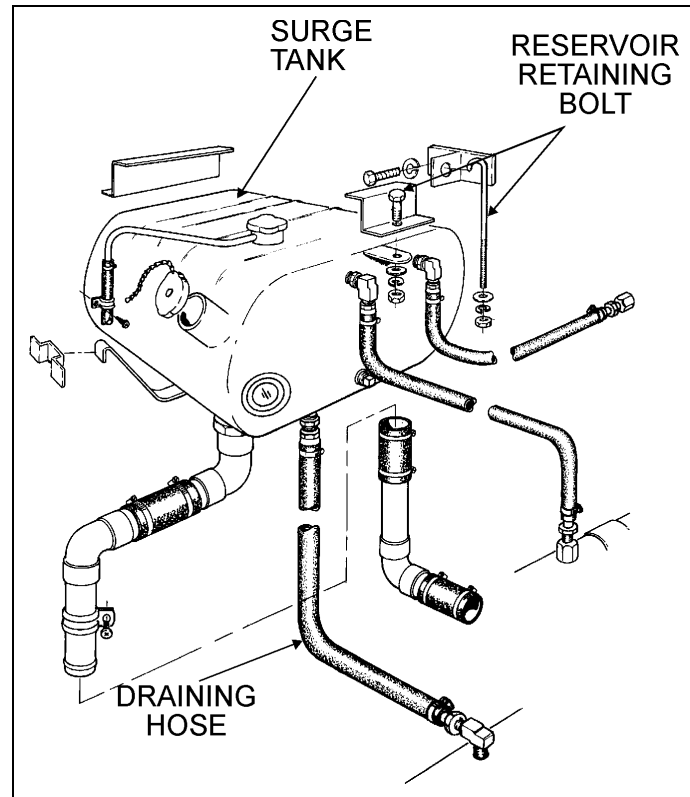

FIGURE 1: SURGE TANK

05048

2. Recover coolant from surge tank in an appropriate volume container (approximately 2.6 gallons (10 liters)).
3. Disconnect all pipes and hoses connecting to surge tank.
4. Change old sensor located on surge tank side by plug #501304.
5. Remove surge tank retaining bolt (Fig. 1). Remove surge tank from motor compartment.
6. Make a hole in surge tank with a $\frac{3}{4}$ inch diameter drill. For hole location, refer to figure 2.

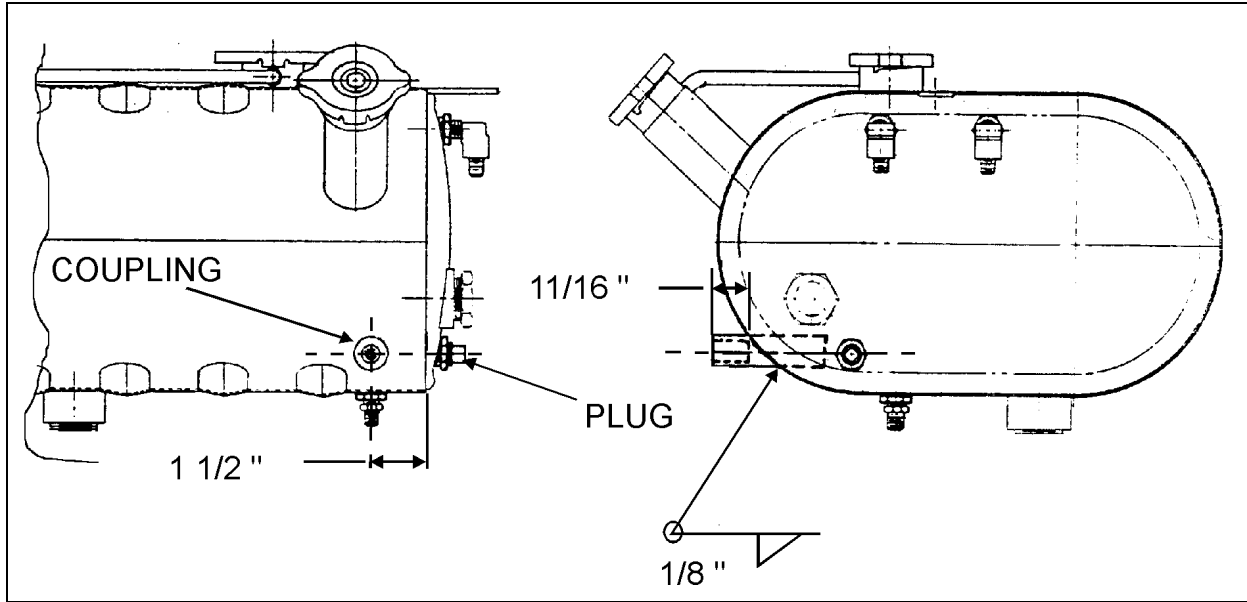

FIGURE 2: SURGE TANK

05049

7. Grind hole contour (approximately ½ inch over hole edge).
8. Rinse surge tank with water to remove drilling metal particles.
9. Put the non-threaded side of the coupling part into surge tank and weld.
10. Install surge tank, pipes and hoses.
11. Screw new sensor #562436 in the coupling part.
12. Fill surge tank with the coolant previously recovered in the container.

PROCEDURE B

Warning: For PROCEDURE B, sensor changing can be done without surge tank draining. It is normal that coolant escapes from the hole where the sensor is screwed. To avoid skin burn, allow engine to cool down.

1. Replace the old sensor with sensor #562436. Disregard this step if it's done after PROCEDURE A.
2. Locate and open the rear junction box.
3. Replace the old wiring harness with wiring harness #063939 (Fig. 3).
4. Connect one extremity of the wiring harness to sensor.
5. Find the vehicle identification number "V.I.N.". Refer to Chart 1 for connection in rear junction box. Connect the other extremity to junction box terminal.

CHART 1				
96" WIDE VEHICLES				
From (VIN)	Prior to (VIN)	Circuit Number	Wiring Color	Terminal Number (Junction box)
P-450-2025-71	C-102-2454-78	0	Black	BL
		83	Red	WH
		125	Blue	GR
P-102-2455-78	LM-103-2813-80	0	Black	BL
		83	Red	20
		125	Blue	55
LM-103-2813-80	2P9L33406E1001638	0	Black	BL
		83	Red	20 or Ign. Bus Bar
		125	Blue	55
102" WIDE VEHICLES				
2P9L33406E1001638	2P9M33406L1001706	0	Black	BL
		83	Red	20 or Ign. Bus Bar
		125	Blue	55
2P9L33401M1001707	---	0	Black	69
		83	Red	58
		125	Blue	55

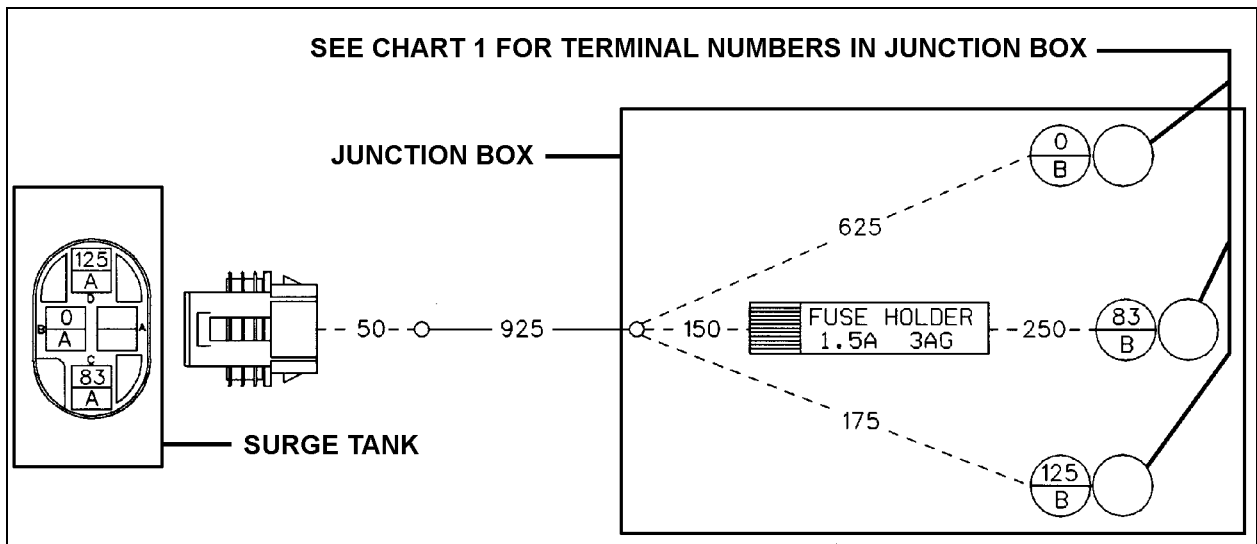

FIGURE 3: WIRING HARNESS CONNECTION

05050

Note: The wiring harness fuse holder must be inside junction box.

4. Apply Silicone on junction box wiring harness hole.
5. Secure wiring harness using cables ties #504012.

Note: Install a cable tie on sensor connection.

6. Close the rear junction box and engine rear doors.