

PREVOST

WARRANTY BULLETIN

WB24-19

DATE :	August 2024	SECTION :	22 HVAC
EXPIRATION:	August 2026		
SUBJECT :	TEMPERATURE SENSOR RELOCATION		

First Release

08-29-2024

APPLICATION

NOTICE TO SERVICE CENTERS <i>Verify vehicle eligibility by checking warranty bulletin status with SAP or via ONLINE WARRANTY SYSTEM available on Service / Warranty tab of Prevost website.</i>	
Model	VIN
	<small>VIN: [REDACTED] PREVOST CAR INC. 175 CLARE BORHESTER QUB. CANADA</small>
H3-45 VIP motorhomes Model Year: 2022	2PCVS3498NC721211 2PCV33490NC721247 2PCVS3491NC721258 2PCVS349XNC721274 2PCVS3491NC721308
H3-45 VIP motorhomes Model Year: 2023 - 2025	From 2PCVS3499PC721348 up to 2PCV33490SC722037 incl.
This bulletin does not necessarily apply to all the above-mentioned vehicles, some vehicles may have been modified before delivery. The owners of the vehicles affected by this bulletin will be advised by a letter indicating the Vehicle Identification Number (VIN) of each vehicle concerned.	

DESCRIPTION

On the vehicles affected by this bulletin the temperature sensor must be relocated for better temperature control.

MATERIAL

Order kit **WB24-19** which contains the following parts:

Part No.	Description	Qty
455465	KIT AIR RETURN DEFROSTER SENSOR	1

kit **455465** which contains the following parts:

Part No.	Description	Qty
0600352	EXTENSION CABLE HVAC SENSOR	1
3202184	SENSOR ADAPTOR PLATE	1
5001305	SCREW MACHINE ROUND PH SS 8-32X3/4	2
5002031	WASHER FLAT SS NSS 4.3X12X1	2
500678	NUT WELL 8-32X.450	2
504637	CABLE TIE, NYLON BLACK (STD)	5

Other parts that required. **Note that these parts are not covered by this bulletin:**

Part No.	Description	Qty
682484	TAPE ALUMINUM ADH1 .005" x 3" x 300'	AR

NOTE

Material can be obtained through regular channels.

SAFETY PRECAUTIONS

- Eye protection should always be worn when working in a shop.
- Rules for Personal Protection Equipment should always be respected. Wear your PPE including but not limited to the following:



Safety First!



PROCEDURE



DANGER

Park vehicle safely, apply parking brake, stop the engine. Prior to working on the vehicle, set the ignition switch to the OFF position and trip the main circuit breakers equipped with a trip button. On the Commuter type vehicles, set the battery master switch (master cut-out) to the OFF position.

Lockout & Tag out (LOTO) must be performed during set-up, maintenance or repair activities. Refer to your local procedure for detailed information regarding the control of hazardous energy.

**CAUTION**

If access to the air return grill was obstructed during the vehicle conversion. Please refer to the section **“move the sensor if duct grill cannot be remove (option)”**.

MOVE THE SENSOR

1. Open front service door.

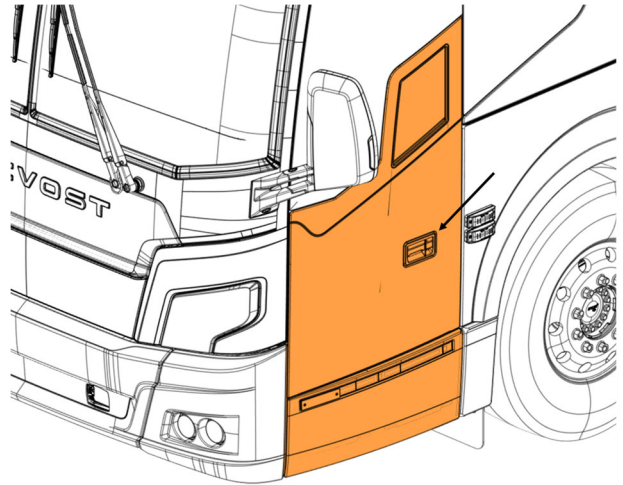

2. Unlatch the front bumper.

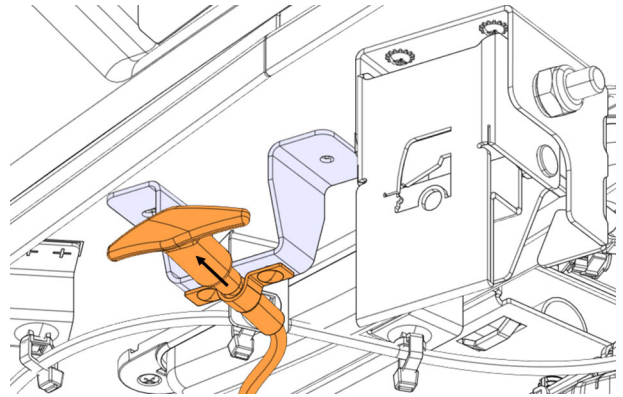

3. Open the front bumper.

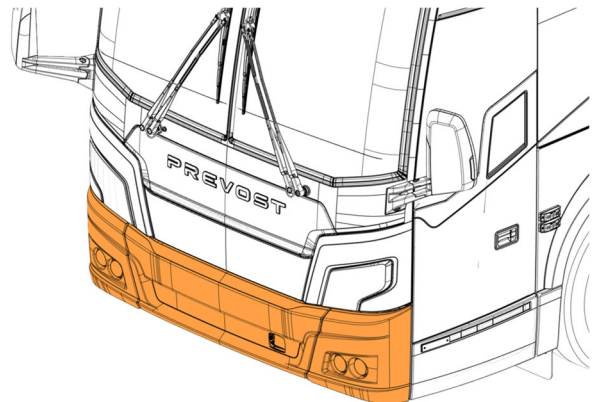

4. Remove the top access panel and the screws (4x) inside the compartment.

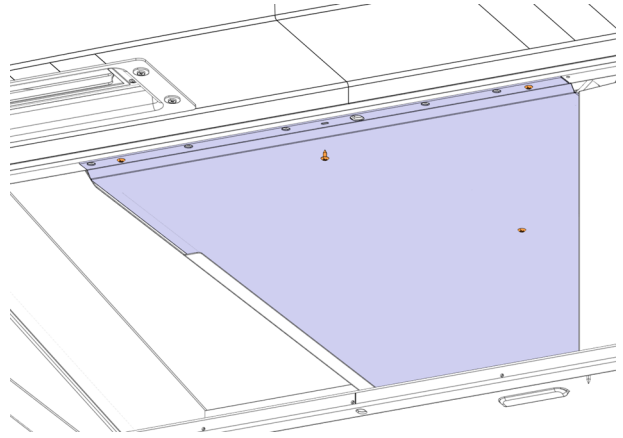

5. Locate the sensor.

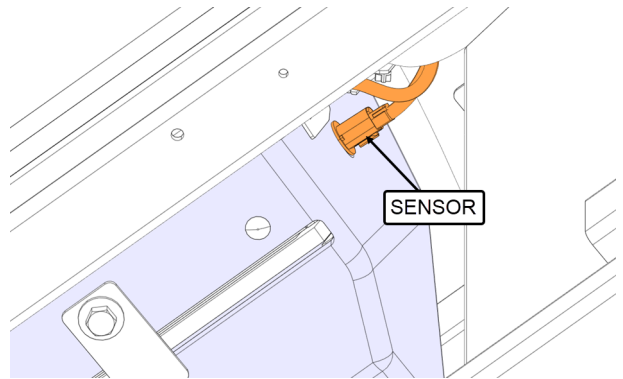

6. Disconnect the sensor.

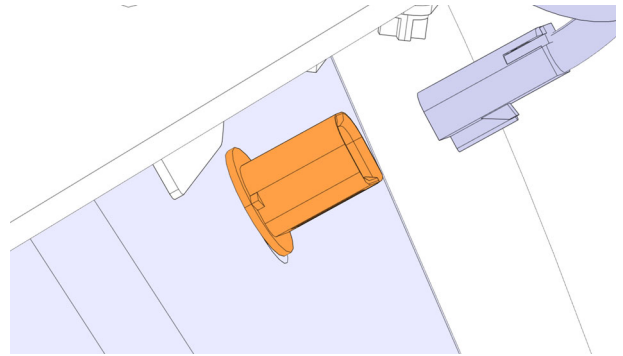

7. Remove the sensor.

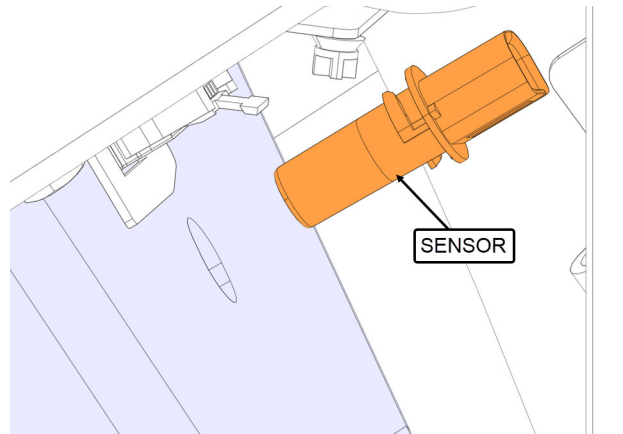

8. Apply aluminum tape 682484 on the sensor hole.

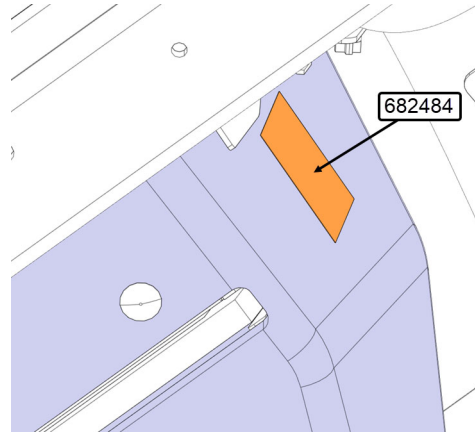

9. Remove the grill and screws (6x).

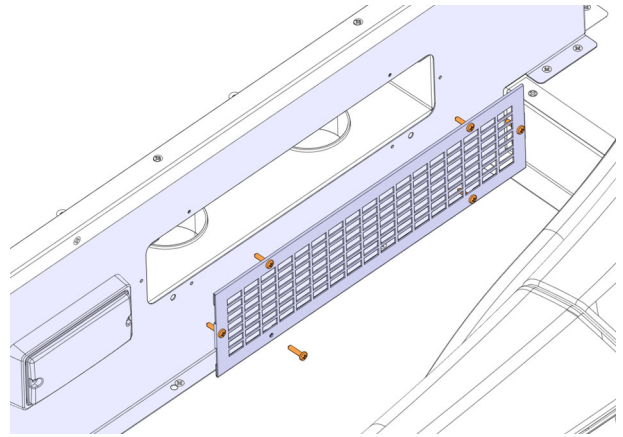

10. Use sensor adaptor plate as template.
Center the plate in middle of the air duct.
11. Mark the position of the center of each hole (3x).

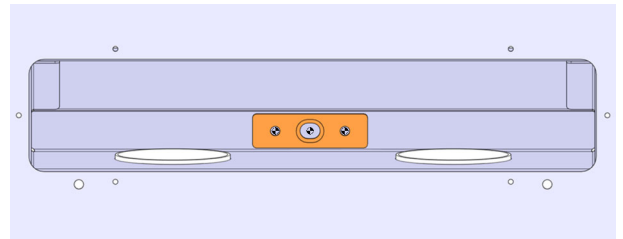

12. Drill the pilot holes (3x).

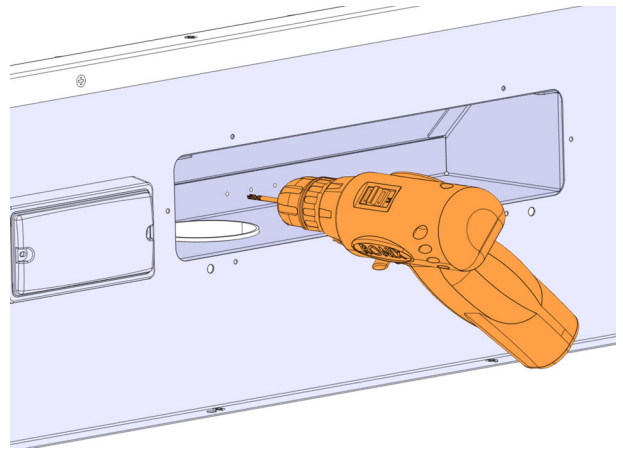

13. Drill two holes of 5/16 Ø.

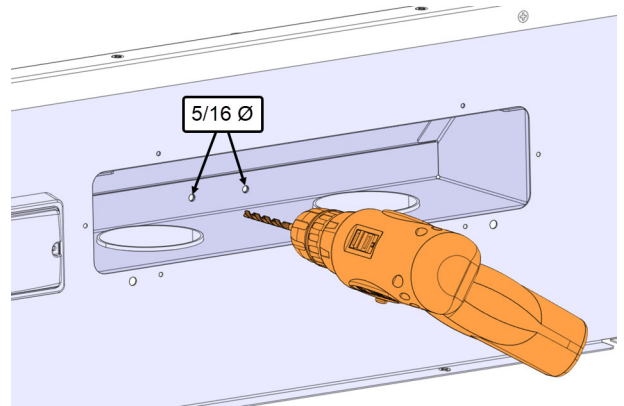

14. Drill one hole of 11/16 Ø.

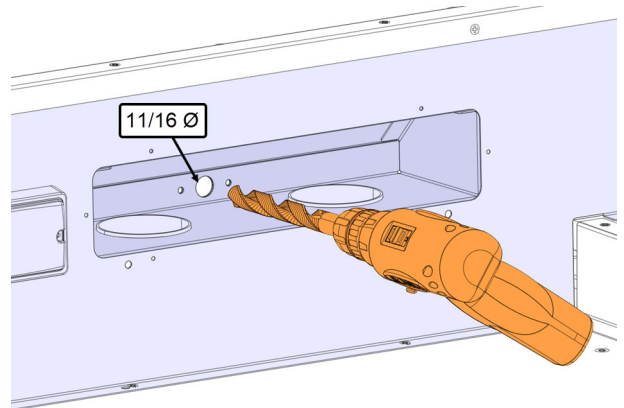

15. Install the sensor on the new adaptor plate 3202184.

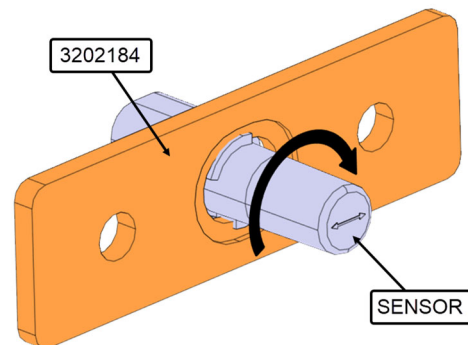

16. Install the well nuts 500678 (2x).

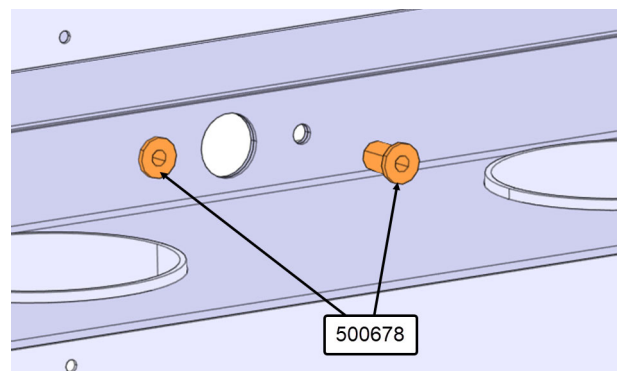

17. Install the sensor inside the duct with the screws 5001305 (2x) and the washers 5002031 (2x).

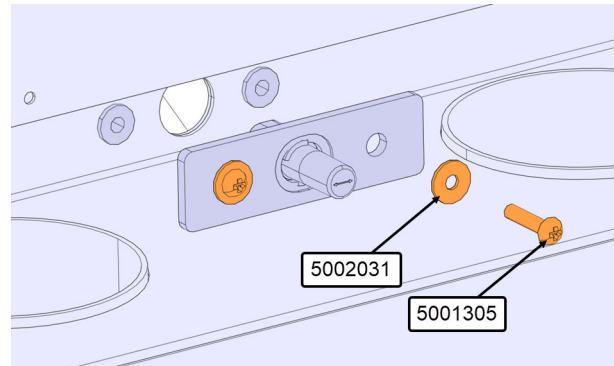

18. Reinstall the grill with the screws (6x).

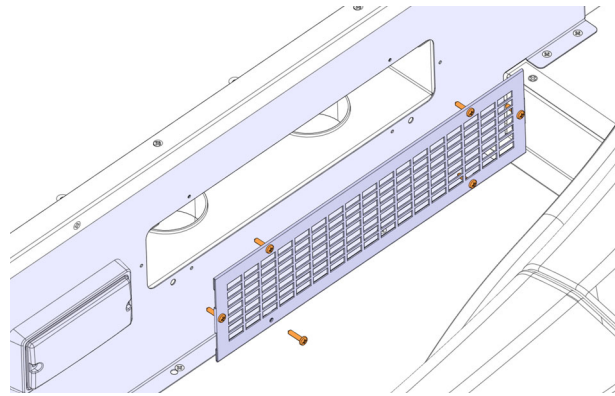

19. Connect the new sensor extension cable 0600352 connector **C21A** to **Se21** connector of the front harness

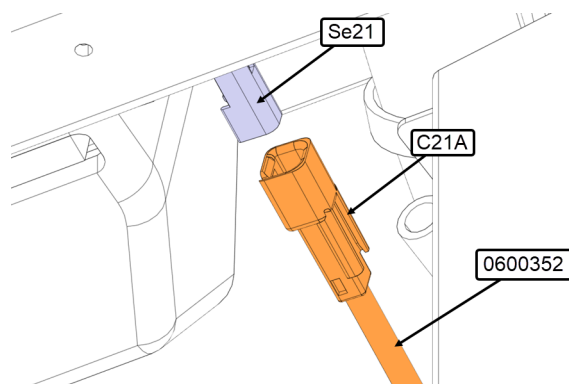

20. Run the new sensor extension cable 0600352 along air return pipe.

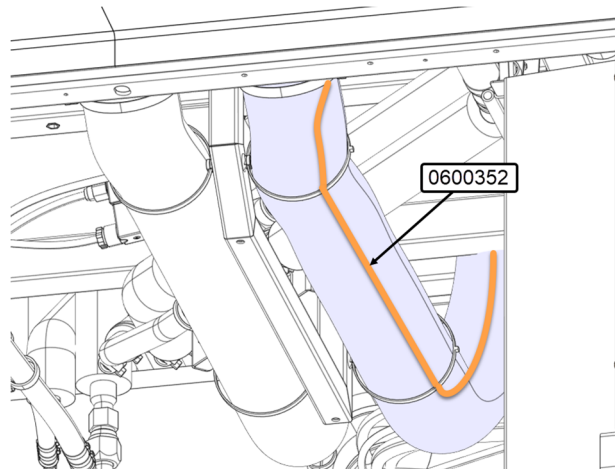

21. Connect the new sensor extension harness 0600352 connector **C21AA** to the sensor.

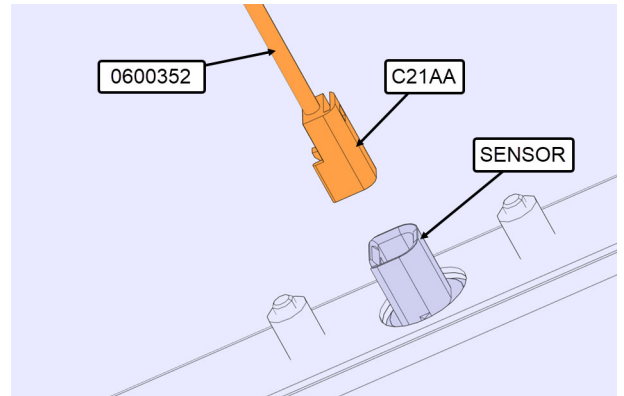

22. Secure the harness 0600352 to the air return pipe with cable tie 504637 (5x).

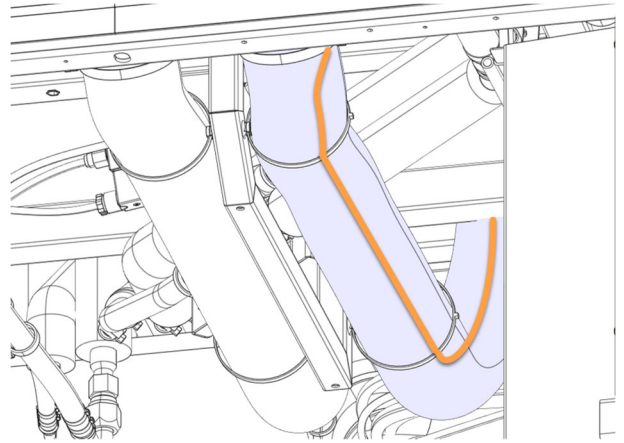

23. Reinstall the top access panel with the screws (4x) inside the compartment.

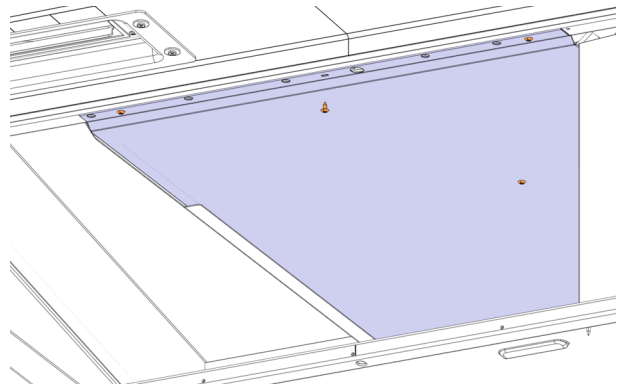

24. Close the front bumper.

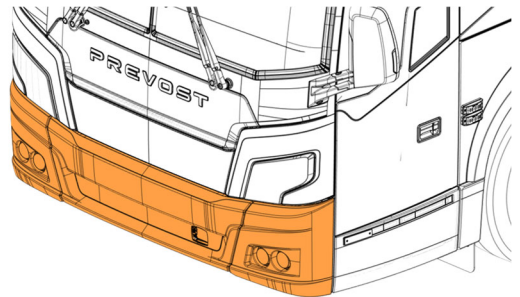

25. Close front service door.

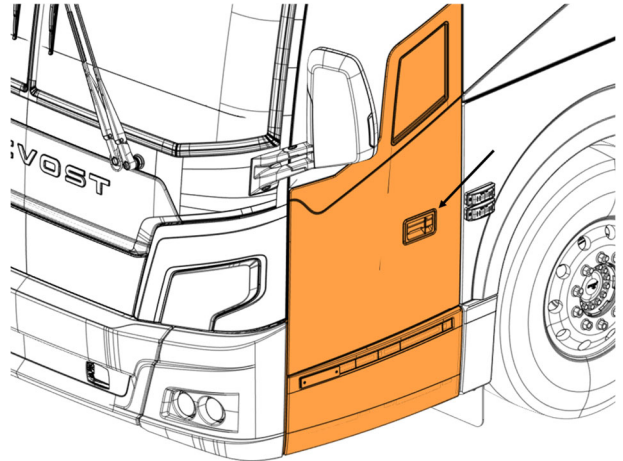

MOVE THE SENSOR IF DUCT GRILL CANNOT BE REMOVE (OPTION)

1. Open front service door.

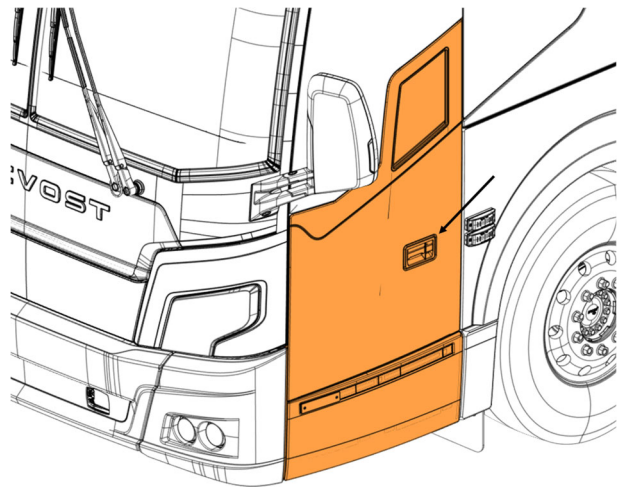

2. Unlatch the front bumper.

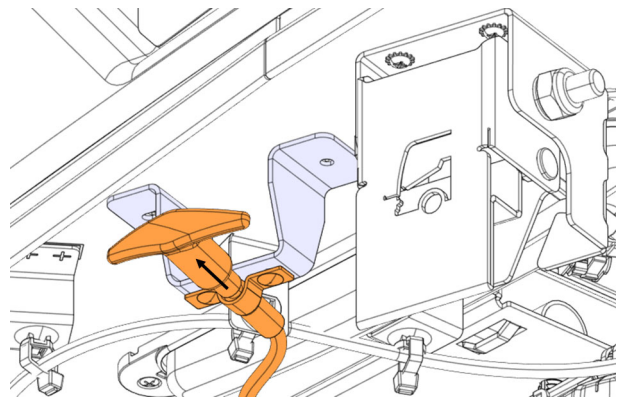

3. Open the front bumper.

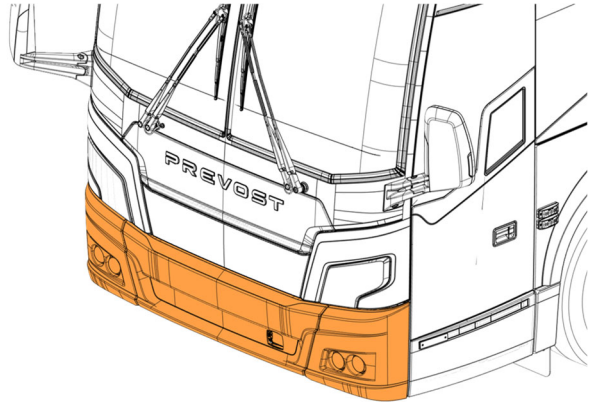

4. Remove the top access panel and the screws (4x) inside the compartment.

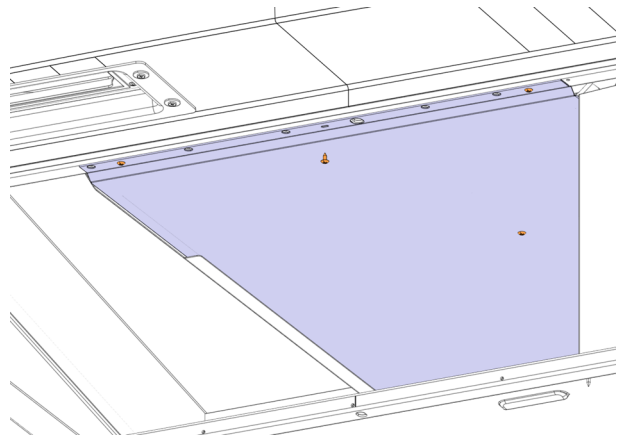

5. Locate the sensor.

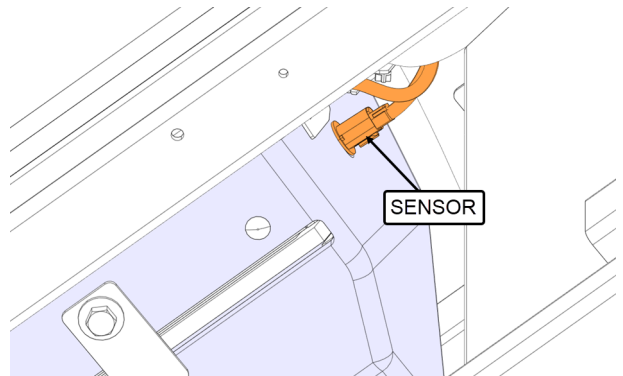

6. Disconnect the sensor.

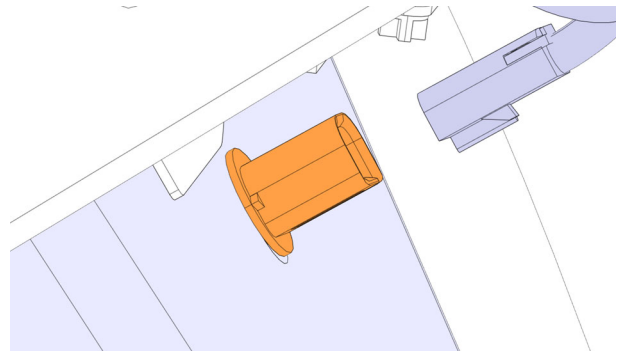

7. Remove the sensor.

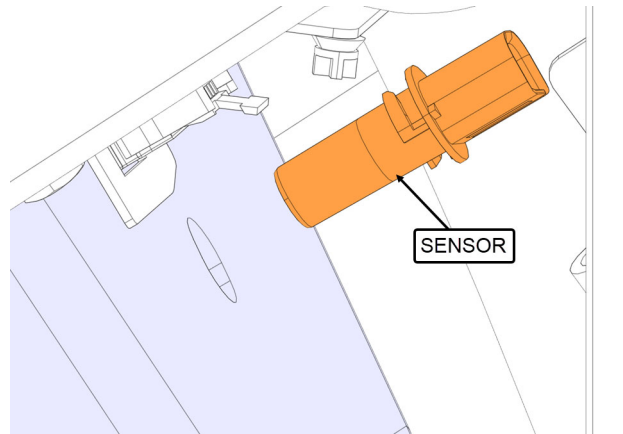

8. Apply aluminum tape 682484 on the sensor hole.



9. Use sensor adaptor plate as template.
Center the plate in middle of the air duct.

10. Mark the position of the center of each hole (3x).

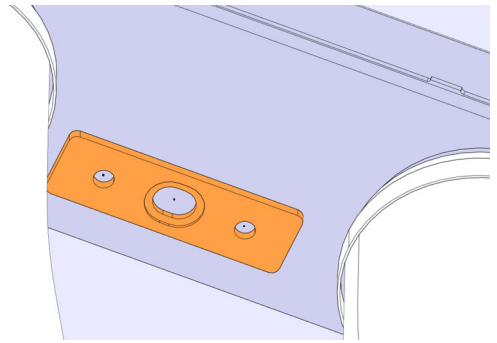

11. Drill the pilot holes (3x).

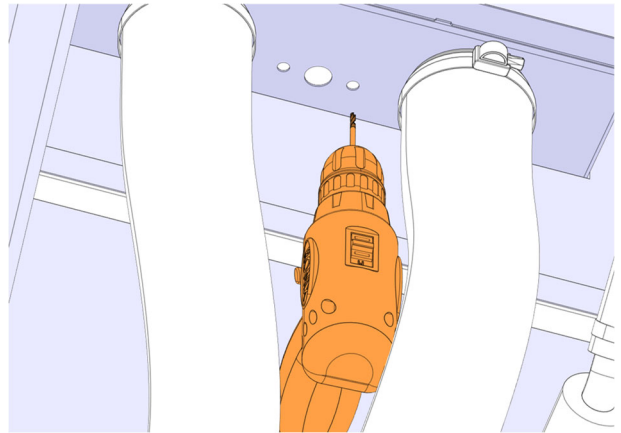

12. Drill two holes of 5/16 Ø.

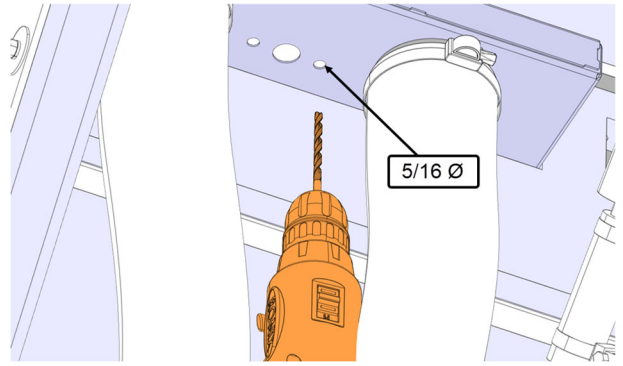

13. Drill one holes of 11/16 Ø.

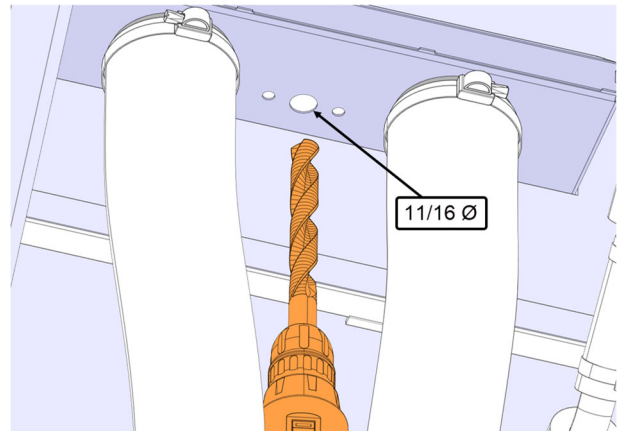

14. Install the sensor on the new adaptor plate 3202184.

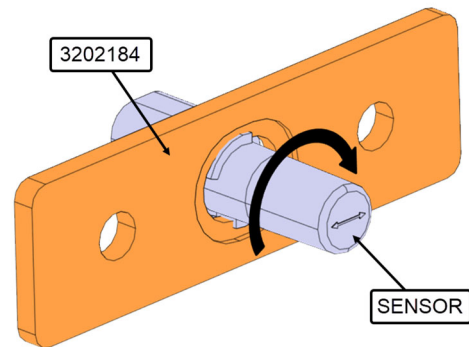

15. Install the well nuts 500678 (2x).

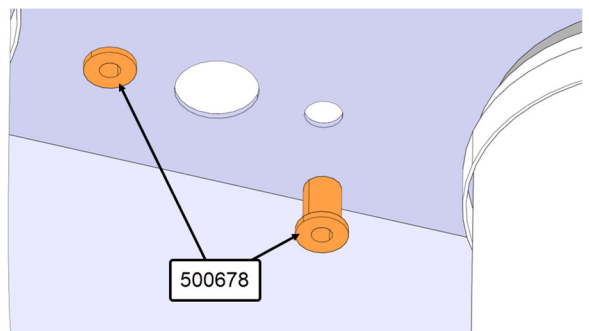

16. Install the sensor inside the duct with the screws 5001305 (2x) and the washers 5002031 (2x).

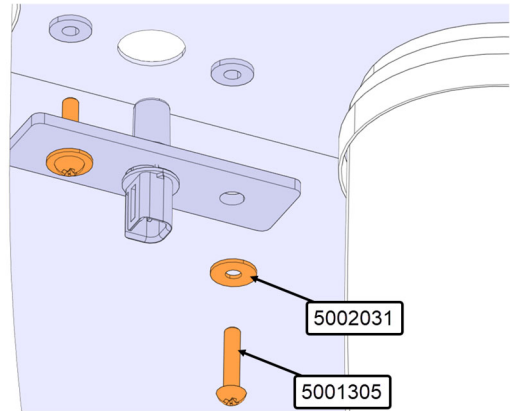

17. Connect the new sensor extension cable 0600352 connector **C21A** to **Se21** connector of the front harness

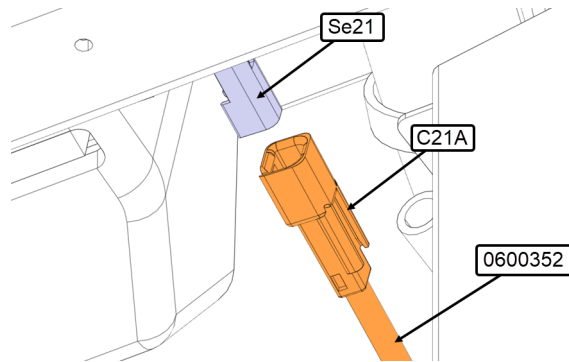

18. Run the new sensor extension cable 0600352 along air return pipe.

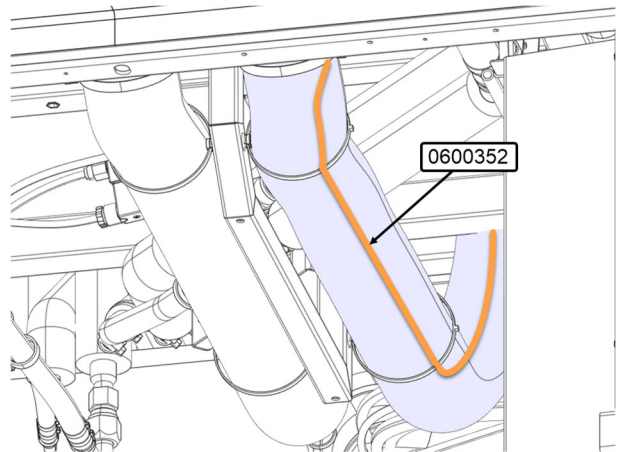

19. Connect the new sensor extension harness 0600352 connector **C21AA** to the sensor.

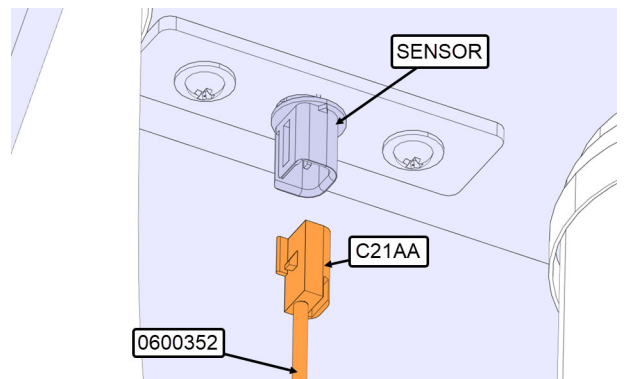

20. Secure the harness 0600352 to the air return pipe with cable tie 504637 (5x).

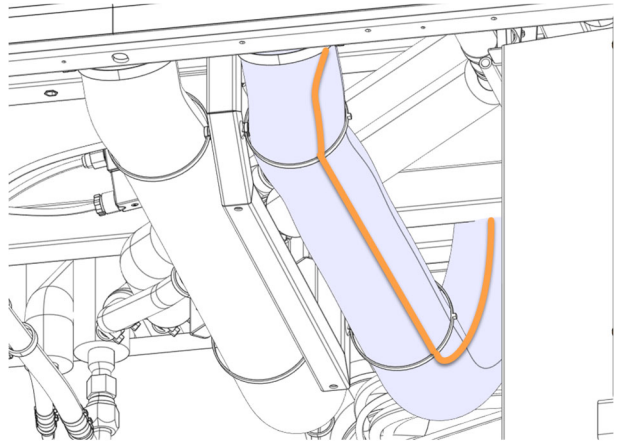

21. Reinstall the top access panel with the screws (4x) inside the compartment.

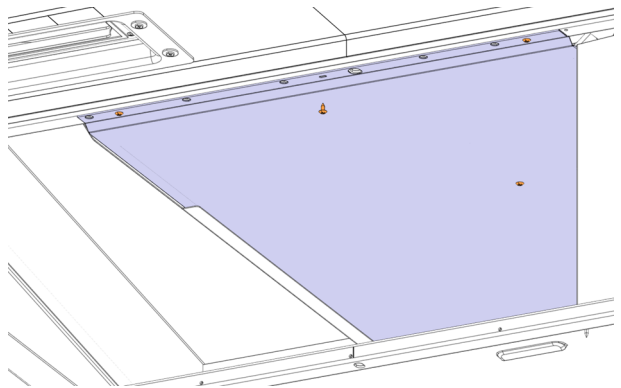

22. Close the front bumper.

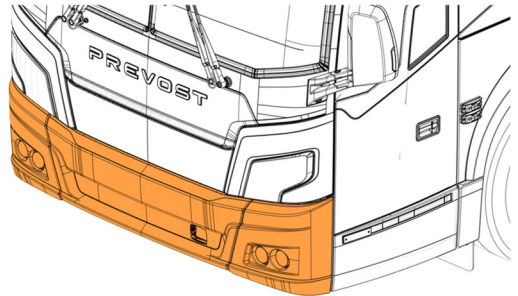

23. Close front service door.

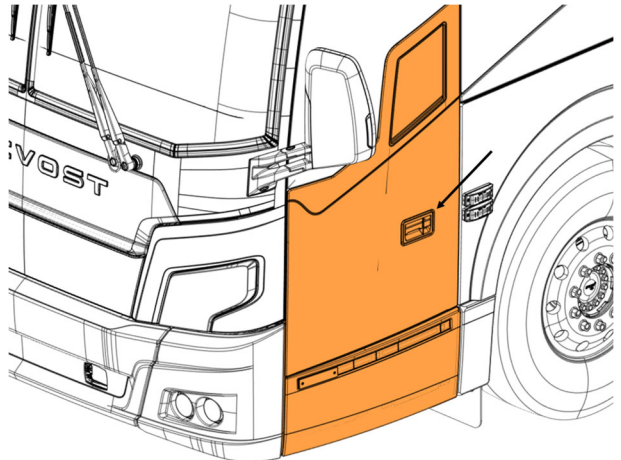

PARTS / WASTE DISPOSAL

DO NOT RETURN THE REPLACED PARTS. Discard waste according to applicable environmental regulations (Municipal/State[Prov.]/ Federal)

WARRANTY

This modification is covered by Prevost's normal warranty. We will reimburse you the parts and three hour(s) (3.0) of labor upon receipt of a warranty claim. Please submit claim via our Online Warranty System, available at www.prevostcar.com (under Service \ Warranty section).

Prevost is not responsible for any excess workload if access to the air return grill was obstructed during the vehicle conversion. Please refer to the Converter.

- Use Claim Type: "Bulletin/Recall" and select "Warranty Bulletin WB24-19".

OTHER

VBC Bulletin	N/A
Fail Code	22.01
Defect Code	09
Syst. Cond	B
Causal Part	564318

Access all our Service Bulletins on
<http://techpub.prevostcar.com/en/>
or scan the QR-Code with your smart phone.



Are you a Vehicle owner? E-mail us at
technicalpublications_prev@volvo.com and type "ADD" in the
subject to receive warranty bulletins applicable to your vehicle(s)
by e-mail.