

**PREVOST**

# MAINTENANCE INFORMATION

**MI25-09**

DATE :	June 2025	SECTION : 18 BODY
SUBJECT :	<b>WHEELCHAIR VERIFICATION AND ADJUSTEMENT</b>	<b>ENTRANCE DOOR</b>

First Release

06-18-2025

## APPLICATION

Model	VIN	
X3-45 Commuter Model Year : 2025 - today	From 2P9J3349XSC001731 up to today	

## DESCRIPTION

The purpose of this maintenance information is to check the operation of the wheelchair entrance door and make any necessary adjustments.

## MATERIAL

Other parts that may be required:

Part No.	Description	Qty
680739	GREASE SYNTHETIC / RED	AR

**NOTE**

*Material can be obtained through regular channels.*

## SAFETY PRECAUTIONS

- Eye protection should always be worn when working in a shop.
- Rules for Personal Protection Equipment should always be respected. Wear your PPE including but not limited to the following:



# Safety First!



## PROCEDURE



### DANGER

Park vehicle safely, apply parking brake, stop engine. Prior to working on the vehicle, set the ignition switch to the OFF position and trip the main circuit breakers equipped with a trip button. On Commuter type vehicles, set the battery master switch (master cut-out) to the OFF position.

Lock out & Tag out (LOTO) must be performed during set-up, maintenance or repair activities. Refer to your local procedure for detailed information regarding the control of hazardous energy.

## DOOR LATCHING VERIFICATION

1. Locate the wheelchair entrance.

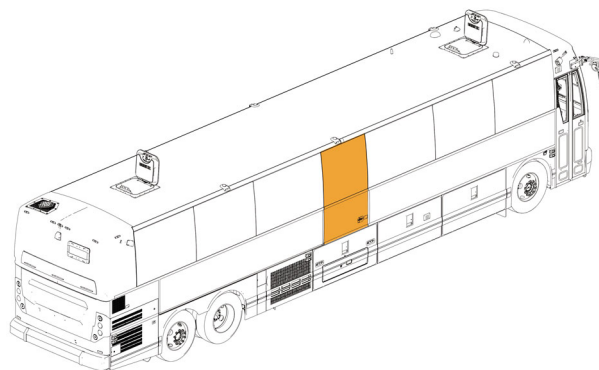

2. Locate the door handle

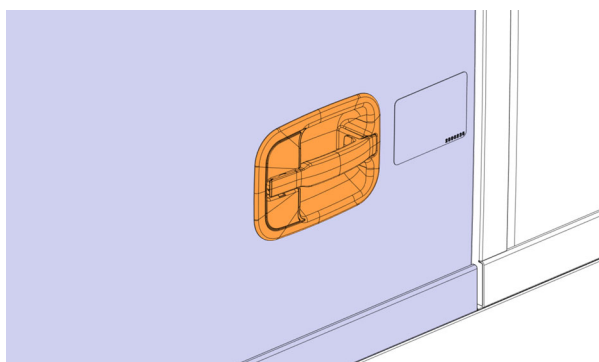

3. Pull the handle to open the door.
4. Verify the handle operation:
  - If not, go to door adjustment section.
  - If yes, go to next step.

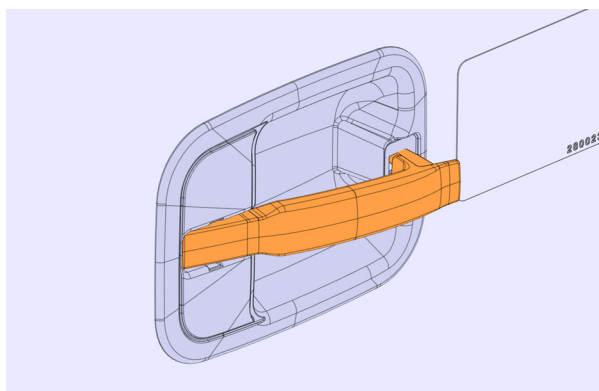

5. Open the door full.
6. Once the door is fully open, check that it remains locked in the open position:
  - If not, go to door adjustment section.
  - If yes, go to next step.

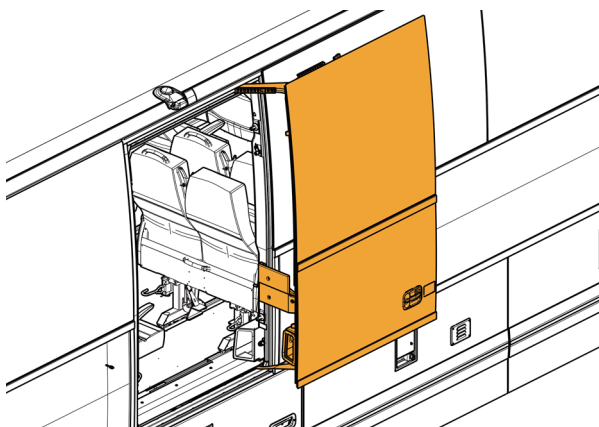
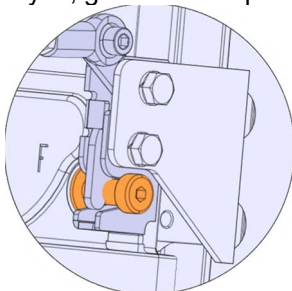

7. Pull the handle to release the door open position.
8. Verify the handle unlatch the door:
  - If not, go to door adjustment section.
  - If yes, go to next step.

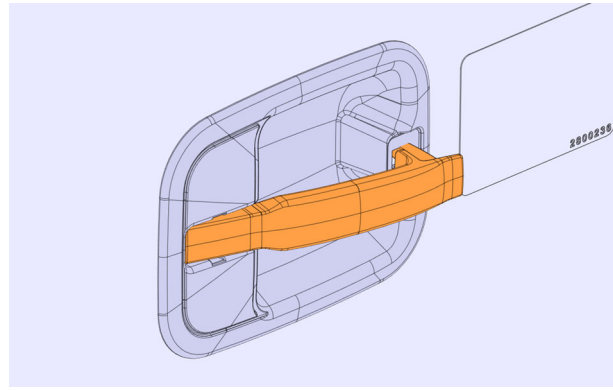
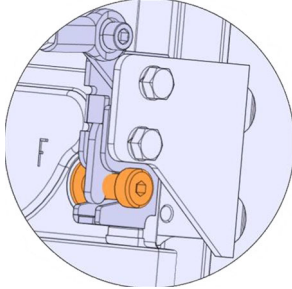

9. Close the door.

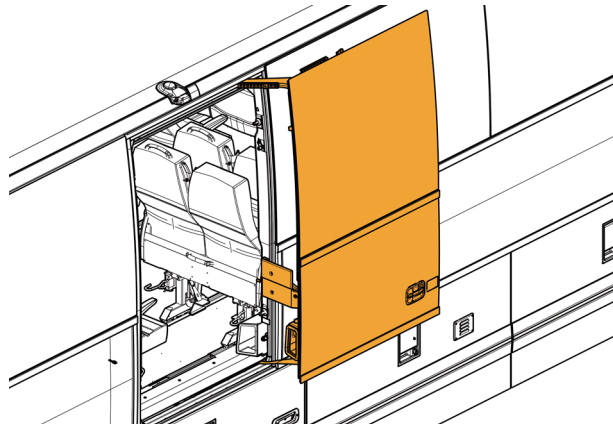

10. Verify the soft close work.
  - If not, go to door adjustment section.
  - If yes, go to next step.

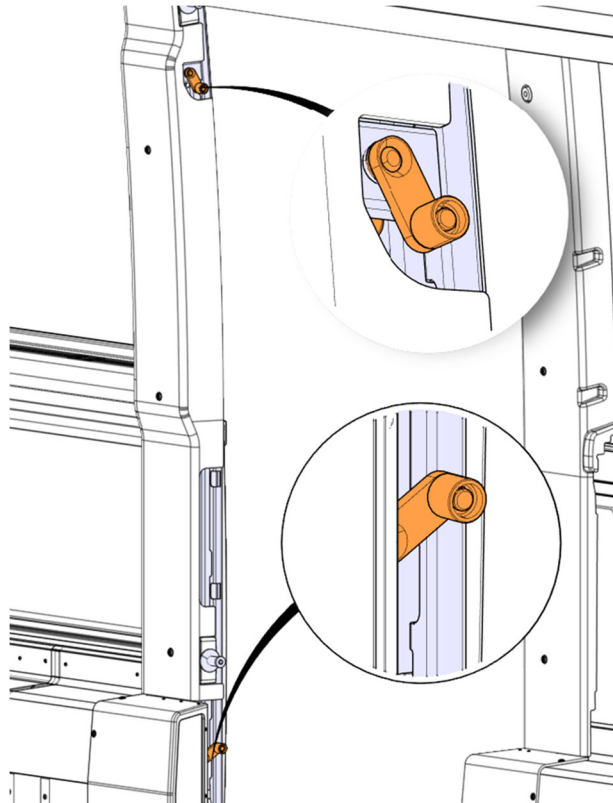

11. Verify the upper and lower latches catch the striker pins.

- If not, go to door adjustment section.
- If yes, the verification is finish.

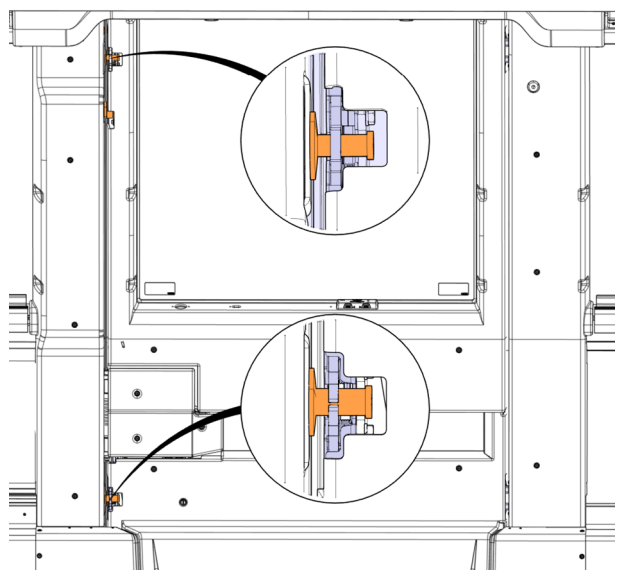

## DOOR ADJUSTMENT

1. Remove the screws (6x) and the washers (6x) of the upper door finishing

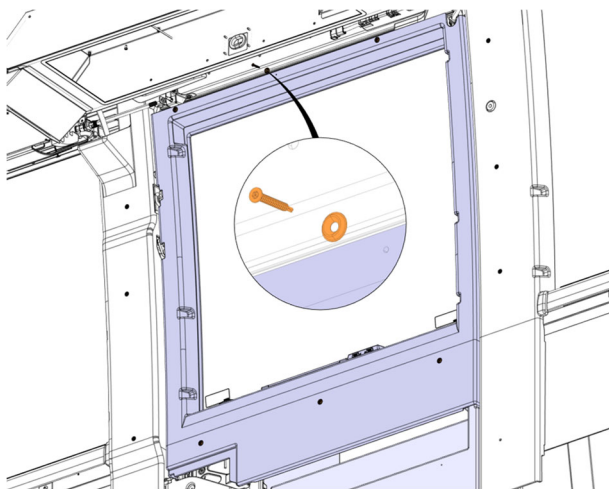

2. Open the door to be able to reach the lower hardware of the sliding door duct.
3. Remove the screws (3x) and the washers (3x) of the sliding door duct.

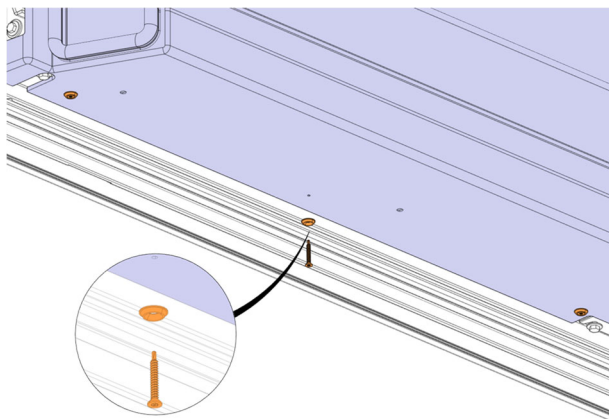

4. Close the door to be able to reach the upper hardware of the sliding door duct.
5. Remove the screws (3x) and the washers (3x) of the sliding door duct.

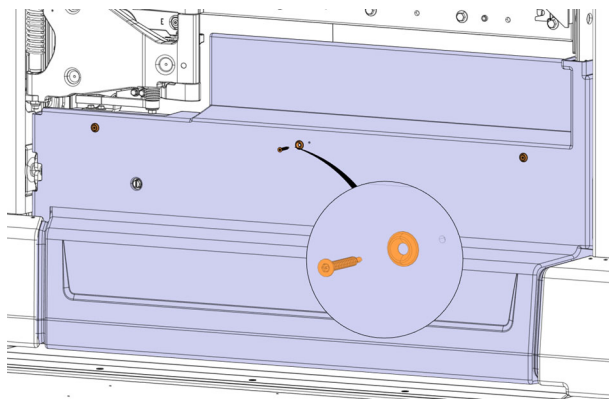

6. Adjust the middle adjusting rod so that the door "unlatches" from the fully open position from the outside handle.
7. Secure the rod length with the nut.

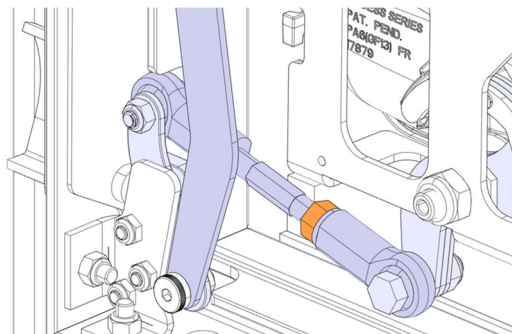

8. Test the bottom latch must open when the handle is at the 1/3 position.

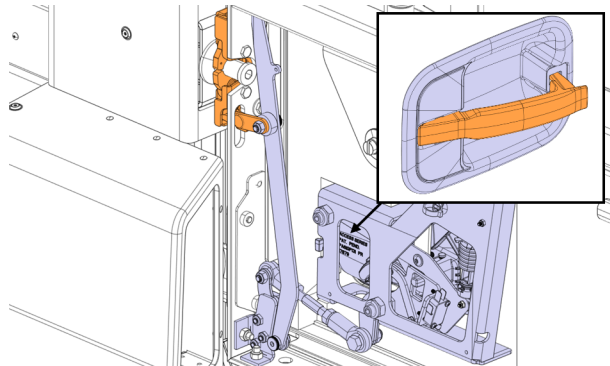

9. Adjust the vertical adjusting rod to synchronize the opening of both latches.
10. Secure the rod length with the nuts.
11. Apply torque seal 685353.

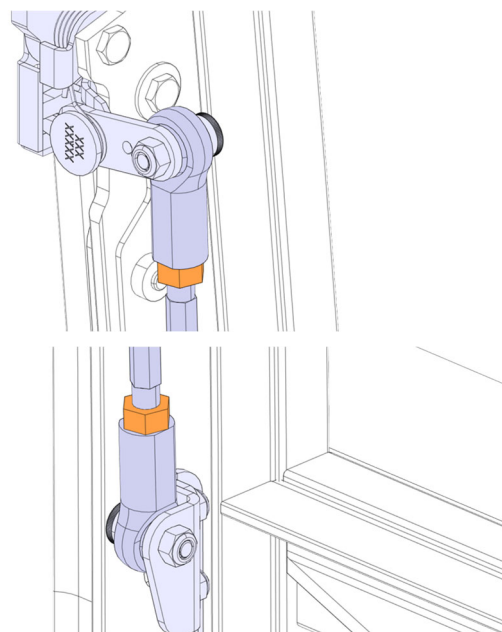

12. Test the lower and upper latch operate correctly.
  - If not, go to next step.
  - If yes, go to step 19

**Note:** If the upper latch open before the bottom latch that mean the vertical rod is too short.

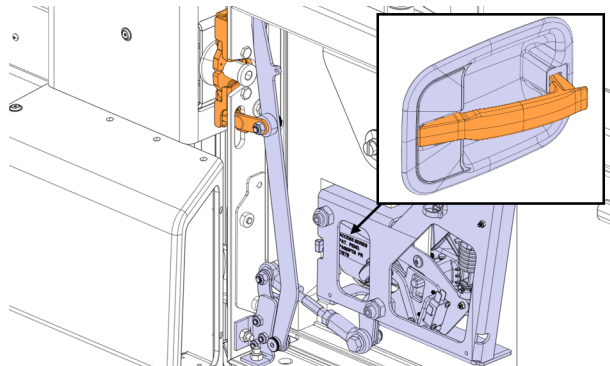



13. Adjust the lower striker pin to the center of the lower latch.
14. Torque to **60 lb-ft**.
15. Apply torque seal 685353

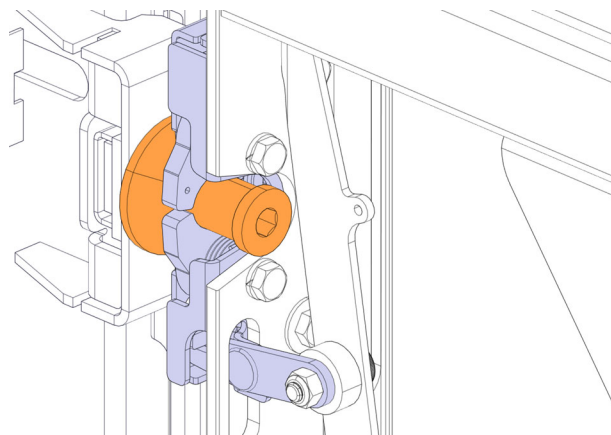

16. Adjust the upper striker pin to the center of the upper latch.
17. Torque to **60 lb-ft**.
18. Apply torque seal 685353

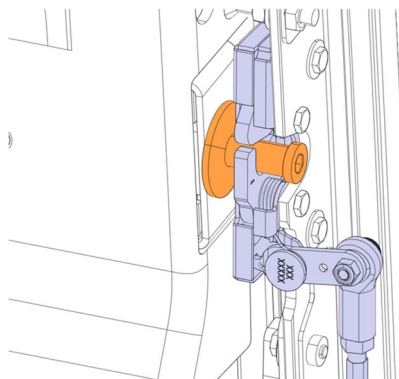

19. Adjust the horizontal adjusting rod to release the door latch which holds the door open.
20. Secure the rod length with the nuts.
21. Apply torque seal 685353.

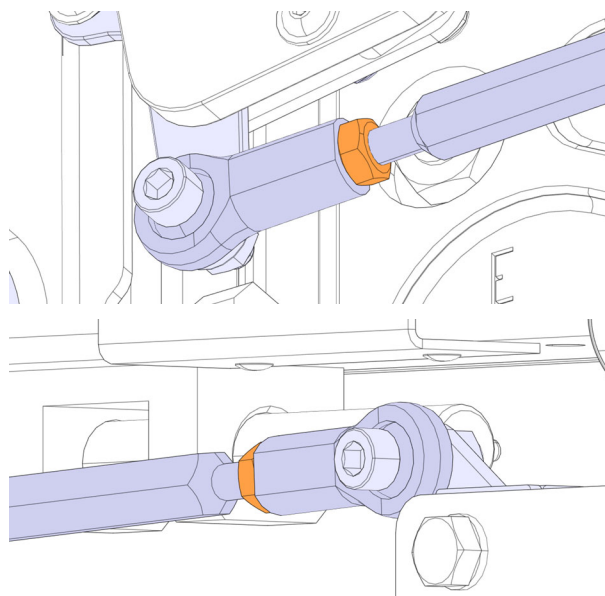



22. Test door latch which holds the door open.

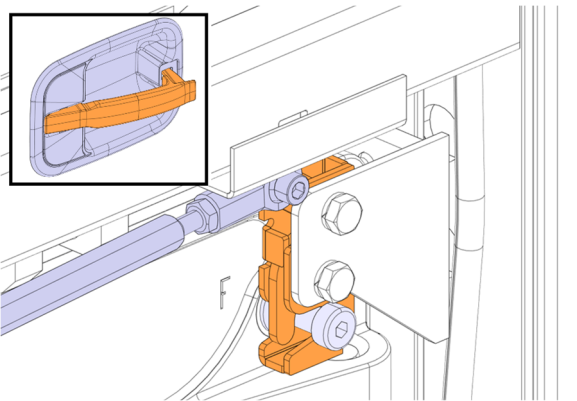

23. Verify that the handle operates correctly.

- If not, go to next step.
- If yes, the go to step ??.

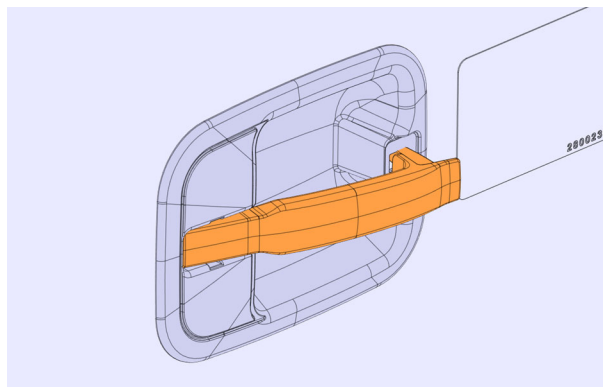

24. Remove the screws (2x), the lock washers (2x) and the handle panel.

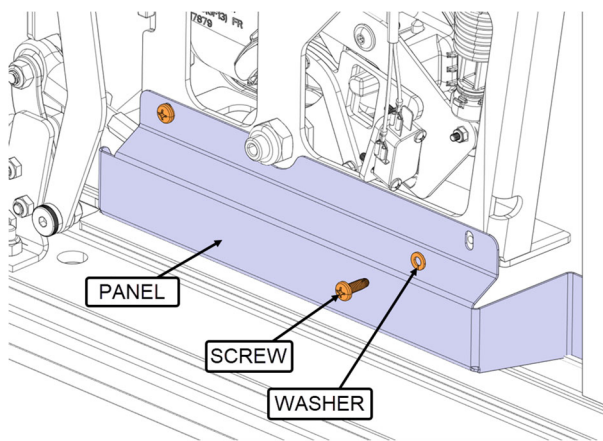

25. Disconnect the lock actuator.

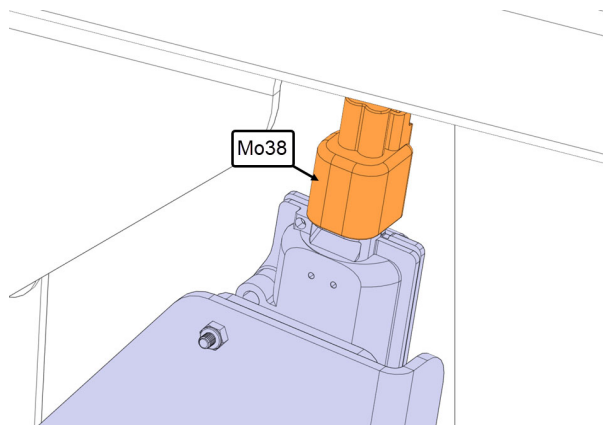

26. Disconnect the micro switch.

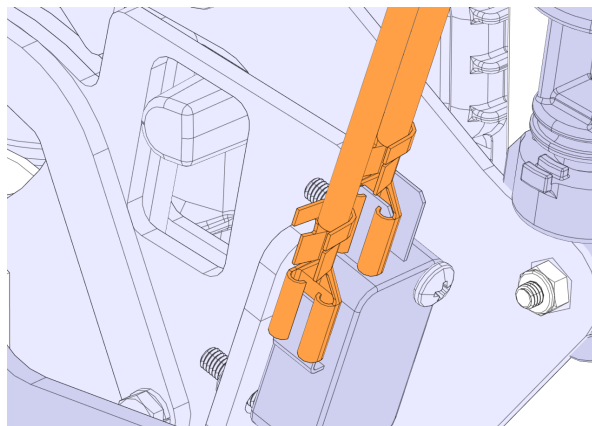

27. Remove the nuts that secure the support.

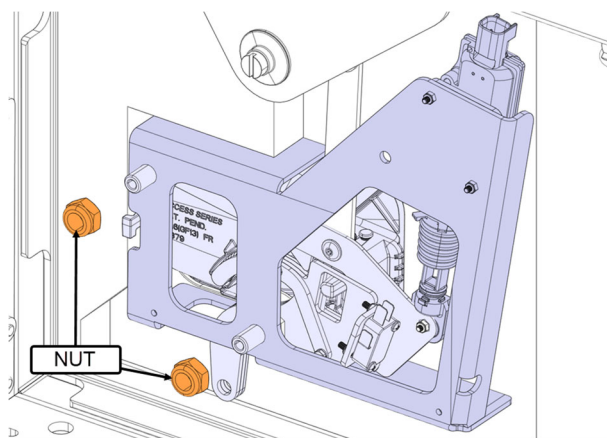

28. Remove the screws (2x), the washers (2x) the spacer and the nut (2x) that fasten the actuator.

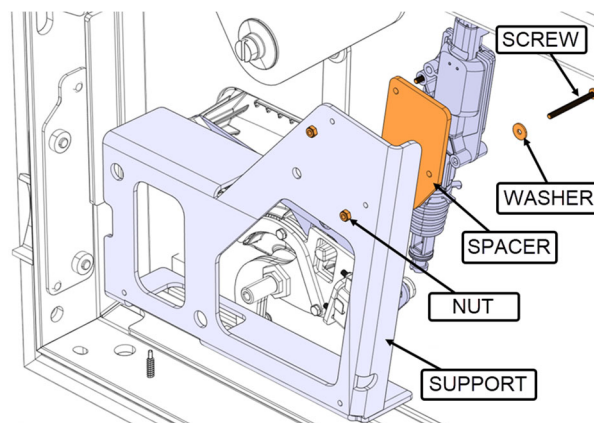

29. Remove the extension and the shoulder spacer and that fasten the lever to the handle

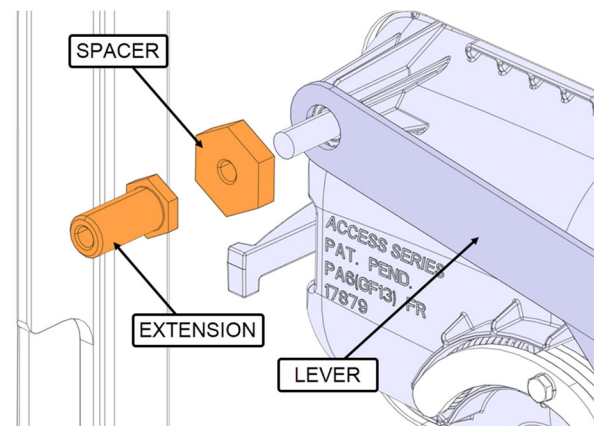

30. Remove the screw (1x) and the nut (1x) that fasten the lever assembly to the lock transfer.

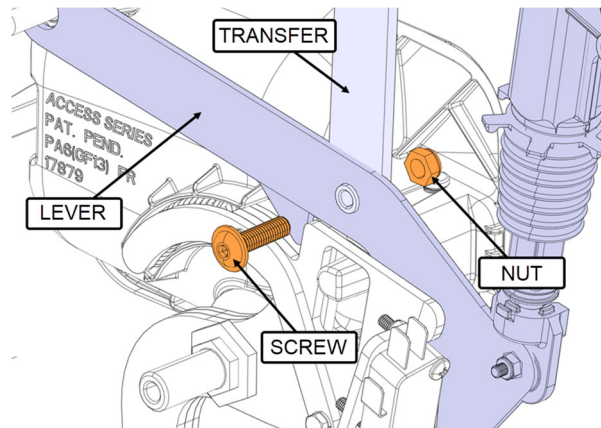

31. Remove the lever assembly.

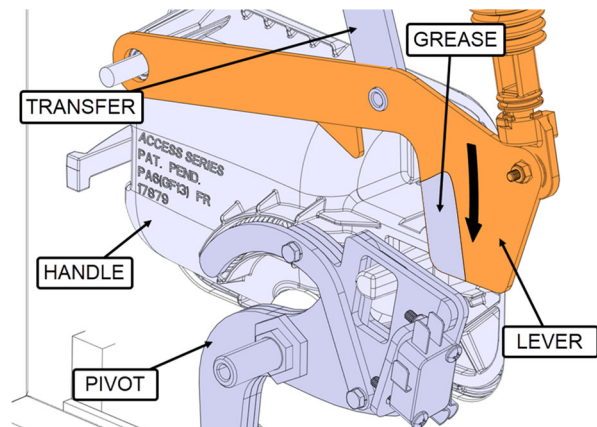

32. Remove the door handle.

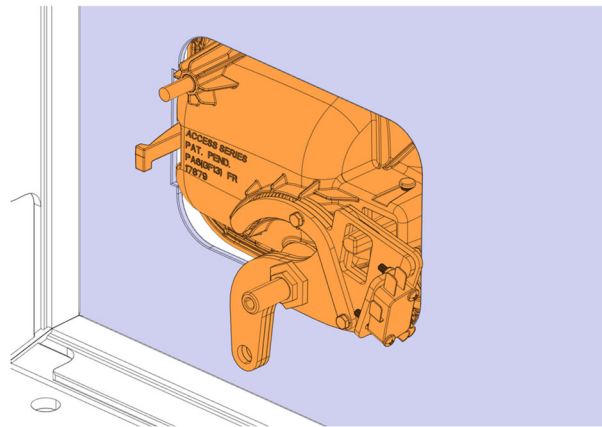

33. Remove the stud extensions and the shoulder spacers.
34. Remove the pivot assembly and the washer.

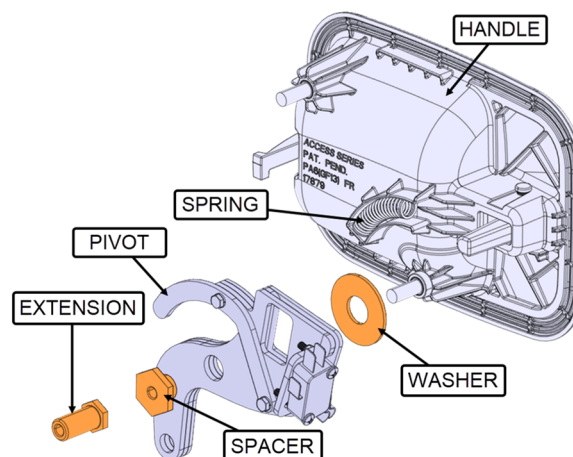

35. Apply grease 680379 to the pivoting parts and spring of the handle and washer.
36. Install the pivot assembly and the washer (1x) on the handle.

**Note: Be sure the spring is in right position.**

37. Secure the pivot assembly with the shoulder spacers (1x)
38. Apply a torque to **36 lb-in.**
39. Install the stud extensions (1x).

**Note: the stud extension is use as a jam nut.**

40. Apply a torque to **84 lb-in.**

**Note: You need to use wrench on the shoulder spacers to avoid turning.**

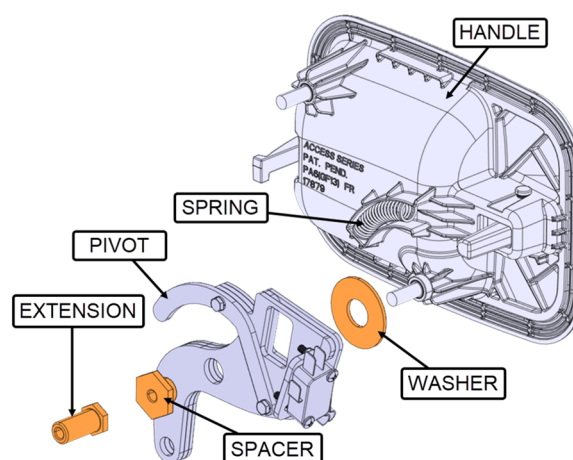

41. Reinstall the door handle.

**Note: Secure the handle with two pieces of adhesive tape.**

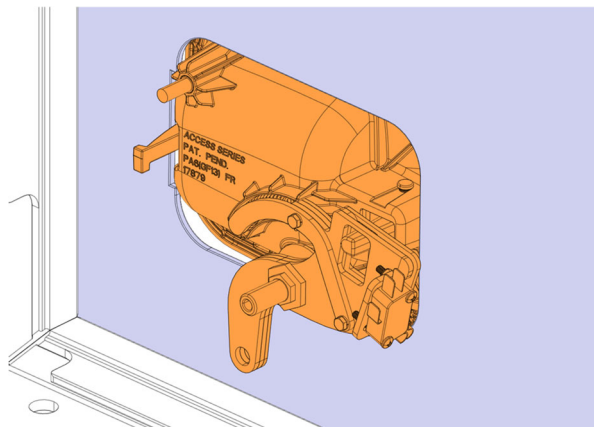

42. Apply grease 680379 on both side of the section sliding into the pivot.
43. Install the lever assembly on the handle and in the slot of the pivot assembly.

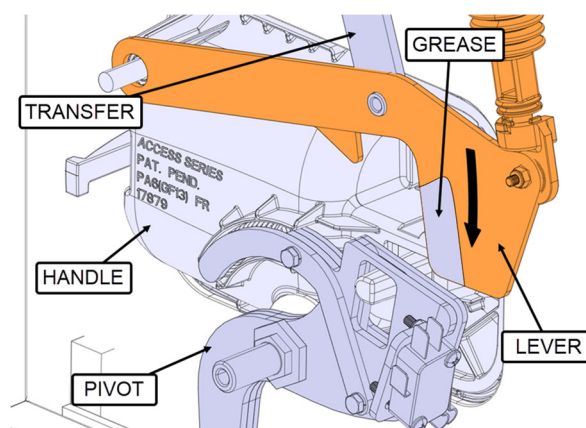

44. Fasten the lever assembly to the lock transfer with the screw (1x) and the nut (1x).
45. Apply a torque to **48 lb-in**.
46. Apply torque seal 685353.

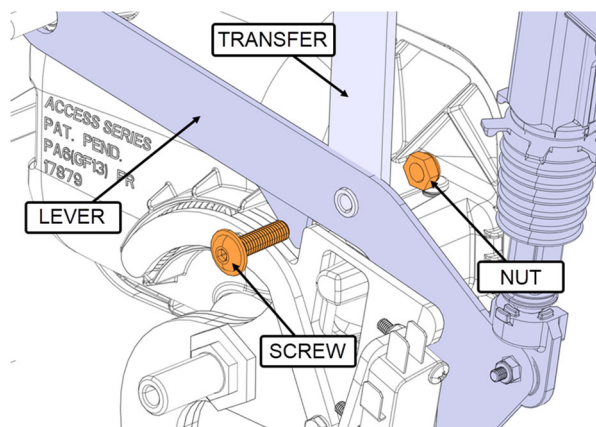

47. Secure the lever assembly on the handle with the shoulder spacers.
48. Apply a torque to **36 lb-in**
49. Install the stud extension.
- Note: the stud extension is use as a jam nut.**
50. Apply a torque to **84 lb-in**.
- Note: You need to use wrench on the shoulder spacers to avoid turning.**

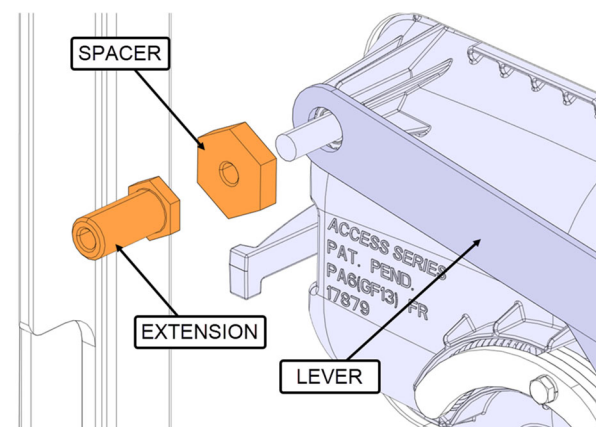

51. Fasten the actuator assembly with the spacer on the support with the screws (2x), the washers (2x) and the nut (2x).
52. Apply a torque to **16 lb-in**.

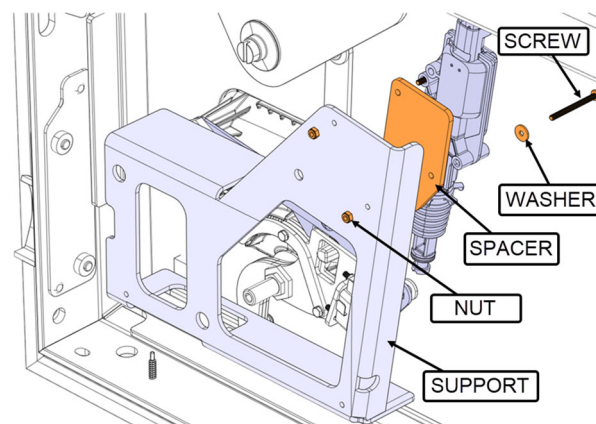



53. Secure the support with the nuts (2x).

54. Apply a torque to **36 lb-in.**

**Note: Applies the tightening torque when the nut is pressed onto the support.**

55. Apply torque seal 685353

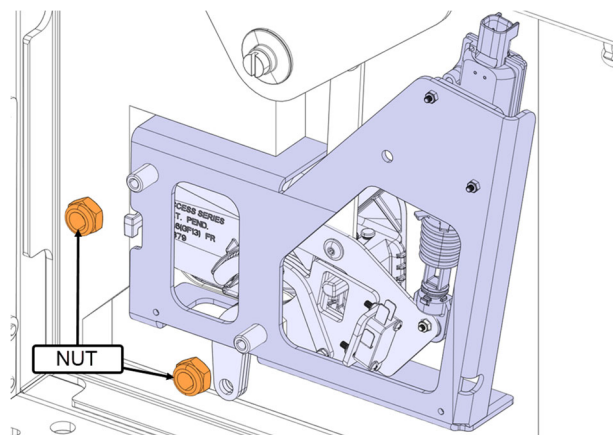

56. Reconnect the lock actuator.

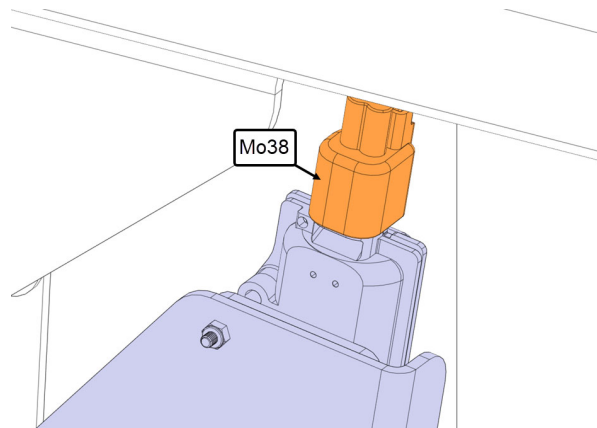

57. Reconnect the micro switch.

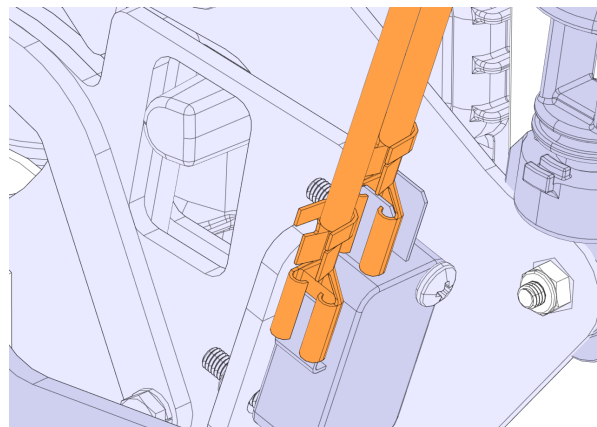

58. Reinstall the handle panel with the screws (2x), the lock washers (2x).

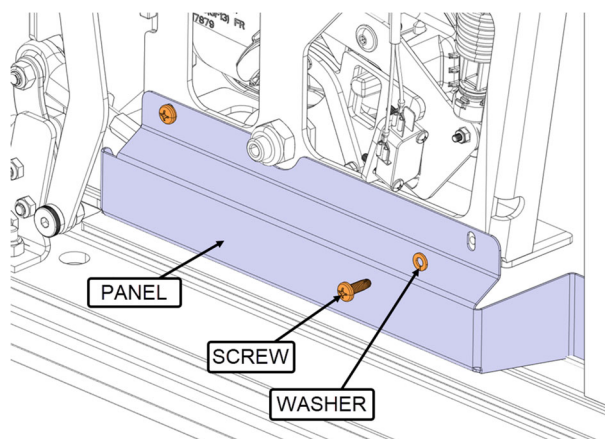

59. Reinstall the sliding door duct with the screws (3x) and the washers (3x).

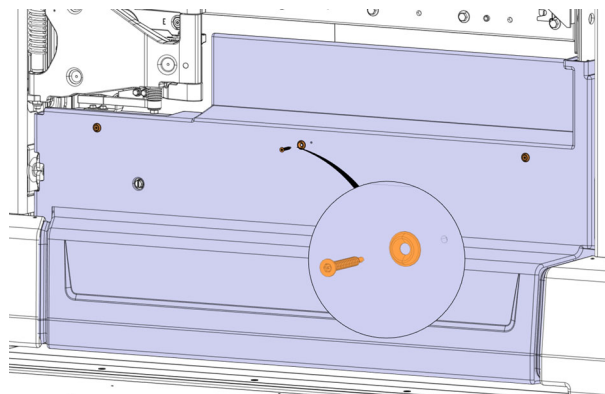

60. Open the door to be able to reach the lower of the sliding door duct.

61. Secure the bottom of the sliding door duct with the screws (3x) and the washers (3x).

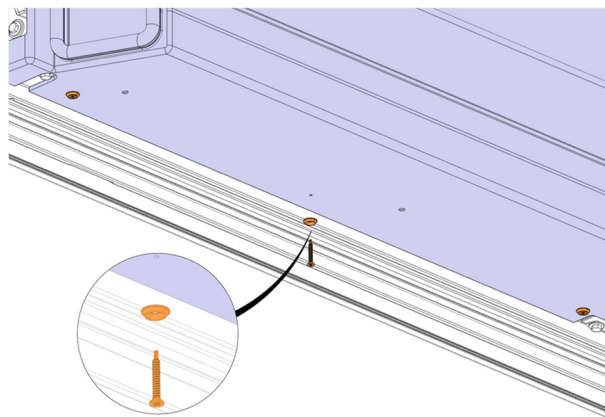

62. Reinstall of the upper door finishing with the screws (6x) and the washers (6x).

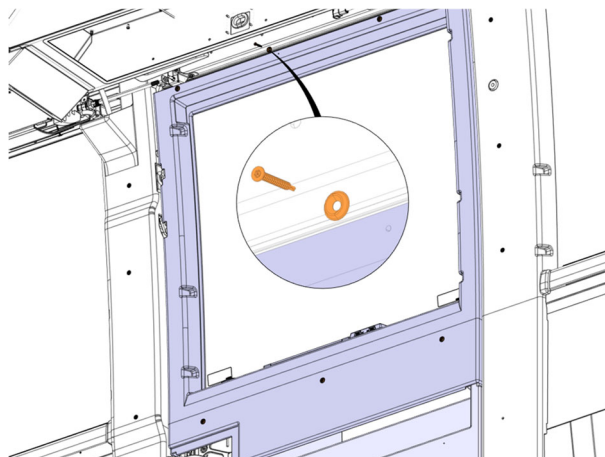



## PARTS / WASTE DISPOSAL

Discard according to applicable environmental regulations (Municipal/State[Prov.]/ Federal)

Access all our Service Bulletins on <http://techpub.prevostcar.com/en/>  
Or scan the QR-Code with your smart phone

**Are you a Vehicle owner?**  
E-mail us at [technicalpublications\\_prev@volvo.com](mailto:technicalpublications_prev@volvo.com) and type "ADD" in the subject to  
receive warranty bulletins applicable to your vehicle(s) by e-mail.

