

FUEL TANK BALL CHECK VALVE INSTALLATION GUIDE

Revision B :

Modification of components in kits, gasket part number corrected

PROCEDURE FOR H3 SERIES VEHICLES

MATERIAL

Kit #032453 includes the following parts :

Part No.	Description	Qty
032437	Elbow	2
032438	Basket	2
032439	Ball Ø2 ¾"	2
504293	Hose clamp	2
032436	Flange	2
031804	Check valve gasket	2
502511	Nut	10
500411	Washer	10
504701	Breather + gasket + O ring	1
501205	Fitting Ø1"	1
032415	Hose Ø1"	1
032014	Connection panel gasket	1
032396	Adapter	2
IS-98080	Instruction Sheet	1
FI-98080	Feuille d'instructions	1

Warning : Park vehicle safely, apply parking brake, stop engine and set battery master switch(es) to the OFF position prior to working on the vehicle.

Note : If you go to a Prévost service center for the installation, ensure that the fuel level in the tank is as low as possible.

1. Close the manual shut-off valve located under the air compressor at the inlet side of the primary fuel filter (figure 1) or if so equipped, close the manual shut-off valve on the optional Fuel Pro 382 diesel filter located in the engine R.H. side compartment.
2. Raise the vehicle at the jacking points (see maintenance manual section 18).
3. If necessary, drain fuel tank to a level permitting easy installation by unscrewing the drain plug accessible from under the tank.

4. Open the condenser door and remove the fuel tank access panel. The rear baggage compartment fuel tank access panel must also be removed to access R.H. side filler tube.
5. Unscrew hose clamps retaining L.H. and R.H. side filler tubes to fuel tank and filler neck, then remove both tubes (item ① figure 2).
6. For both filler tubes, remove the clamp retaining the existing check valve inside the tube and remove check valve (item ② figure 2).
7. Unscrew all fuel supply and return lines from fuel tank connection panel. Identify them for reinstallation.

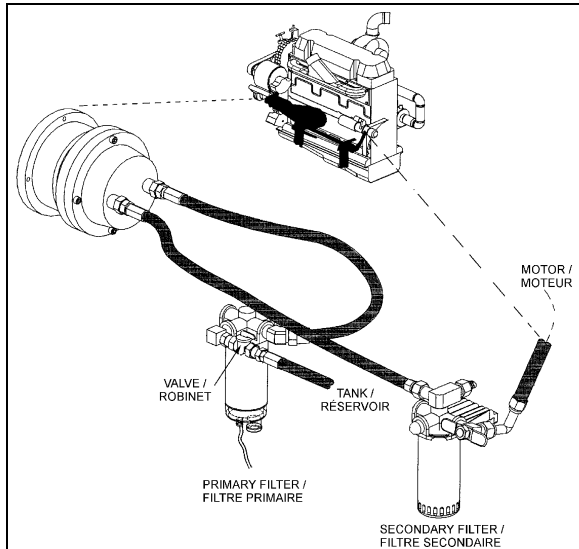

FIGURE 1 : PRIMARY FUEL FILTER SHUT-OFF VALVE

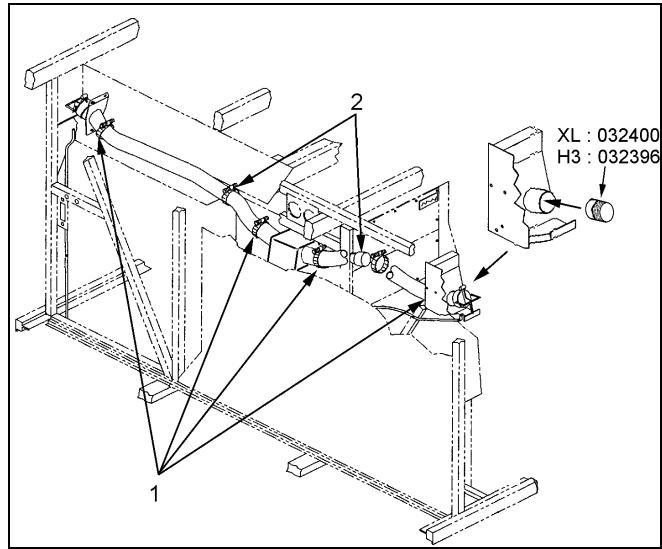

FIGURE 2 : L.H. & R.H. SIDE FILLER TUBES

8. Disconnect electrical wiring from fuel level transmitter. Identify each wire for reinstallation.
9. Remove connection panel (item ③ figure 3).
10. Install ball check valve flange #032436 on the tank hose connection (item ④ figure 3). Mark on and drill two holes using a #8 drill.

Note : In order to have the ball check valve in the wright position, place flange as per figure 4.

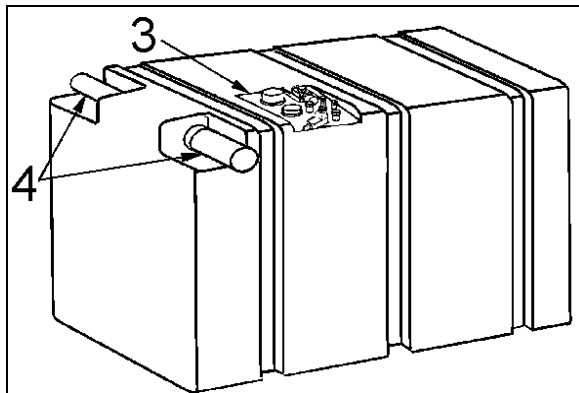

FIGURE 3 : ③ CONNECTION PANEL
④ R.H. & L.H. SIDE HOSE CONNECTIONS

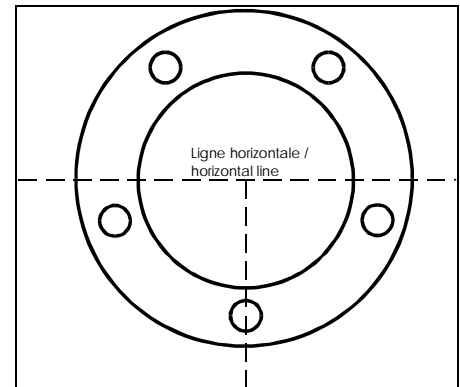

FIGURE 4 : BALL CHECK VALVE FLANGE
#032436

11. Using the two holes, fix the flange and complete drilling.
12. Assemble the ball check valve as per figure 5.

13. Remove flange and install the ball check valve inside the tank.

Note : It is advisable to tie up a rope to the ball check valve.

14. Using the flange #032436, fix the ball check valve (figure 6).

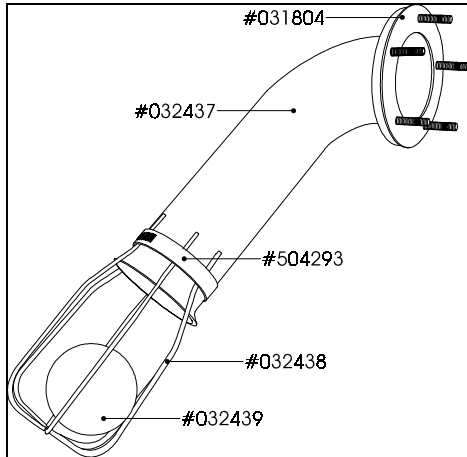

FIGURE 5 : BALL CHECK VALVE ASSEMBLY

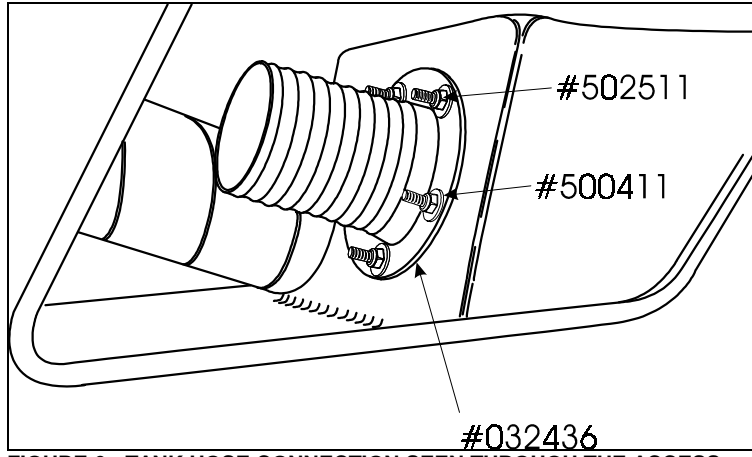

FIGURE 6 : TANK HOSE CONNECTION SEEN THROUGH THE ACCESS PANEL IN BAGGAGE COMPARTMENT

15. Repeat step 10 to 14 for the second filler tube.

16. Install the new breather on the connection panel (figure 7).

17. Reinstall connection panel using new gasket #031849.

18. Reconnect electrical wiring of fuel level transmitter.

19. Reinstall all fuel supply and return lines on tank connection panel. Use Loctite 567 on threads.

20. Using a heat gun, heat and remove the actual adapters (glued) in the filler neck (figure 2). Replace by adapter #032396, use Loctite 330 (kit #680446).

21. Reinstall both R.H. and L.H. side filler tubes, tighten hose clamps.

22. Reinstall fuel tank access panels.

Caution : Check nuts, screws and fittings for tightness.

23. The installation is now completed.

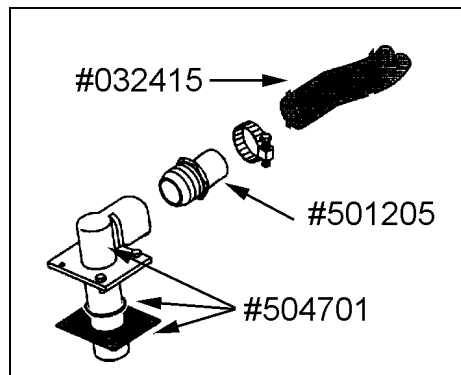

FIGURE 7 : BREATHER

PROCEDURE FOR XL & XLII SERIES VEHICLES

MATERIAL

Kit #032413 includes the following parts :

Piece No	Description	Qty
032437	Elbow	2
032438	Basket	2
032439	Ball Ø 2 ¾"	2
504293	Hose clamp	2
031804	Check valve gasket	2
502511	Nut	10
500411	Washer	10
504701	Breather + gasket + O ring	1
501205	Fitting Ø1"	1
032415	Hose Ø1"	1
031849	Connection panel gasket	1
032400	Adapter	2
IS-98080	Instruction Sheet	1
FI-98080	Feuille d'instructions	1

Warning : Park vehicle safely, apply parking brake, stop engine and set battery master switch(es) to the OFF position prior to working on the vehicle.

Note : If you go to a Prévost service center for the installation, ensure that the fuel level in the tank is as low as possible.

1. Close the manual shut-off valve located under the air compressor at the inlet side of the primary fuel filter (figure 1) or if so equipped, close the manual shut-off valve on the optional Fuel Pro 382 diesel filter located in the engine R.H. side compartment.
2. Raise the vehicle at the jacking points (see maintenance manual section 18).
3. If necessary, drain fuel tank to a level permitting easy installation by unscrewing the drain plug accessible from under the tank.
4. Open condenser door and remove fuel tank access panel. Remove the steel panel between the fuel tank and the rear baggage compartment to access filler tubes.
5. Unscrew hose clamps retaining L.H. and R.H. side filler tubes to fuel tank and filler neck, then remove both tubes (item ① figure 2).
6. Remove fuel return line from R.H. side filler tube fitting (item ⑤ figure 8) and remove the filler tube fittings from the tank.
7. Remove existing check valve inside filler tube fittings (⑥ figure 8).
8. Unscrew all fuel supply and return lines from fuel tank connection panel. Identify them for reinstallation.
9. Disconnect electrical wiring from fuel level transmitter assembly. Identify each wire for reinstallation.
10. Remove connection panel (item ⑧ figure 8).

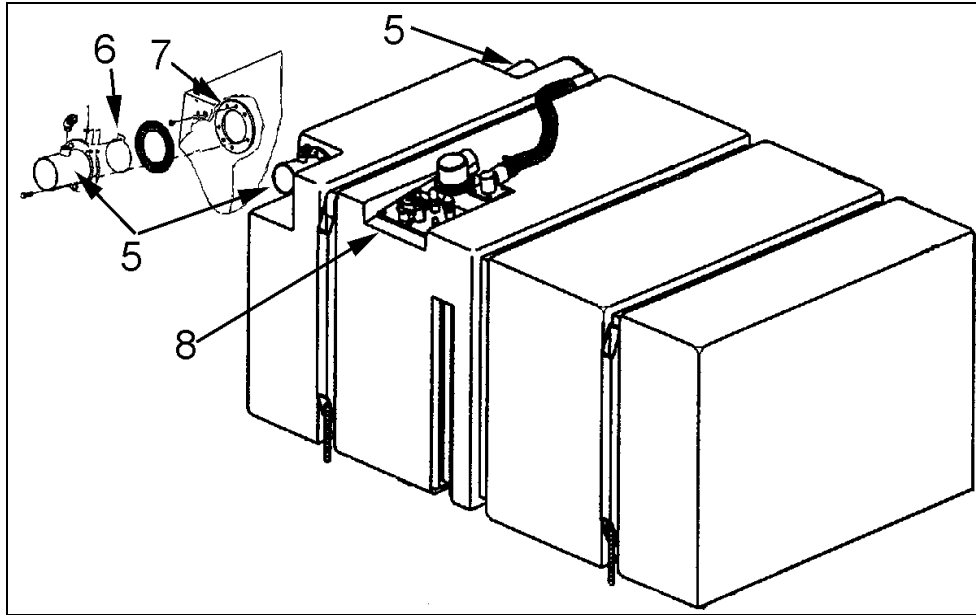

FIGURE 8 : ⑤ FILLER TUBE FITTINGS, ⑥ EXISTING CHECK VALVE, ⑦ INTERNAL FLANGE,
⑧ CONNECTION PANEL

11. Secure the internal flanges (item ⑦ figure 8) with a nylon tie then unscrew their fixing bolts. Remove the flanges from the tank using the opening of the connection panel.
12. Assemble the ball check valves as per figure 5.
13. If necessary, lightly enlarge the connection panel opening to permit passage of the ball check valves.
14. Pass a rope from the connection panel through the filler tube fitting opening.
15. Tie the rope to one of the ball check valve studs and introduce the ball check valve into tank.
16. Bring the ball check valve to its position by pulling on the rope.
17. Fix the ball check valve in place by attaching it to the filler tube fitting (item ⑤ figure 8).
18. Connect fuel return line R.H. side filler tube fitting.
19. Repeat steps 14 to 17 for the second filler tube.
20. Install the new breather on the connection panel (figure 7).
21. Reinstall connection panel using new gasket #032014.
22. Reconnect electrical wiring of fuel level transmitter.
23. Reinstall all fuel supply and return lines on tank connection panel. Use Loctite 567 on threads.
24. Using a heat gun, heat and remove the actual adapters glued in the filler neck (figure 2). Replace by adapter #032400, use Loctite 330 (kit #680446).
24. Reinstall both R.H. and L.H. side filler tubes, tighten hose clamps.
25. Reinstall fuel tank access panels.

Caution : Check nuts, screws and fittings for tightness.

26. The installation is now completed.