

# PREVOST

## Instruction Sheet

## IS-01052

### STEERING WHEEL REPLACEMENT

#### MATERIAL

Kit #163247 includes the following parts:

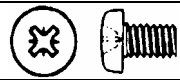
Part No.	Description	Identification	Qty
191696	Steering, 20 inch		1
660757	Ring, Turn Signal Cancel		1
500650	Screw, TC Bdg Phillips ZP 6-32X3/8		3
IS-01052	Instruction Sheet		1
FI-01052	Feuille d'instructions		1

#### PROCEDURE

#### ⚠ WARNING ⚠

Park vehicle safely, apply parking brake, stop engine and set battery master switch(es) to the OFF position prior to working on the vehicle.

1. Mark steering wheel position in comparison with steering column to ensure that new steering wheel will be installed in the same position.

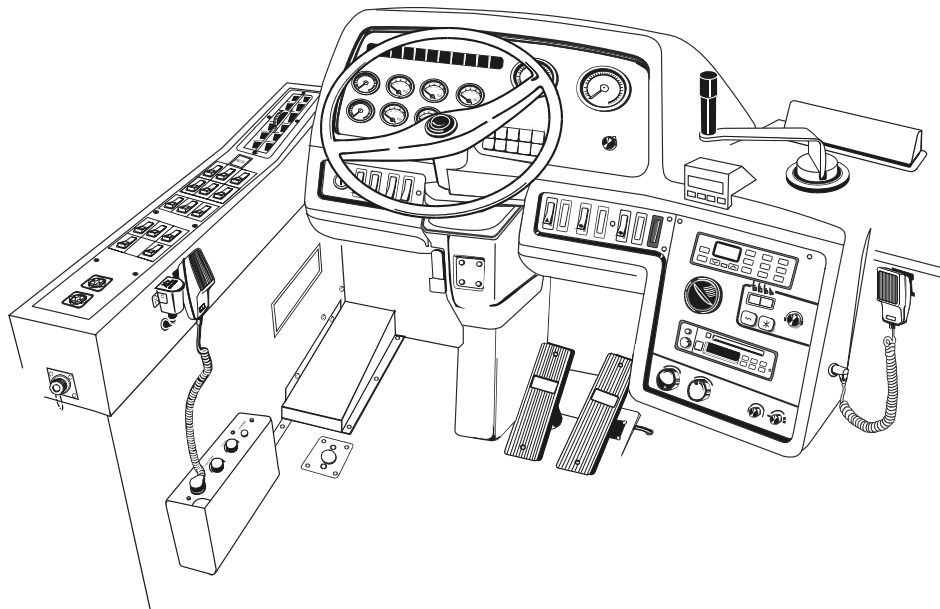

2. Push the lever down to unlock the steering column tilt and telescopic mechanism. Pull the steering wheel to maximum position then lock the mechanism.

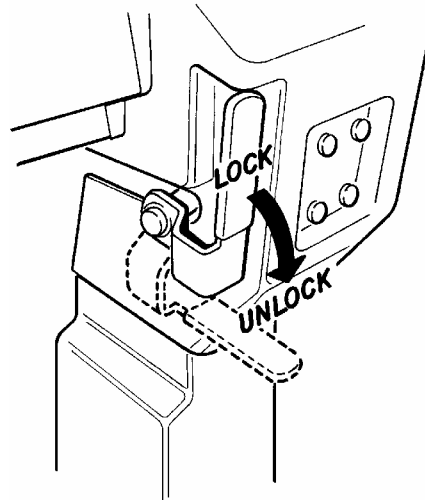

3. Lower the protective rubber bellows to access the horn electrical contact.

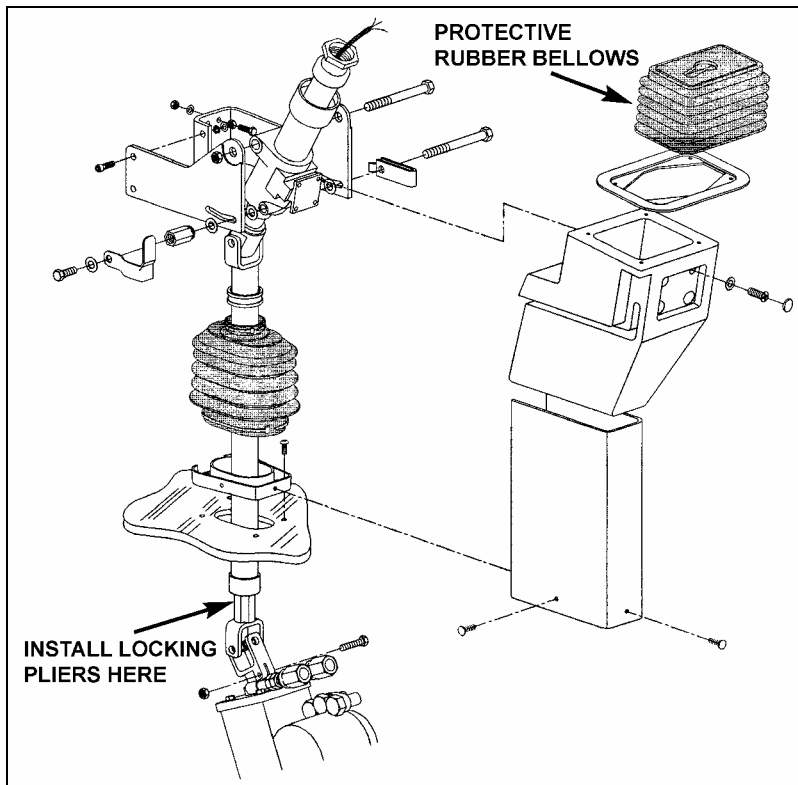

4. Insert a small plastic bushing to move the terminal away from the contact.
5. Unlock the steering column tilt and telescopic mechanism, push the steering wheel down to maximum then lock the mechanism again.
6. From the front electrical and service compartment, block the steering shaft with regard to the steering column using a pair of locking pliers.
7. Before removing the steering wheel, insert the wire into the steering column.
8. Use a 1¼ inch 12-point deep socket to remove the steering wheel fixing nut.

9. Remove the steering wheel.

**NOTE**

*A puller may be necessary in order to remove the steering wheel.*

10. On a workbench, turn the steering wheel over in order to remove the turn signal cancel ring.

11. Install the turn signal cancel ring on the new steering wheel center piece.

**NOTE**

*Make sure turn signal cancel ring is installed to the right when the steering wheel is turned over.*

**⚠ CAUTION ⚠**

**You may have to drill new holes into the steering wheel center piece in order to fix the cancel ring in the proper position. Use thread cutting screws (500650).**

12. Install new steering wheel onto steering column in the same position as former steering wheel.

**NOTE**

*The inside of the steering wheel center piece may have to be ground prior to installation.*

13. Tighten the steering wheel fixing nut to a torque of 35-40 lbf-ft (47-60 Nm).

14. Reinstall the button in the center of the steering wheel, remove the horn plastic bushing, replace the protective rubber bellows then remove the locking pliers.

