

PREVOST

**MAINTENANCE
INFORMATION**

mi97-29



DATE: Nov.97	SECTION: 02
SUBJECT: New clutch spring	

APPLICATION:

Model	VIN
H3 coaches equipped with series 60 engine and manual transmission Model Year: 1995 - 1997	From 2P9H33490S1001134 up to 2PCH33497V1012078 incl.
XL coaches equipped with series 60 engine and manual transmission Model Year: 1994- 1997	From 2P9L33402R1001836 up to 2P9L33409S1001550 incl.

DESCRIPTION

On the above-mentioned vehicles equipped with a manual transmission, a kit including a new spring is available. The new spring is stiffer and avoid slippery clutch when the engine reaches its maximum torque.

MATERIAL (6 speed transmission)

Part No.	Description	Qty
020448	Bracket	1
020439	Spring	1
020441	Lever	1

Note: Material can be obtained through regular channels.

MATERIAL (7 speed transmission)

Part No.	Description	Qty
020442	Bracket	1
020439	Spring	1
020441	Lever	1

Note: Material can be obtained through regular channels.

PROCEDURE

Warning: Park vehicle safely, apply parking brake, stop engine and set battery master switch(es) to the OFF position prior to working on the vehicle.

1. Locate spring system on transmission near the clutch (see figure 1 or 2).
2. Remove existing spring, lever and bracket.
3. Install new spring and new lever.
4. Install new spring as per figure 1 or 2.

Note: The spring tension can be adjusted by positioning the spring arm into the appropriate slot. Select the position of the arm according to spring fatigue or when the clutch tends to be slippery.

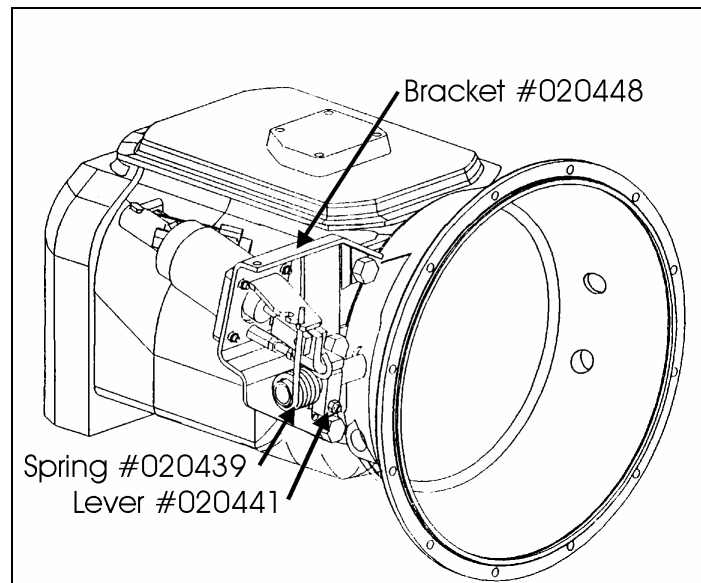

FIGURE 1: 6 SPEED TRANSMISSION

02008

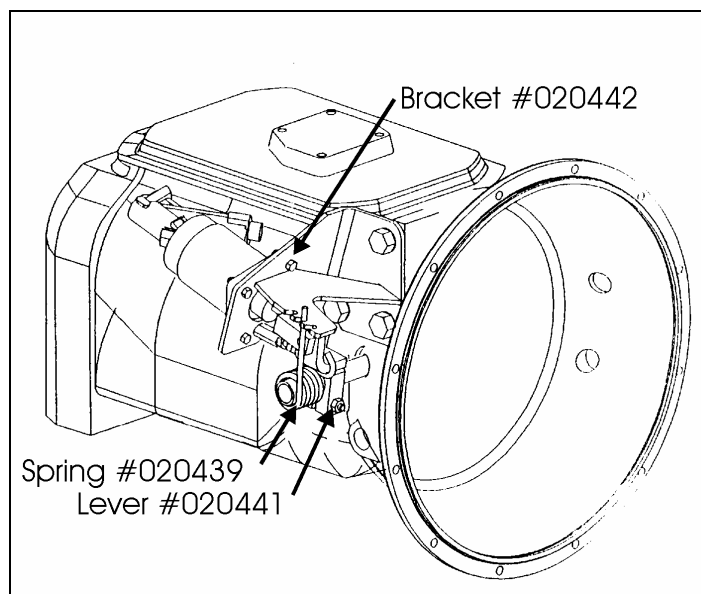

FIGURE 2: 7 SPEED TRANSMISSION

02009

5. Adjust the gap to 3mm slot and adjust the stop (item #27 of figure 4).

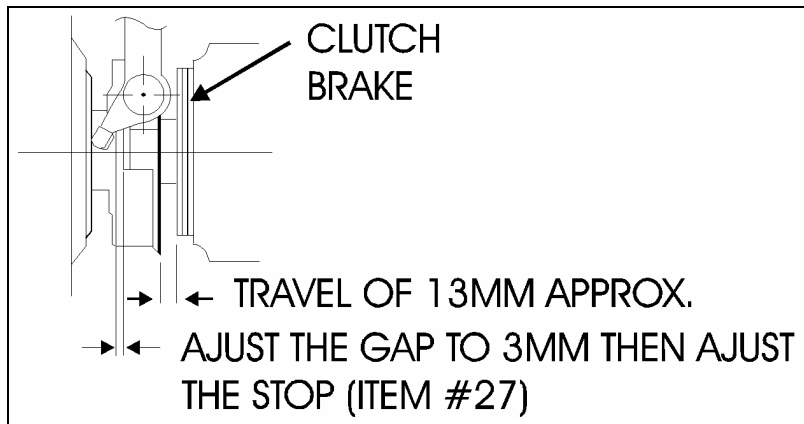

FIGURE 3

02010

6. Adjust bolt (item #27) so that it pushes against the lever (item #15) and lock in position using nut (item #38).

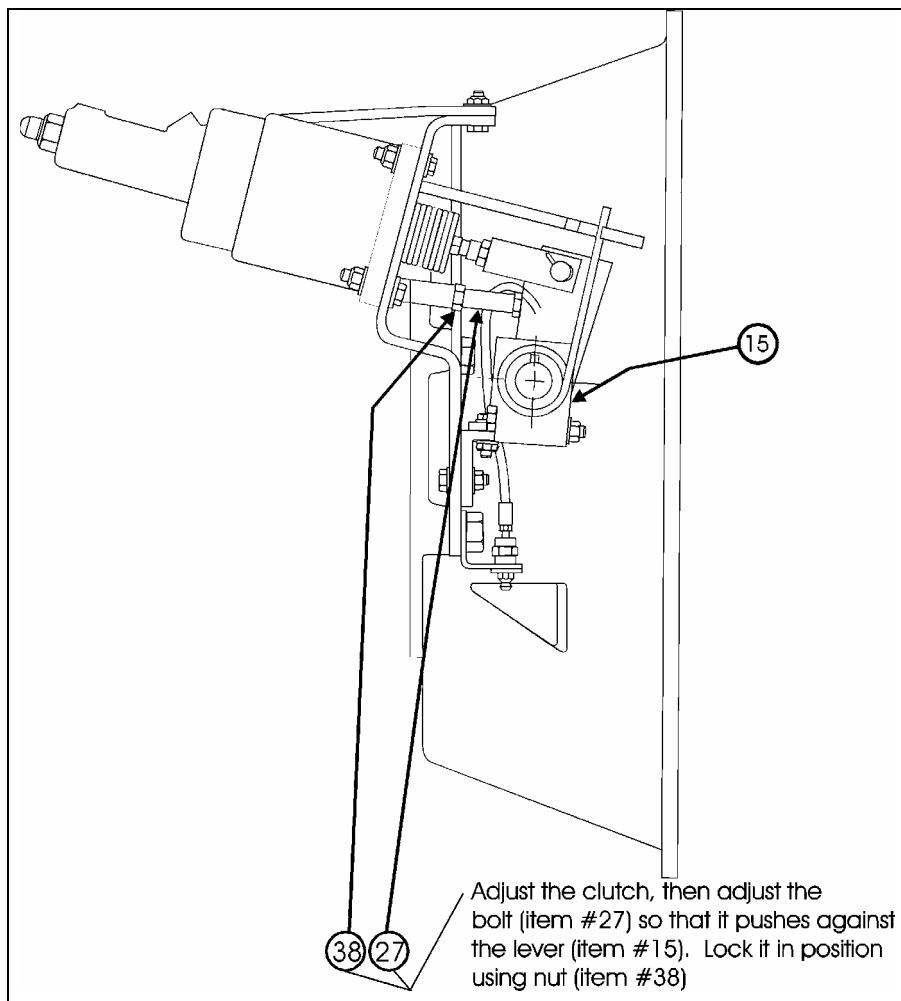

FIGURE 4

02011