

### FUEL TANK REINFORCED RETAINERS INSTALLATION FOR H3-40, H3-41, H3-45 COACHES AND VIP WITH CENTRAL A/C SYSTEM

Revision A :

TITLE MODIFIED TO SPECIFY APPLICABLE VEHICLE
--

#### MATERIAL

Kit #032446 includes the following parts :

Part No.	Description	Qty
032443	Rail	3
032444	Stile, short	2
032445	Stile, long	4
502102	Pin, cotter 1/8 x 1	6
502121	Pin, clevis 3/8 x 1 5/8 BZC	6
506758	Neoprene ribbon 1/16 x 1 1/2 x 50'	1
IS-00038A	Instruction Sheet	1
FI-00038A	Feuille d'instructions	1

#### PROCEDURE

**Warning :** Park vehicle safely, apply parking brake, stop engine and set battery master switch(es) to the OFF position prior to working on the vehicle.

1. Close the manual shut-off valve located under the air compressor at the inlet side of the primary fuel filter (or fuel filter/water separator, if so equipped) and the secondary fuel filter shut-off valve located in the engine R.H. side compartment (figure 1).

**Note :** If so equipped, close the manual shut-off valve on the optional Fuel Pro 382 diesel filter located in the engine R.H. side compartment (figure 2).

**Warning :** Before working under an air-suspended vehicle, it is strongly recommended to support the body at the recommended jacking points.

**Note :** Before removal, the fuel tank should be completely drained by unscrewing the drain plug accessible from under the vehicle. Ensure that the container has a capacity equal to the amount of fuel remaining in the tank.

2. Open the condenser door and remove the fuel tank access panel (item 7 figure 4). The rear baggage compartment fuel tank access panel (item 8 figure 4) may also be removed to facilitate access to the components.

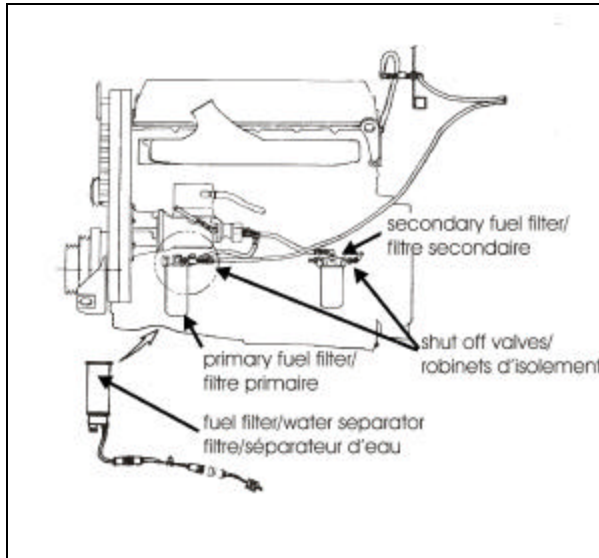

**FIGURE 1 : SHUT OFF VALVES AND FUEL FILTERS**

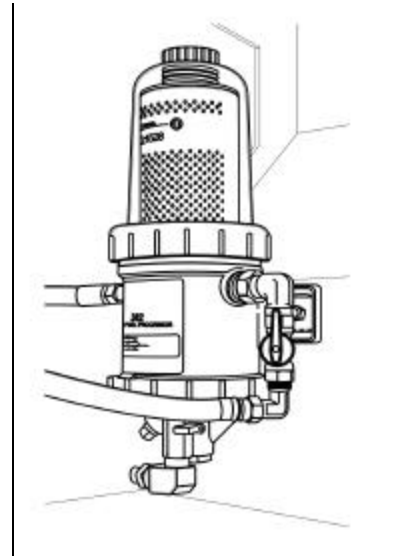

**FIGURE 2 : FUEL PRO 382**

3. Unscrew clamps retaining L.H. side and R.H. side filler tubes to the fuel tank, then disconnect both tubes (item 1 figure 3).
4. If applicable, unscrew preheater supply line, preheater return line and auxiliary return line from fuel tank connection-panel (item 2 figure 3). Identify them for reinstallation.
5. Unscrew engine supply and return lines from fuel tank connection-panel (item 2 figure 3).
6. Disconnect electrical wiring from fuel level sender assembly (item 3 figure 3).

**Warning :** Before removing the bolts securing the tank support to the frame, make sure the tank is supported adequately. Failure to do so could result in injury as well as damage to the tank.

7. With the tank adequately supported, from under the vehicle, on R.H. side, unscrew the 4 bolts (2 in front, 2 in back) retaining the tank support to the frame (item 4 figure 4).
8. From under the vehicle, on the L.H. side, unscrew the 2 bolts (1 in front, 1 in back) retaining the tank support to the frame (item 5 figure 4).
9. Carefully remove tank from under the vehicle by raising the vehicle.
10. Remove the existing retaining straps (item 9 figure 3).
11. Assemble the new fuel tank retainers using the rails, stiles, pin clevis and cotter pins of kit #032446.
12. On the retainer side in contact with the tank, apply neoprene ribbon (Prévost #506758).
13. Install the new retainers on the tank support. Fasten the nuts until the coil springs touch, then unscrew 3 ½ turns.
14. Lower the vehicle. Bolt the tank support to the frame (figure 4).
15. Connect electrical wiring to fuel level sender assembly.
16. Reinstall all fuel lines. Use Loctite 567 type thread sealant on line fitting.
17. Reconnect both L.H. side and R.H. side filler tubes to the fuel tank. Tighten the hose clamps.
18. Reinstall the fuel tank access panels.
19. Open the manual shut-off valves on the primary, secondary fuel filters or on the optional Fuel Pro 382 diesel filter.

20. The installation is now completed.

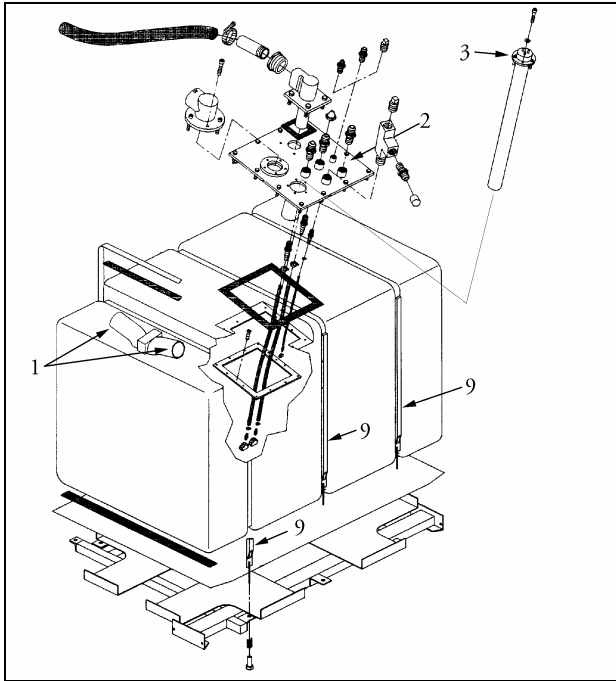

FIGURE 3 : FUEL TANK DETAILS

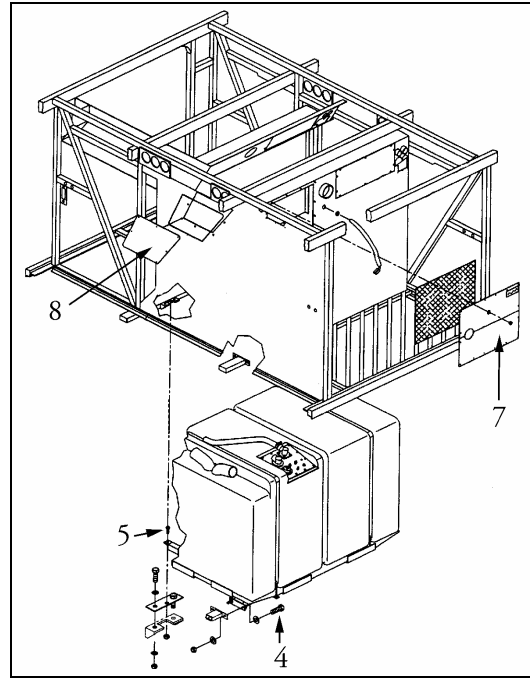

FIGURE 4 : ASSEMBLY OF FUEL TANK SUPPORT AND FRAME

**Caution :** For proper assembly, check connections and fasteners for tightness.

**Note :** If you are experiencing problems restarting the engine, refer to section 3 of the Maintenance Manual under "Priming Fuel System".