

CARE AND MAINTENANCE

CLEANING

The cleaning information provided in this section is regarded as recommended cleaning practices. Cleaning results may vary depending on the condition of the stain. Always clean stains promptly for best results.

NOTE

Use only approved cleaning products such as Prevost A.P.C., all purpose cleaner (Prevost # 683664). Never use stain protection products on new fabrics. To prevent permanent staining of fabrics, clean stains soon after they occur. Incorrect treatment of stains can worsen them. Get help from a cleaning specialist to remove stubborn stains.

⚠ CAUTION ⚠

Custom fabrics and materials may require different cleaning and maintenance practices. Consult your converter.

SEAT UPHOLSTERY

Firmly beat the fabric with a blunt object, such as a wooden paddle, to release dust and dirt. Vacuum the seat fabric in the direction of the stitching using an upholstery nozzle.

NOTE

The abrasive nature of dirt and grit. will reduce upholstery life expectancy. Vacuum regularly.

Removal Of Stains And Marks

Depending on the nature of the stain, apply one of the two methods explained below to remove stains and marks on wool plush.

Method One:

1. Apply a nonflammable solvent (Trichloroethylene) to stained area with a clean, white absorbent rag;
2. Clean stain by starting at the outer edges of the stain and working in toward the center;
3. Blot affected area frequently with a clean, dry absorbent cloth to prevent stain rings caused by excess solvent.

⚠ WARNING ⚠

Use solvents in a well ventilated area. Open all windows and doors.

Method Two

1. Wet the stain with a solution of household detergent and lukewarm water. Do not soak the stain;
2. Rub the stain with a damp cloth;
3. Rinse cloth after each application.

⚠ CAUTION ⚠

Do not use soap, soap powder, ammonia, soda, bleach or cleaning products containing any of these compounds.

Beverage Stains

Remove beverage stains by following method one. If stain persists, repeat method one using methylated spirits instead of solvent.

Alcoholic Beverage Stains

Remove alcoholic beverage stains by wetting the stain with water, then cleaning following method two.

Burns

Scrape burnt area using a knife or razor blade then clean following method two. Consult an upholstery specialist when dealing with extensive burns.

Cosmetic Stains

Remove stains left by cosmetics by following method one then method two.

Ink Stains

Remove ink stains following method two. If stain persists, apply a warm oxalic acid solution. Rinse with water.

Blood, Urine Or Vomit Stains

Remove such stains by following method two.

Copying Ink - Ball-Point Pen Ink

Treat with methylated spirits, blotting frequently to avoid spreading stain, followed by method two.

Marking Ink (Felt-tip Pens)

Treat with Methyl-Ethyl-Ketone (MEK) followed by method two.

CARE AND MAINTENANCE

Oil, Grease And Paint

Remove excess using a knife. Treat with method one followed by method two. If stain persists, repeat procedure.

Rust Stains

Remove rust stains by following method two. Apply a warm oxalic acid solution to stained area. Rinse with water.

Tar

Soften tar with benzene, then treat using method one followed by method two.

Chewing Gum

Soften gum with cyclohexane. Carefully scrape off stains using a sharp knife or razor blade.

PLASTIC AND VINYL

Clean plastic and vinyl trim using a clean damp cloth or sponge. For vinyl trim marks, use a lukewarm all purpose cleaner or a mild saddle soap. Remove water spots and soap traces using a clean damp cloth or sponge. Dry with a clean soft cloth.

Remove grease, tar or oil stains with a clean cloth or sponge and an all purpose or solvent-type vinyl cleaner.

Apply a colorless vinyl or leather protective product to maintain the luster and pliability of the plastic or vinyl surface.

WINDOWS

Clean the inside of the windows with a solution of one part vinegar to ten parts water.

STAINLESS STEEL

Use a stainless steel cleaner and follow the manufacturer's instructions. Stainless steel cleaning solution may be ordered from Prevost Car Inc. quoting part number 68-0356.

FORMICA

Remove stains on formica surfaces with a household detergent, methylated spirits or mineral turps. Clean with a mild abrasive and water solution if stain persists.

CARPET

Vacuum carpets regularly to prolong carpet life.

RUBBER COMPONENTS

Use only pure water or glycerin to clean stains on rubber components.



Never use solvents on rubber components.

FLOOR CLEANING

Clean vinyl floors with a quality nonionic detergent cleaner. Follow the manufacturer's recommendations for cleaning.

Remove any excess detergent solution using a wet/dry vacuum or mop. Rinse floor with a solution of one part Clorox to ten parts warm water.

Polish dry floor using a high-speed buffer and a smooth red 3-M polishing pad.

Mop floor periodically with a solution of 5 per cent Clorox in warm water.

NOTE

For custom or special floor covering materials, consult the manufacturer or your converter for information on how to clean and maintain these types of floors.

EXTERIOR SURFACES

Frequent washing and waxing of the vehicle exterior will help protect the finish and luster. The paint finish is attacked by the abrasive effects of airborne particles and corrosive pollutants.

Before washing the exterior of the vehicle, close the fresh air dampers using the "REC" button located on HVAC control panel and on the air intake duct in the evaporator compartment. Install keyhole protectors to prevent water from penetrating. Rinse vehicle with water to remove all loose dirt. Wash vehicle using a quality brand car wash soap. Follow manufacturer's recommendations for cleaning. Rinse well with water.

The vehicle exterior should be cleaned, waxed and buffed when water droplets no longer form on the painted surfaces.

⚠ CAUTION ⚠
Hot water can damage paint. Keep water cool or lukewarm.

⚠ CAUTION ⚠
Make sure cleaning solutions are not harmful to painted surfaces. Read the manufacturer's instructions before using.

⚠ CAUTION ⚠
Do not spray water jet directly into fresh air inlet dampers.

⚠ CAUTION ⚠
Do not aim high pressure water jet at radiator doors. This could damage the radiator fins.

To prevent corrosion, remove caked-on dirt and road salt from the vehicle underbody using a high pressure water jet. Clean wheel housings, bumpers, muffler, tailpipe and brackets.

Carry out corrosion prevention cleaning at least twice a year. Spray underneath of the vehicle and let soak before cleaning. Let engine and exhaust system cool down before cleaning.

Tar Or Oil

Remove tar or oil as soon as possible with an approved automotive tar and oil remover or turpentine. Thoroughly clean area with car wash soap and water. Let dry, then wax.

Insects

Remove insect stains as soon as possible with lukewarm soap and water or insect remover.

Tree Sap

Remove tree sap or bird droppings with lukewarm soap and water. Do not allow to harden.

WINDSHIELD

To prevent windshield wiper streaking, keep silicone sprays away from windshield. Remove road film and wax build-up from windows with lukewarm soap and water or with an alcohol-based cleaning agent. If a chamois is used to dry and polish glass, use it exclusively for that purpose.

Wiper Blades

To avoid tearing frozen wiper blades, loosen them before removing. Remove and clean wiper blades periodically with an alcohol-based cleaning solution. Clean wiper blades using a sponge or soft cloth.

FLUID LEVEL VERIFICATION

Periodic inspection of oil level is the most economical and easiest way to help your vehicle perform at its best. Rigorous oil level inspection and replacement will greatly help minimize expensive and unscheduled repairs.

ENGINE OIL LEVEL

Check engine oil level when engine is still warm and with vehicle parked on a level surface. Shut OFF engine and wait at least 10 minutes for oil to drain into oil pan before checking. Check engine oil level daily or before each trip. Add oil as required. Do not overfill. Remove dipstick, wipe clean and fully reinsert to ensure an accurate reading. Remove dipstick and check engine oil level.

The oil level must be maintained between the two marks indicated on the dipstick. Do not let the oil level drop below the L mark. Add oil by opening the oil reserve tank drain valve or through the oil filler tube. Use the markings on the tank to check the quantity of oil added. Close the oil reserve tank drain valve or oil filler cap after adding oil. Recheck the oil level. Do not let the oil level go above the F mark on the dipstick.

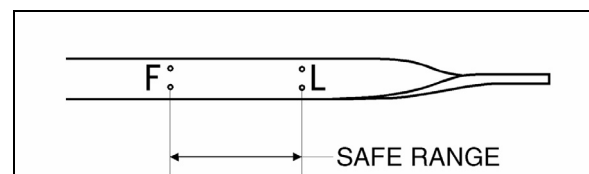

ENGINE OIL LEVEL DIPSTICK

01027

⚠ CAUTION ⚠
Keep engine oil level between "L" and "F" on dipstick. Do not overfill. Check when refueling.

CARE AND MAINTENANCE

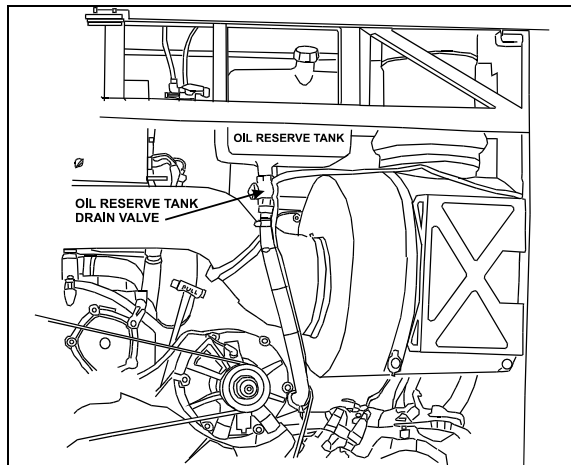

ENGINE COMPARTMENT

01063

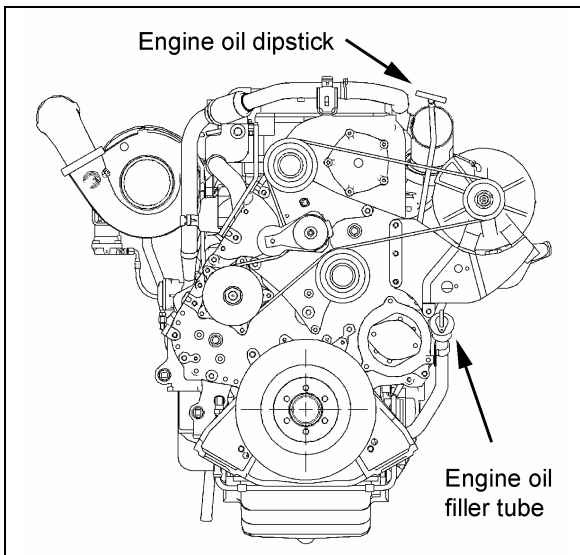

ENGINE COMPARTMENT

01051

AUTOMATIC TRANSMISSION OIL LEVEL

Transmission fluid level may be checked using dipstick or transmission control pad display. Refer to section "Technical Information" in this manual for how to use the control pad as a transmission oil level indicator.

The automatic transmission oil level dipstick is accessible through the engine compartment rear door and is located on the left side of the engine.

To check the transmission oil level, a "cold check" and a "hot check" must be performed. A cold check must be made when the transmission oil is between 60°F and 140°F (16°C and 60°C).

NOTE

Perform the cold check first to verify the transmission oil level before performing the hot check.

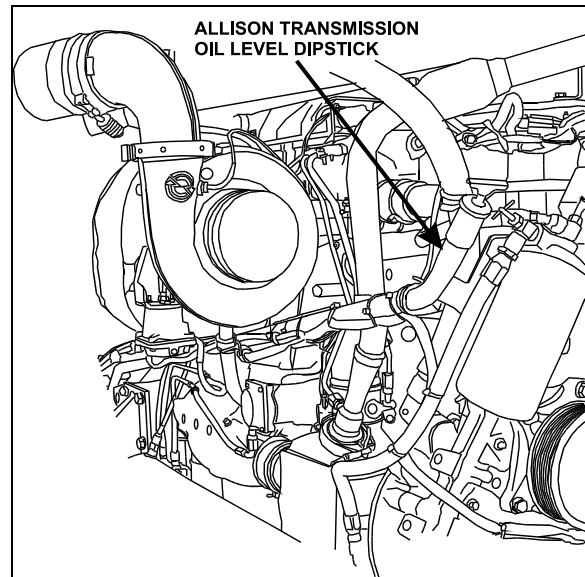

AUTOMATIC TRANSMISSION OIL LEVEL DIPSTICK

⚠ WARNING ⚠

To prevent personal injury, do not service transmission wearing loose clothing. Stand clear of the engine and rotating components while checking the oil level.

⚠ CAUTION ⚠

Do not mix fluid types or brands because of possible incompatibility.

⚠ CAUTION ⚠

Use clean fluid and containers when filling transmission. Never use containers that have contained water or anti-freeze (Glycol).

To prevent dirt and foreign matter from entering the transmission, clean the end of the oil fill tube before removing dipstick. To remove dipstick, unscrew filler cap approximately three turns and pull out dipstick.

Cold Check

Run the engine until the transmission oil temperature is between 60°F and 120°F (16°C and 50°C). With the engine idling, make sure the parking brake is applied and the transmission is in neutral (N). Remove and wipe the dipstick with a clean cloth. Check oil level. If the oil level is within the COLD RUN band, the oil level is correct and a hot check can be performed. If the oil level is on or below the lower line of the COLD RUN band, add oil until the level lies within the COLD RUN band. If the oil level is above the COLD RUN band, drain oil until the level is within the band.

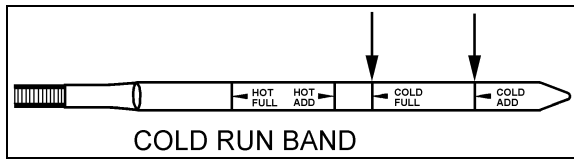

AUTOMATIC TRANSMISSION OIL LEVEL DIPSTICK 07006

CAUTION

The oil level rises as oil temperature rises. Do not add oil above the "cold run" band before the transmission reaches 180°F to 220°F (82°C to 104°C).

Hot Check

Make sure the transmission oil temperature is between 180°F and 220°F (82°C and 104°C) before performing the hot check. Run the engine between 1,000 and 1,200 RPM for approximately one minute to purge air from the system. With the engine idling and the parking brake applied, shift transmission from forward (D) to reverse (R) and back into neutral (N) to fill clutch cavities with oil. Remove and clean dipstick, then check oil level. If the oil level is on or under the lower HOT RUN line, add just enough oil to bring up the level to the middle of the HOT RUN band.

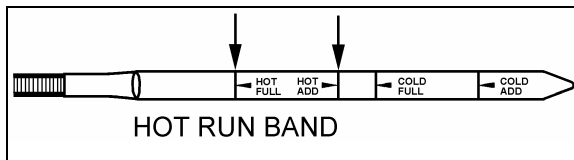

AUTOMATIC TRANSMISSION OIL LEVEL DIPSTICK 07006

NOTE

Approximately 1 quart (0.95 liters) of oil will raise the oil level from the lower line of the HOT RUN band to the middle of the HOT RUN band.

Replace dipstick and tighten the filler tube cap until the rubber seal is correctly seated.

CAUTION

Do not overfill transmission oil reservoir. Severe damage may result.

POWER STEERING FLUID LEVEL

The vehicle is equipped with a power steering system. The hydraulic fluid tank is located in the engine compartment.

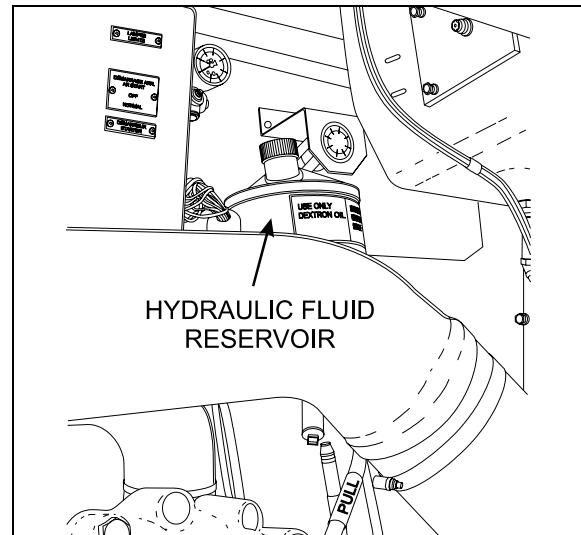

ENGINE COMPARTMENT

14044

Check fluid level as follows:

1. Stop engine, open engine compartment doors and place rear start switch to OFF position;
2. Unscrew and remove the dipstick located on top of the fluid tank and wipe with a clean rag;
3. Replace dipstick in tank, then remove to check fluid level;
4. Add hydraulic fluid until it reaches the FULL mark on the dipstick (use Dexron II, Dexron IIE, Dexron III or Mercon fluid type);
5. Replace and tighten dipstick;
6. Place engine rear start switch to NORMAL position. Close engine compartment doors.

RADIATOR FAN GEARBOX OIL LEVEL

The radiator fan is belt-driven by the engine crankshaft pulley through a gearbox and drive shaft. A dipstick located on top of the gearbox is used to check the radiator fan gearbox oil level.

Check radiator fan gear box oil level as follows:

1. Stop engine, open engine compartment R.H. side door and place battery master switch to the OFF position;
2. Open engine compartment doors and place engine starter switch to OFF position;
3. Remove the dipstick located on top of the gearbox and wipe with a clean rag;
4. Insert dipstick in gearbox case, then remove again to check mark;

CARE AND MAINTENANCE

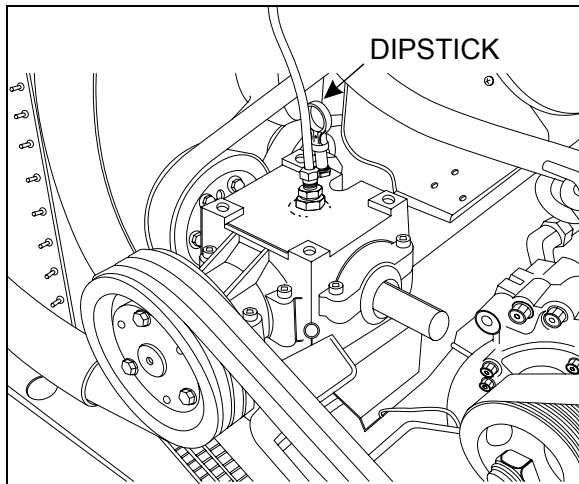

ENGINE COMPARTMENT

05062

5. Add, if necessary, MOBIL SHC 630 synthetic lubricant (Prévost #180217) until it reaches "FULL" mark;

NOTE

Mobil SHC 630 is a new lubricant and is not compatible with SHC 634 lubricant that was previously used.

6. Reinsert the dipstick;
7. Place engine rear start switch to *NORMAL* position. Close engine compartment doors;
8. Set battery master switch to *ON* position.

DRIVE AXLE WHEEL BEARING OIL LEVEL

Drive axle wheel bearings are lubricated by the differential oil. Maintain differential oil at correct level to ensure adequate lubrication of drive axle wheel bearings at all times.

FRONT AND TAG AXLE WHEEL HUBS

The unitized hub bearings used on the NDS range of axles, are non-serviceable items. Bearings are pre-adjusted, lubricated and have seals fitted as part of the manufacturing process. The bearings are greased for life and there is no need or facility for re-lubrication.

COOLANT FLUID LEVEL

Coolant level is correct when coolant is visible through the surge tank sight glass when cold. If coolant level is low, fill system with the same 50-50 mixture normally used.

CAUTION

Use only coolant that meets DDC specs for use in DDC engines.

The cooling system must be maintained according to DDC maintenance specs for coolant, ratio of 50/50 and supplemental coolant additives (SCAs). Failure to do so could damage the cooling system. Refer to Maintenance Manual or DDC for instructions.

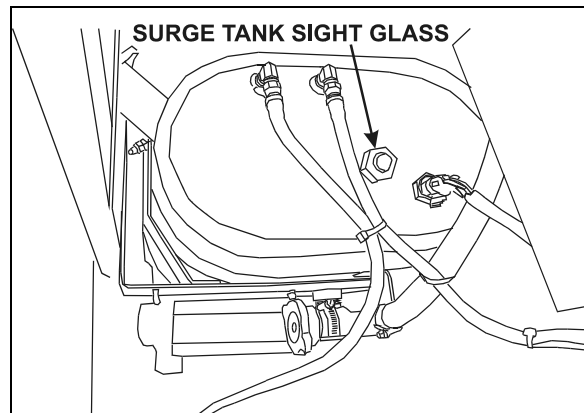

ENGINE COMPARTMENT

05094

WARNING

Hot engine coolant is under high pressure. Allow engine to cool down before adding coolant.

WINDSHIELD WASHER TANK

The windshield washer reservoir is located in the front service compartment door. The reservoir has a capacity of 5.3 US gallons (20 liters). Check fluid level regularly.

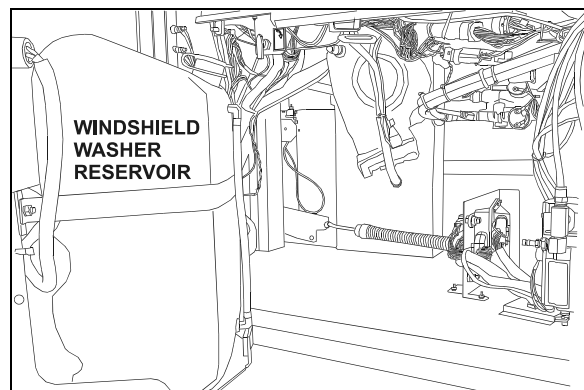

FRONT SERVICE DOOR

18381

The spray jets are located on the windshield wipers and are angled to spray towards the center of the windshield.

OTHER VERIFICATIONS

AIR TANK PURGE

The vehicle may be equipped with up to twelve air tanks. Purge accessory and wet air tanks before each trip. The primary and secondary air tanks must be purged at every oil change. Oil changes should be scheduled at least every 12,500 miles (20 000 km).

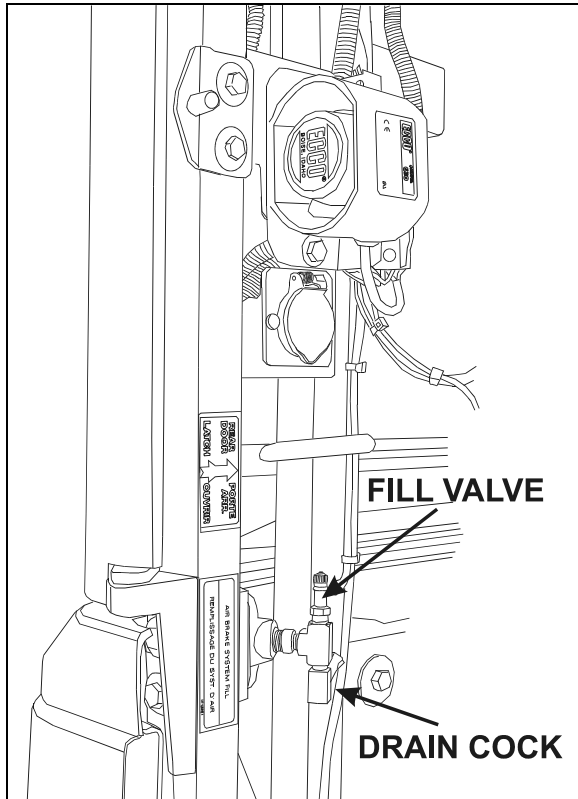

FRONT SERVICE COMPARTMENT 12130

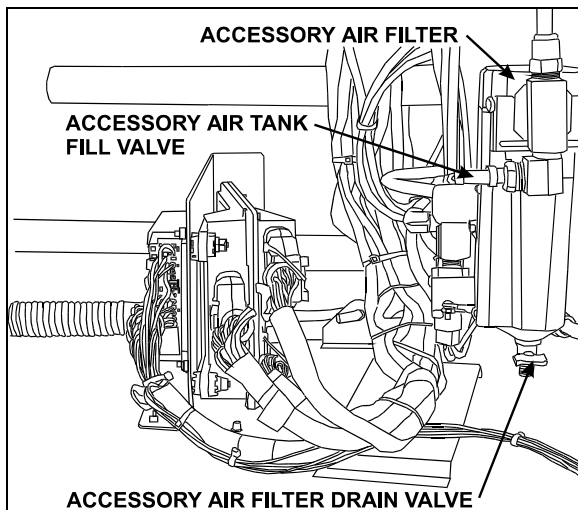

FRONT SERVICE COMPARTMENT 12162

The accessory air tank drain cock is accessible from the front service compartment. The wet air tank drain cock is accessible from the engine compartment. All air tanks are equipped with a drain cock underneath the tank. Refer to the "Lubrication and Service Check Point Chart" in the "Maintenance Manual" for tank locations.

Drain tanks by turning cocks counterclockwise.

FIRE EXTINGUISHERS

Inspect fire extinguishers monthly to insure operation in emergency situations.

On extinguishers with a pressure gauge, the needle should be in the green or *NORMAL* range. Refill or replace extinguisher if pressure is below normal;

Check that seal on handle is intact;

Check that hose nozzle is in good condition and the nozzle is free of obstruction;

Keep fire extinguishers clean.

FUEL FILTER / WATER SEPARATOR

The optional water separator installed in the engine compartment is used to prevent water from entering the fuel system. The water separator should be drained periodically or when the water separator telltale light on the dashboard illuminates. To drain water, loosen bleed screw below separator one quarter turn. Tighten bleed screw when finished.

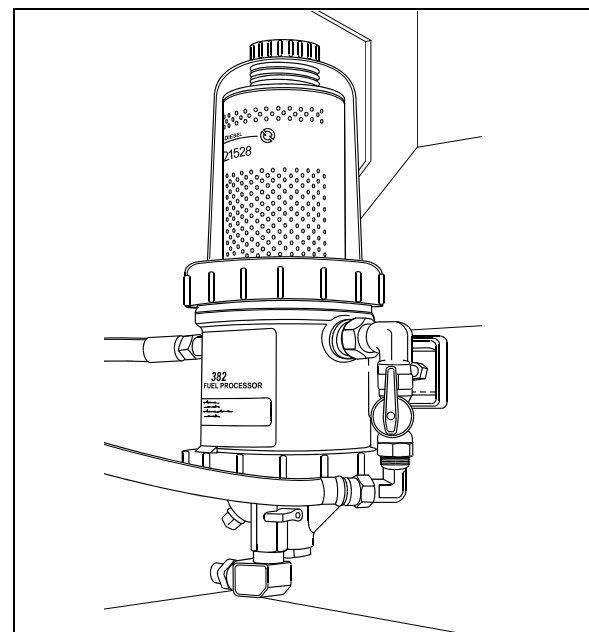

FUEL FILTER / WATER SEPARATOR 03032

CARE AND MAINTENANCE

BELT TENSION ADJUSTMENT

The radiator transfer fan and air conditioning compressor are driven by V-belts.

Belt tensioning is applied through air bellows which are adjusted by an air pressure regulating valve mounted in the engine compartment, right behind the belt tensioning pressure control valve. The correct pressure of 45 psi (310 kPa) for W5 and 50 psi (345 kPa) for W0 and WE is set at the factory. Periodically verify the pressure at the regulating valve using a tire pressure gauge and correct if necessary. The distance between the stop and the plate at the top of the bellow should be approximately 1/4" (7 mm).

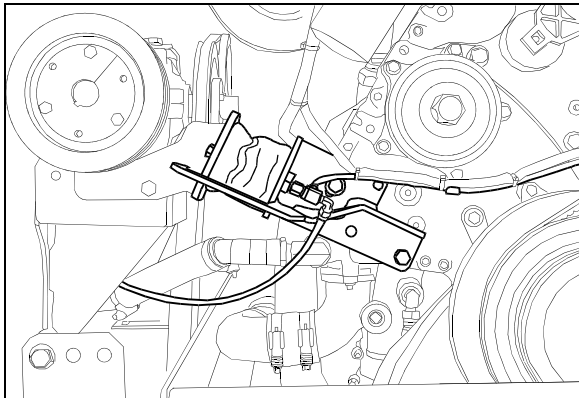

AIR BELLOWS

01059

For belt replacement, air pressure must be released from bellows by means of the belt tensioning pressure control valve. This valve, mounted close to the pressure regulating valve, is manually operated. Before handling, be sure that all engine stopping safety precautions have been observed.

- Refer to the Parts Manual, Maintenance Manual or "Service Bulletins" for recommended belt sizes and tension settings;
- Periodically inspect belt and pulleys for wear or damage;
- Do not treat belts with any compounds. Keep belts dry.

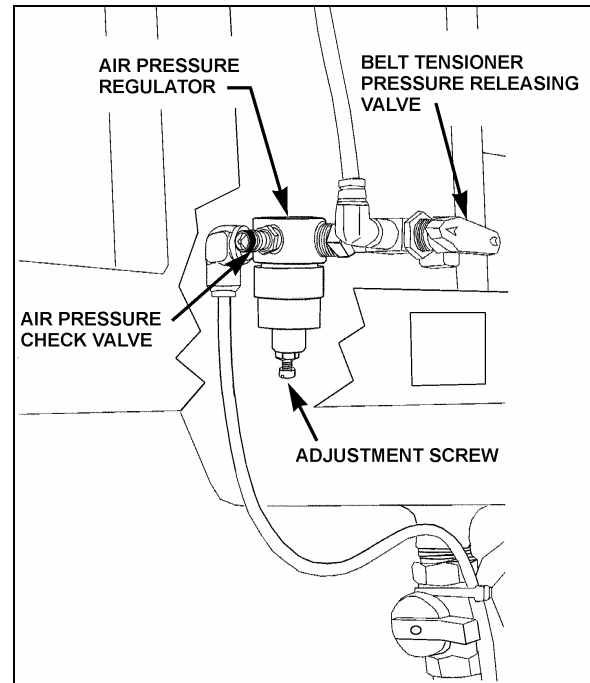

PRESSURE REGULATING VALVE

12175

BACK-UP CAMERA

The optional back-up camera is located on the rear cap. To clean the camera's protective glass, spray with soapy water. Wipe with a clean damp rag or wiper blade.

⚠ WARNING ⚠

To avoid injury, do not clean camera with transmission in reverse (R). Shut off engine and apply parking brake before cleaning.

⚠ CAUTION ⚠

To prevent scratches to the camera protective glass, do not wipe with dry rag. Use a clean damp rag.

AIR FILTER RESTRICTION INDICATOR

A filter restriction indicator (optional) is used to monitor the vacuum level between the air filter and engine. A red marker is displayed when the air filter is clogged. When a red marker is displayed, the air filter must be replaced. Reset by pressing on the indicator's extremity.

The filter restriction indicator is located on the engine air intake duct.

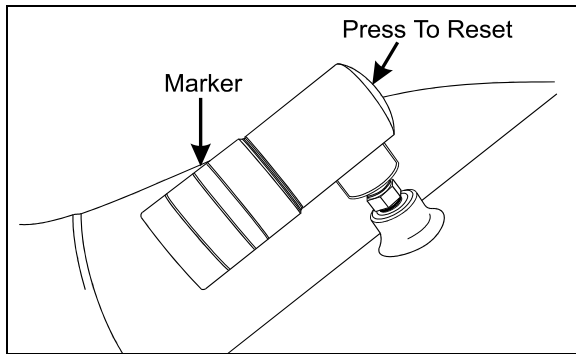

RESTRICTION INDICATOR

01052

A/C AND HEATING SYSTEM AIR FILTERS

For maximum air conditioning and heating system efficiency, air filters should be inspected and cleaned as required in maintenance schedule to ensure proper ventilation of the evaporator and heating radiator cores. To clean filters, back flush with water, then dry with air.

CAUTION
Do not use high pressure water jet to avoid damaging filter.

CAUTION
Be sure not to reverse filter upon installation.

DRIVER'S AREA AIR FILTERS

The driver HVAC system's air filters are located behind the R.H. console. To gain access to the A/C filters, unscrew the grill located at the top step of the entrance door steps. Remove the filters for cleaning or replacement.

NOTE
If the windshield is continuously fogged, check that the driver's air filter is not clogged.

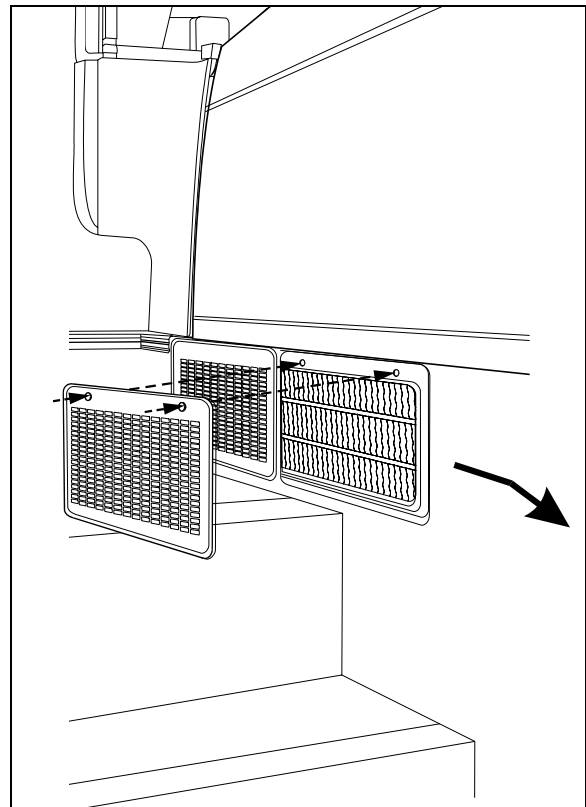

DRIVER'S AREA AIR FILTER REMOVAL

22172

CABIN SYSTEM AIR FILTER

The central HVAC system's air filters are located in the evaporator compartment on L.H. side of the vehicle. To gain access, open evaporator compartment door. Remove filter panel by unscrewing the six fixing screws. Slide out the filter for cleaning.

CAUTION
Be sure not to install filter in inverted position.

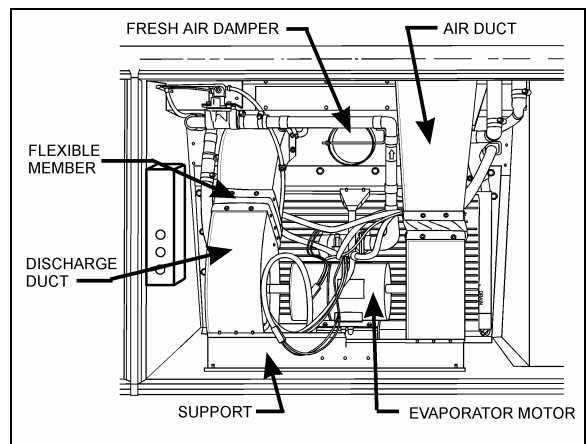

CABIN SYSTEM AIR FILTER REMOVAL

22178

CARE AND MAINTENANCE

HOSE INSPECTION

Inspect hoses regularly to ensure efficient, economical and safe operation of the engine and related equipment.

LUBRICATION

Grease all lubrication points during scheduled maintenance. For heavy loads or extended use, lubricate more often. Refer to the Maintenance Manual, section 24 for information on lubrication.

PRE-STARTING INSPECTION

WITH ENGINE STOPPED:

Inspect hoses for leaks. Carefully inspect all fittings, clamps and ties. To prevent chafing, make sure hoses are not touching shafts, couplings, heated surfaces, sharp edges or other parts. Since hose clamps and ties can vibrate loose or fail over time, inspect frequently and tighten or replace as necessary.

Check for loose nuts and bolts. Visually inspect safety of compartment door latches. Test operation of all exterior lights.

CAUTION

All hose clamps of 1 3/8" ID and over, used on the heating and cooling systems, are of the "Constant-torque" type. This type of clamp is designed to automatically adjust its diameter to compensate for the normal expansion /contraction of a hose and metal connection that occurs during vehicle operation and shutdown. A torque wrench should be used for proper installation. The recommended torque is 90 to 100 lbf-in. (10 to 11 Nm). The hose clamps will break if over-torqued and cause loss of coolant. Do not over-tighten, especially during cold weather when hose has contracted.

Leaks

Check for leaks under vehicle and in compartments.

Correct leaking hoses immediately. Failure to correct leaks can cause severe damage to the equipment, as well as increase operating costs due to lost fluids. Treat fuel and oil leaks as an immediate fire hazard.

WARNING

Fire hazard - personal injury and property damage may result from fire caused by leaking flammable fluids.

Hose Service Life

Hoses have a limited service life. Thoroughly inspect hoses annually. Look for surface damage or indications of twisted, worn, crimped, cracked or leaking lines. Replace damaged hoses immediately.

Hoses should be replaced during major overhaul or after a maximum of five years service. Make sure replacement hoses match the original equipment manufacturer's specifications.

Wheels And Tires

Check for loose wheel nuts. Both aluminum alloy and steel wheel nuts should be tightened to 450 to 500 lbf-ft (610 to 680 Nm) torque.

Tire Pressure

Keep the tires inflated to the recommended inflation pressure to prolong tire life and for safety.

NOTE

Recommended tire inflation pressures are given in the "Coach Final Record", placed in the technical publications package supplied with the vehicle. The cold tire inflation pressures are on the Department of Transport certification plate located on the L.H. console besides the driver's seat.

WARNING

Do not exceed maximum inflation pressure. Incorrect tire pressure increases tire wear and could lead to loss of driving control because of reduced road handling. Check tire pressure regularly.

Doors

Close all exterior doors and windows. Check for good tightness and fit.

Tools And Spares

Make sure the vehicle is equipped with a wheel nut wrench, door keys, spare belts, reflectors and jack.

Air System

To purge water from air and accessory tanks, open drain cocks. Close drains when completed. Refer to heading "Air Tank Purge" in this chapter.

Water Separator

To purge water separator, loosen bleed screw. Tighten bleed screw after purging.

Coolant Level

Check coolant level. Coolant level is correct when visible in the filler neck of the surge tank. If coolant level is low, fill system with 50-50 coolant mixture. Refer to the vehicle "Maintenance Manual" for more information.

△ WARNING △

Hot engine coolant is under pressure. Do not attempt to open the coolant filler cap when the engine is hot. Allow engine to cool before adding coolant.

Wheel Bearings

Check wheel bearing cover for overheating (especially after brake work) during fuel stops by touching the wheel bearing cover.

Windshield Washer Reservoir

Make sure windshield washer reservoir is full. For cold weather, use antifreeze windshield washer fluid.

Engine Oil

Check engine oil level during fuel stops. It is normal for diesel engines to burn some oil. If the oil level is low, refer to heading "Engine Oil Level" in this chapter.

△ WARNING △

Check the engine oil level with vehicle parked on a level surface and with the parking brake engaged.

Power Steering Oil Tank

Check steering oil level. Refer to heading "Power Steering Fluid Level" in this chapter.

Belts

Check for loose, worn or broken belts.

Belt Tension Adjustment

Check belt tension using a pressure gauge. Refer to heading "Belt Tension Adjustment" in "Other Verifications" section in this chapter.

Fire Extinguishers

Check fire extinguishers to make sure they are ready for operation. Refer to heading "Fire Extinguishers" in "Other Verifications" section in this chapter.

Emergency Exits

Verify emergency exits for correct operation.

Driver's Section

Adjust driver's mirrors and seat.

WITH ENGINE RUNNING:**Leaks**

Walk around vehicle and listen for air leaks.

Turbocharger

Check for leaks and listen for unusual sounds coming from the turbocharger.

Automatic Transmission

Check automatic transmission oil level. Refer to heading "Automatic Transmission Oil Level" in this chapter.

Gauges and Buzzers

Perform a telltale light test (see "Controls and Instruments" chapter). Make sure gauges are in normal operating condition. Indicator lights and buzzers should all be *OFF* before driving.

Fuel Level

Make sure fuel level is sufficient.

Service Brakes

Check for correct pressure build-up. Pressure loss should not exceed 3 psi/minute (21 kPa/minute) with engine stopped and without brake applied. Perform a full brake application. Air loss should not exceed 7 psi/minute (48 kPa/minute).

CARE AND MAINTENANCE

Brake Test

Release parking and emergency brakes. Pump service brake pedal until air pressure drops to 65 psi (448 kPa). Make sure the warning buzzer operates and that the emergency brakes apply (the control valve knob lifts up). Allow air pressure to reach 95 psi (655 kPa) before releasing parking brake.

Parking And Emergency Brake Test

Driving the vehicle while the parking brake is applied should not be possible.

FIRST SERVICE ON NEW VEHICLE

NOTE

Refer to Maintenance Manual for precise service schedule.

ENGINE OIL

Preliminary oil change is not required since the engine has been test-run at the factory. Change oil and filter every 12,500 miles (20 000 km) or once a year, whichever comes first.

AUTOMATIC TRANSMISSION OIL FILTER

Replace World transmission main filter cartridge after the first 5,000 miles (8 000 km) and then, according to the lubrication and servicing schedule, depending if the vehicle is equipped or not with a retarder and depending on the type of oil used (Dexron-III/VI or TranSynd fluid).

COOLANT SYSTEM STRAINER

The coolant system strainer is designed to recover the soldering residues trapped inside the coolant lines during their initial assembly. Clean strainer after first 3,000 miles (5 000 km) and then every 50,000 miles (80 000 km). Refer to the Maintenance Manual under section 05: Cooling System.

NOTE

If soldering has been performed on cooling system, clean strainer after 3,000 miles (5 000 km).

GENERAL RECOMMENDATIONS

- Understand basic principles of vehicle operation;
- Always maintain the vehicle in good running condition;
- Do not drive with low fuel. If the fuel tank runs dry, the engine will not start until the air is bled from the fuel system. Refer to "Maintenance Manual" for more information;
- Allow engine to run for at least two minutes at slow idle before shutting *OFF*;
- Engine should be at idle when shifting from neutral (N) to forward (D) or from neutral (N) to reverse (R);
- The automatic transmission does not have a park (P) position. Place transmission in neutral (N) position and apply parking brake when the vehicle is stopped. A warning buzzer will sound if the engine is stopped and the parking brake has not been applied when foot pressure is removed from the brake pedal;
- Always follow the procedures described in this manual;
- Unless stated otherwise, shut *OFF* the engine before performing all servicing, lubrication and maintenance tasks;
- Do not attempt to push or pull-start a vehicle equipped with an automatic transmission;
- The vehicle may be damaged if towed with the axle shafts or driveshaft connected. Do not push or pull-start the vehicle in first or reverse gears;
- Two chemical fire extinguishers are stored near the back of the driver's seat. In case of fire, immediately evacuate all occupants. Human life safety is the first priority. Do not attempt to extinguish the fire if there is immediate danger or risk for personal injury;
- When driving on ice and snow, accelerate and decelerate gradually.

⚠ WARNING ⚠

Report all problems affecting passenger or driver safety to your service center or an authorized service center. Have problems corrected immediately.

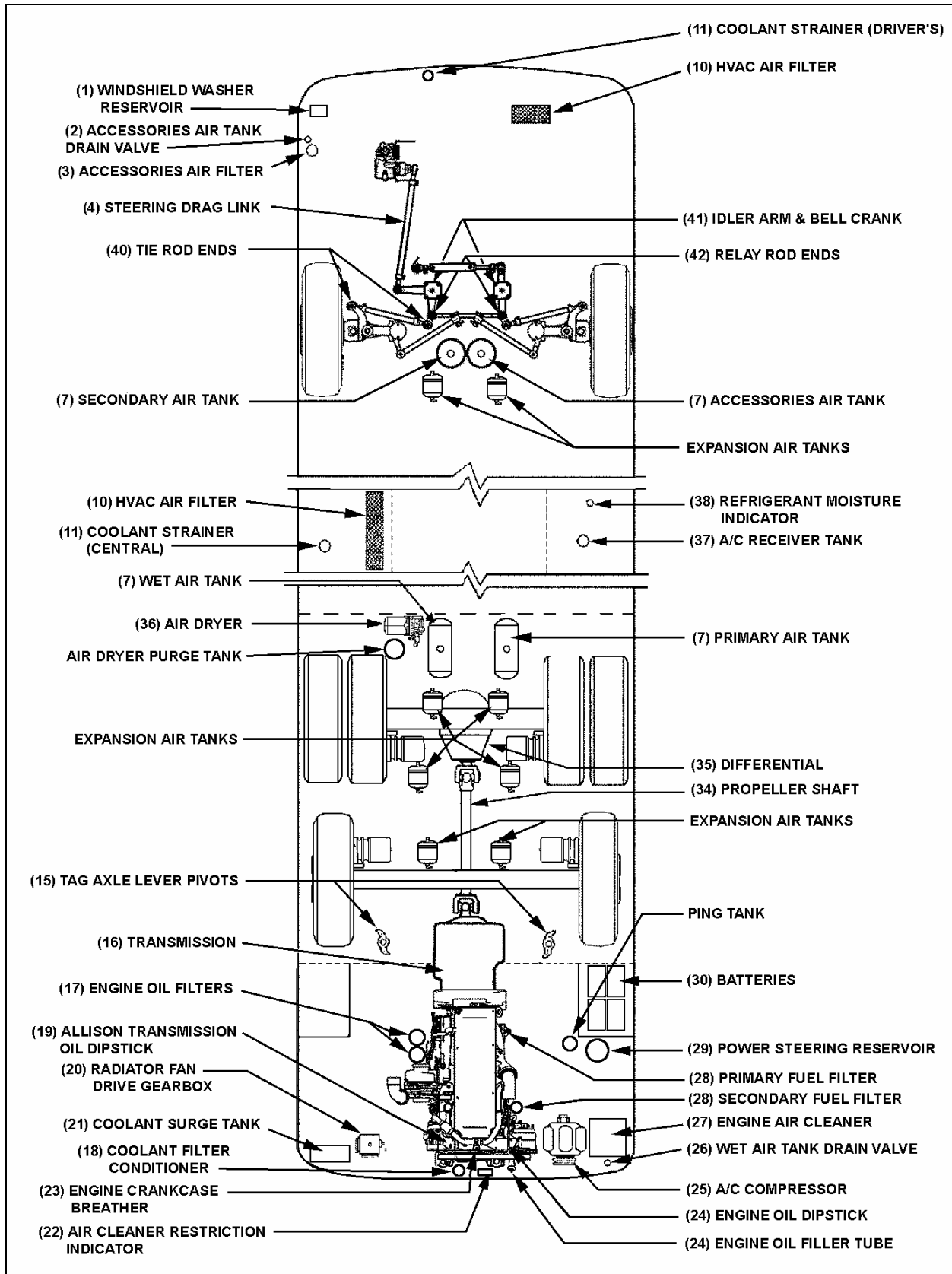

LUBRICATION AND SERVICING POINTS (TYPICAL)

24026

CARE AND MAINTENANCE

WALK-AROUND INSPECTION (BEFORE EVERY TRIP)

It is a good practice to make a basic visual inspection of key areas on the vehicle before every trip and to report any problem areas to your Prévost service center or a Prévost-authorized service center.

Outside The Vehicle

ITEM*	DESCRIPTION
---	Check for leaks under vehicle and in engine compartment.
---	Check that baggage and service compartment doors are properly closed.
---	Inspect tires and wheels for correct tire pressure, wear or damage and for missing wheel studs and nuts.
1	Check windshield washer fluid level and add if necessary.
---	Check condition of windshield wiper blades.
---	Verify proper operation of all road lights, signal lights, brake lights, marker lights and back up lights; Replace light bulbs as required.
2-26	Drain accumulated water in accessory and wet air tanks.

Engine Compartment

ITEM*	DESCRIPTION
24	Check engine crankcase oil level; add if necessary.
19	Check transmission oil level (can be checked from push-button shift selector); add if necessary.
29	Check power steering reservoir fluid level; add if necessary.
21	Check coolant surge tank fluid level; add if necessary.
28	Drain accumulated water in primary fuel filter/water separator (if equipped).
22, 27	Check air cleaner restriction indicator; Replace air cleaner when red signals locks in full view.

Inside The Vehicle

ITEM*	DESCRIPTION
---	Check for proper operation of the entrance door.
---	Check that emergency exit windows and roof escape hatches can be opened, then close all windows and hatches securely.
---	Verify proper operation of windshield wiper/washer.
---	Adjust mirrors for adequate rear view vision.
---	Start engine and check for proper operation of all gauges and indicator lights.
---	Check for proper operation of electric and air horns and back up alarm.

* Item numbers refer to figure on lubrication and servicing points of this section.

LUBRICATION AND SERVICING SCHEDULE

SERVICE EVERY 6,250 MILES (10 000 KM) OR TWICE A YEAR, WHICHEVER COMES FIRST.

ITEM*	DESCRIPTION	REMARKS	LUBRICANT &/OR PART**
27	Engine Air Cleaner	Inspect and replace element if required	Filter: #530197
---	Engine Air Pre-Cleaner	Check discharge tube	-----
25	A/C Compressor	Check oil level, add if necessary	Polyolester Oil
37	A/C Receiver Tank	Check refrigerant level, add if necessary	HFC 134a
38	Refrigerant Moisture Indicator	Replace filter dryer unit according to moisture indicator (as needed)	Filter: #950332
20	Radiator Fan Drive Gearbox	Check oil level, add if necessary	Mobil SHC 630
34	Propeller Shaft	Grease one fitting on each universal joint and one fitting on slip joint	Multi purpose grease
15	Tag Axle Lever Pivot	Grease one fitting on each pivot	Multi purpose grease
---	Steering King Pins	Grease fitting	Multi-purpose grease
---	A-arm ball joints	Grease fitting	Multi-purpose grease
4	Drag Link Ends	Grease one fitting at each end	Multi purpose grease
36	Relay Rod Ends	Grease one fitting at each end	Multi purpose grease
40	Steering Tie Rod Ends	Grease one fitting at each end	Multi purpose grease
37	Idler Arm	Grease fitting	Multi purpose grease
37	Bell Crank	Grease fitting	Multi purpose grease

* Item numbers refer to figure on lubrication and servicing points of this section.

** See end of this section for lubricant and part number specifications.

SERVICE EVERY 12,500 MILES (20 000 KM) OR TWICE A YEAR, WHICHEVER COMES FIRST.

ITEM*	DESCRIPTION	REMARKS	LUBRICANT &/OR PART**
16	Allison World Automatic Transmission (if equipped with retarder)	Change oil and filters	Dexron-III/VI

CARE AND MAINTENANCE

SERVICE EVERY 12,500 MILES (20 000 KM) OR ONCE A YEAR, WHICHEVER COMES FIRST.

ITEM*	DESCRIPTION	REMARKS	LUBRICANT &/OR PART**
17	Engine Oil Filters	Change oil and filters	Engine oil: SAE 15W40, API CG4 Filters: #510458
28	Fuel Filters	Change primary and secondary fuel filters (Fill with clean fuel before installation)	Primary: #510137 Prim. w/sep.: #531390 Secondary: #510128
18	Coolant Filter/Conditioner	Replace element	Filter: #550630
21	Coolant Surge Tank	Test coolant solution	-----
7	Air Tanks	Drain accumulated water from all tanks	-----
10	A/C and Heating Air Filters	Clean or replace two elements (twice a year)	Driver's: #871049 Passenger's: #871051

SERVICE EVERY 25,000 MILES (40 000 KM) OR ACCORDING TO THE FLEET MAINTENANCE INTERVAL, WHICHEVER COMES FIRST.

ITEM*	DESCRIPTION	REMARKS	LUBRICANT &/OR PART**
35	Differential	Check oil level, add if necessary	Same type of gear oil

SERVICE EVERY 25,000 MILES (40 000 KM) OR ONCE A YEAR, WHICHEVER COMES FIRST..

ITEM*	DESCRIPTION	REMARKS	LUBRICANT &/OR PART**
16	Allison World Automatic Transmission without retarder	Change oil and filters	Dexron-III/VI

SERVICE EVERY 50,000 MILES (80 000 KM) OR ONCE A YEAR, WHICHEVER COMES FIRST.

ITEM*	DESCRIPTION	REMARKS	LUBRICANT &/OR PART**
20	Radiator Fan Drive Gearbox	Change oil	Mobil SHC 630
29	Power Steering Reservoir	Replace oil filter cartridge element	Cartridge: #660987
18	Coolant Strainer	Check and clean, change cartridge if required. ††	Cartridge: #871029
23	Engine Crankcase Breather	Clean breather steel mesh	-----
---	Hoses	Thoroughly inspect all hoses	-----

* Item numbers refer to figure on lubrication and servicing points of this section.

†† If soldering has been performed on the system, clean strainer after 3,000 miles (5 000 Km).

CARE AND MAINTENANCE

SERVICE EVERY 50,000 MILES (80 000 KM) OR ONCE EVERY TWO YEARS, WHICHEVER COMES FIRST

ITEM*	DESCRIPTION	REMARKS	LUBRICANT &/OR PART**
16	Allison Transmission (with or without retarder)	Change filters (if containing TranSynd fluid only).‡	Filters: #571709
16	Allison Transmission (equipped with retarder)	Change fluid (if containing TranSynd fluid only).‡	Fluid: TranSynd™

SERVICE EVERY 100,000 MILES (160 000 KM) OR ONCE A YEAR, WHICHEVER COMES FIRST

ITEM*	DESCRIPTION	REMARKS	LUBRICANT &/OR PART**
35	Differential	Change oil; Clean breathers	Multigrade gear oil

SERVICE EVERY 100,000 MILES (160 000 KM) OR ONCE EVERY TWO YEARS, WHICHEVER COMES FIRST

ITEM*	DESCRIPTION	REMARKS	LUBRICANT &/OR PART**
3	Accessories Air Filter	Change filter element	Filter: #641252
36	Air Dryer	Change cartridge	Cartridge: #641278

SERVICE EVERY 150,000 MILES (240 000 KM) OR ONCE EVERY FOUR YEARS, WHICHEVER COMES FIRST

ITEM*	DESCRIPTION	REMARKS	LUBRICANT &/OR PART**
16	Allison Transmission (without retarder)	Change fluid (if containing TranSynd fluid only).‡	Fluid: TranSynd™

SERVICE EVERY 250,000 MILES (400 000 KM) OR ONCE EVERY FOUR YEARS, WHICHEVER COMES FIRST

ITEM*	DESCRIPTION	REMARKS	LUBRICANT &/OR PART**
35	Differential	Change oil; Clean breathers	Full synthetic gear oil

MISCELLANEOUS SERVICE

ITEM*	DESCRIPTION	REMARKS	LUBRICANT &/OR PART**
18, 21	Cooling System	Drain, flush and refill every two years or 200,000 miles (320 000 km) whichever comes first	Engine coolant
30	Battery Terminals	Clean and coat terminals yearly	Battery terminal coating
---	Discharge Tubes***	Every three months: Check 2 condenser's discharge tubes Check 6 evaporator's discharge tubes Check 2 front discharge tubes	-----

* Item numbers refer to figure on lubrication and servicing points of this section.

** See end of this section for lubricant and part number specifications.

‡ When the transmission contains a mixture of fluids (defined as the quantity of non-TranSynd fluid remaining in the transmission after a fluid change combined with the quantity of TranSynd required to fill the transmission to the proper level), perform the fluid and filter change at 25,000 miles (40 200 Km) or 1 year, whichever comes first.

*** Discharge tubes are rubber tubes located under vehicle.

CARE AND MAINTENANCE

LUBRICANT SPECIFICATIONS

ITEM*	DESCRIPTION	SPECIFICATIONS
24	Engine Oil	SAE Viscosity Grade: 15W40 API Classification: CI-4
29	Power Steering Oil	Automatic Transmission Oil (Dexron-III/VI)
18, 21	Engine Coolant	Low silicate, ethylene glycol coolant 50% antifreeze/water solution is normally used Antifreeze concentration should be between 30% and 67%
25	A/C Compressor Oil	Polyolester Oil, HFC 134a compatible: Castrol SW-68 (POE) or equivalent
35	Differential Oil	Multigrade gear oil meeting MIL-L-2105-D: 85W140 If temperature drops below 10°F (-12°C), 80W90 should be used, and below -15°F (-26°C), 75W90 should be used. (In extreme conditions or for better performance, full synthetic gear oil can be used.)
20	Fan Gearbox Oil	Mobil SHC 630
19	Automatic Transmission Oil	Dexron-III/VI or TranSynd
---	Multi Purpose Grease	Good quality lithium-base grease: NLGI No.2 Grade is suitable for most temperatures NLGI No.1 Grade is suitable for extremely low temperatures

* Item numbers refer to figure on lubrication and servicing points of this section.

PART NUMBER SPECIFICATIONS

ITEM*	DESCRIPTION	PRÉVOST NO
17	Engine Oil Filters	#510458
29	Power Steering Reservoir Oil Filter	#660528
27	Engine Air Cleaner Filter	#530197
18	Refrigerant Filter Dryer Unit	#950262
28	Engine Primary Fuel Filter	#510137
28	Engine Primary Fuel Filter With Water Separator (Optional)	#531407
28	Engine Secondary Fuel Filter	#510128
28	Secondary "Racor" Fuel Filter	#531390
18	Engine Coolant Precharge Unit	#550629
18	Engine Coolant Filter/Conditioner	#550630
10	A/C And Heating Driver's Air Filter	#871147--871144
10	A/C And Heating Cabin's Air Filter	#871051
16	Automatic Transmission Oil Filter Kit	#571709
11	Coolant Strainer	#871029
3	Accessories Air Filter	#641340
20	Radiator Fan Drive Gearbox Oil	#180217
36	Air Dryer Cartridge	#641244
---	Alternator drive belt Delco 50DN	#5060055
---	Fan gearbox drive belt (MTH 40' & MTH 45E)	#506691
---	Fan gearbox drive belt (MTH 45')	#509822
---	Fan drive belt (MTH 40' & MTH 45E)	#506684
---	Fan drive belt (MTH 45')	#507627
---	Seltec compressor drive belt	#506685
---	05G Compressor drive belt, BX100 (MTH 40' & MTH 45')	#506664
---	05G Compressor drive belt, BX100 (MTH 45E)	#506681
---	Windshield wiper blade	#800329

* Item numbers refer to figure on lubrication and servicing points of this section.