

PREVOST

Instruction Sheet

IS-14905

HOT WATER VALVE REPLACEMENT

Use kit #374835 to replace former hot water valve assembly #373729.

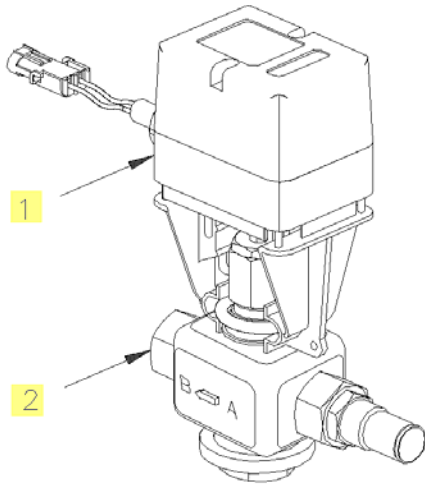

Diagram of valve assembly #373729. Callout 1 points to the valve actuator, and callout 2 points to the valve body assembly. The valve body has 'B' and 'A' markings and a 3/4" NPT fitting.

valve assembly #373729

Item	Num. pièce	Description
	373729	VALVE ASSY W/FITTING
1	871184	. VALVE ACTUATOR 0-10 VOLTS
2	871183	. VALVE BODY ASSY 3/4" NPT

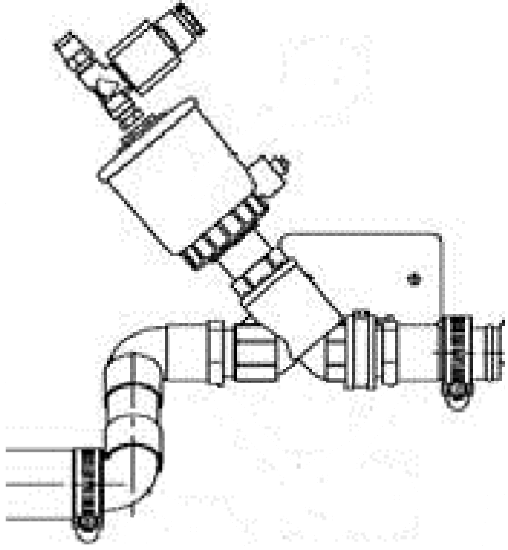

Diagram of kit #374835 valve assembly #373898, showing a different valve assembly with a different fitting configuration.

kit #374835 includes valve assembly #373898

MATERIAL

Kit #374835 includes the following parts:

Part No.	Description	Qty
373898	HOT WATER VALVE ASSEMBLY	1
503402	PNEUMATIC TUBING, PLAS NYL #4 BLACK	25 pi.
563204	CONNECTOR, HOT WATER VALVE	1
IS-14905	Instruction Sheet	1
FI-14905	Feuille d'instructions	1

NOTE

Material can be obtained through regular channels.

PROCEDURE



DANGER

Park vehicle safely, apply parking brake, stop engine. Prior to working on the vehicle, set the ignition switch to the OFF position and trip the main circuit breakers equipped with a trip button. On Commuter type vehicles, set the battery master switch (master cut-out) to the OFF position.

1. Close the two (2) hot water shut-off valves located on L.H. side of the engine (hot side).
2. In the evaporator compartment, cut the red, black and yellow wires at the existing hot water valve connector. The black and the red wires will be reused. Remove the existing valve.
3. Install the new hot water valve.
4. Route a new air line from the front service compartment (near the steering gear box) (FIGURE 1) up to the evaporator compartment.
5. In the front service compartment, connect the new air line to the accessories distribution block (see FIGURE 2).
6. In the evaporator compartment, connect the new air line to the new hot water valve.
7. In the evaporator compartment, hook up the water valve harness (black & red wires) to the connector #563204 screw terminals (refer to FIGURE 4).
 - black wire **0A** to pin **2**.
 - red wire **67V** to pin **1**.

Note: the yellow wire will not be reused. Place a piece of shrink tubing at the end of it.
8. Plug the connector to the hot water valve.
9. In the rear junction box, cut and remove wire **67A** at diode **D66** (see FIGURE 4).
10. Route a new wire from diode **D66** up to the HVAC logic panel (see FIGURE 4).
11. On the HVAC logic panel, install the new wire at pin terminal HEAT 1 (NC normally close).
12. Open the hot water shut-off valves.

13. Start the vehicle.

14. Check the new installation for leaks. Check the coolant level and replenish if needed.



FIGURE 1

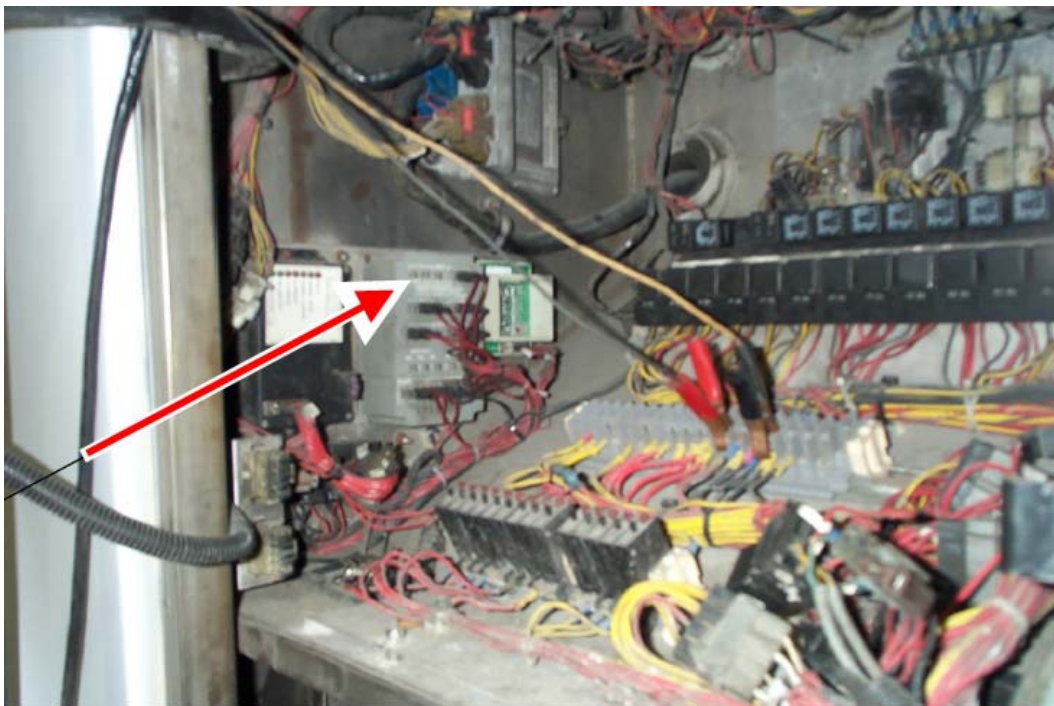

FIGURE 2

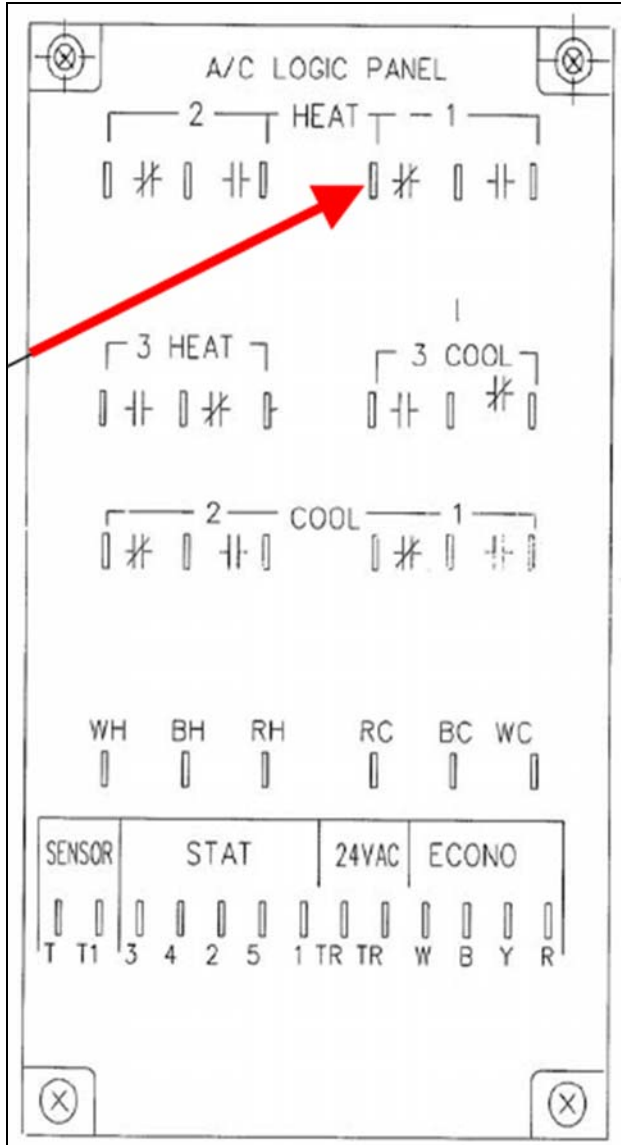

FIGURE 3 : HVAC LOGIC PANEL

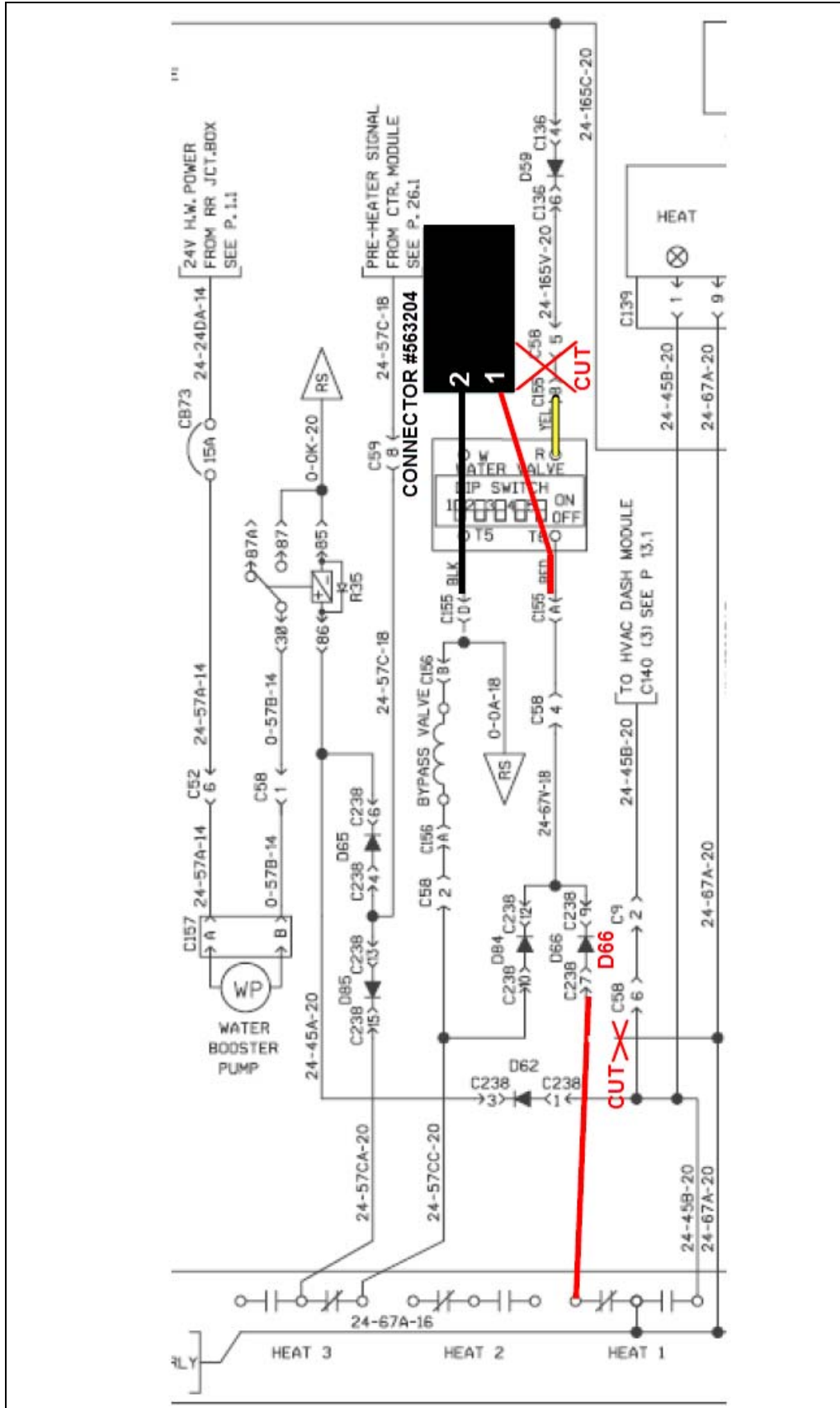

FIGURE 4

PARTS / WASTE DISPOSAL

Discard waste according to applicable environmental regulations (Municipal/State[Prov.]/ Federal)