



**PREVOST**

**SAFETY  
RECALL**

**SR22-10**

DATE :	Month 2022	SECTION :	18 BODY
SUBJECT:	REAR CROSS SEAT HARDWARE		

First Release

mm-dd-yy

**APPLICATION**

<b>NOTICE TO SERVICE CENTERS</b>	
<i>Verify vehicle eligibility by checking warranty bulletin status with <b>SAP</b> or via <b>ONLINE WARRANTY SYSTEM</b> available on Service / Warranty tab of PrevoSt website.</i>	
Model	VIN
X3-45 Commuter Model Year: 2021 - 2022	From 4RKJ33492M973 <u>7751</u> up to 4RKJ33499N973 <u>7991</u> incl.
<p><b>This Safety Recall does not necessarily apply to all the above-mentioned vehicles, some vehicles may have been modified before delivery. The owners of the vehicles affected by this recall will be advised by a letter indicating the Vehicle Identification Number (VIN) of each vehicle concerned.</b></p>	

**DESCRIPTION**

On vehicles affected by this recall, the rear bench seat frame could be loose. Follow the instructions to properly tighten the bolts on the rear bench. In case of missing hardware, refer to the parts list below.

**MATERIAL**

Parts may be required depending on seat condition.

Part No.	Description	Qty
868067	SCR CAP HEX 1/2-13X3 G5 ZP	A/R
868066	SCR CAP HEX 1/2-13X1 1/4 G5 ZP	A/R
865780	NUT	A/R
868070	SCR CAP HEX 3/8-16X1 G5	A/R
868116	WSH FL 3/8 X 1 X 11GA	A/R

<b>NOTE</b>
<i>Material can be obtained through regular channels.</i>

## SAFETY PRECAUTIONS

- Eye protection should always be worn when working in a shop.
- Rules for Personal Protection Equipment should always be respected. Wear your PPE including but not limited to the following:



# Safety First!



## PROCEDURE



### DANGER

Park vehicle safely, apply parking brake, stop the engine. Prior to working on the vehicle, set the ignition switch to the OFF position and trip the main circuit breakers equipped with a trip button. On Commuter type vehicles, set the battery master switch (master cut-out) to the OFF position.

Lockout & Tag out (LOTO) must be performed during set-up, maintenance or repair activities. Refer to your local procedure for detailed information regarding the control of hazardous energy.

## Removing the Cushions

1. Undo single bolt at the front of the cushion.

Tip: Screw back into frame to avoid losing screw!

2. Pull cushion towards you to free the 2 clips at the back and set aside.

Note: All 5 cushions are identical!

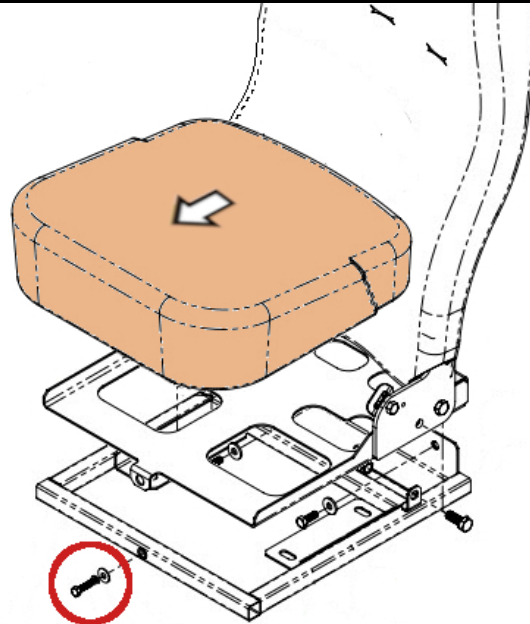
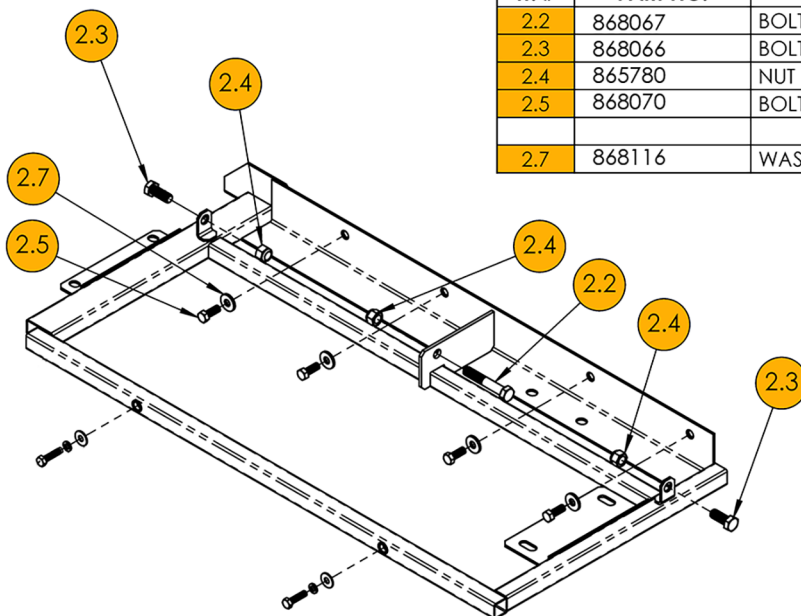

Figure 1 : CUSHION REMOVAL

3. If hardware is missing, refer to table and image below.



IT. #	PART NO.	DESCRIPTION	QTY.
2.2	868067	BOLT HXC G5 1/2-13 X 3 ZN	1
2.3	868066	BOLT HXC G5 1/2-13 X 1 1/4 ZN	2
2.4	865780	NUT HXD ST 1/2R-13 ZN	3
2.5	868070	BOLT HXC G5 3/8L16 X 1	4
2.7	868116	WASHER PLN ST 3/8 X 1 X 11GA	4

Figure 2 : HARDWARE LOCATIONS

### Torquing the 5 Backrests – FOLLOW THE SEQUENCE

*Curb side double seat is shown BUT REPEAT TORQUING FOR EVERY SEAT POSITION!*

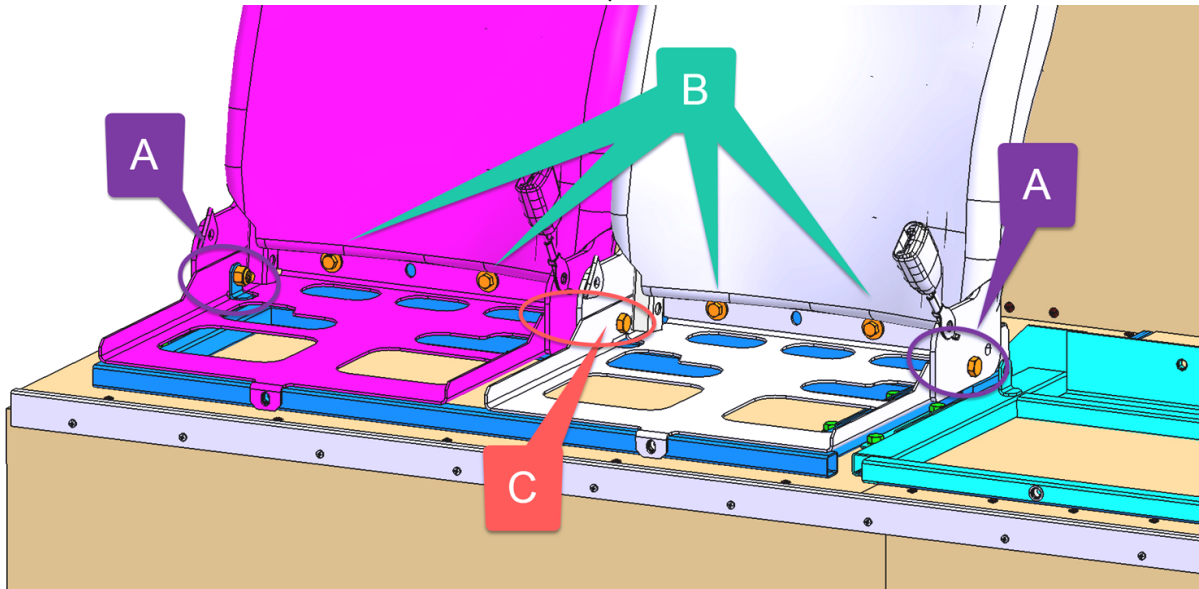
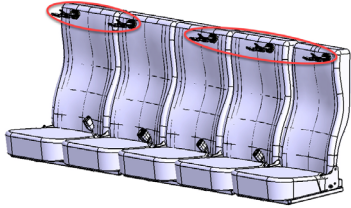
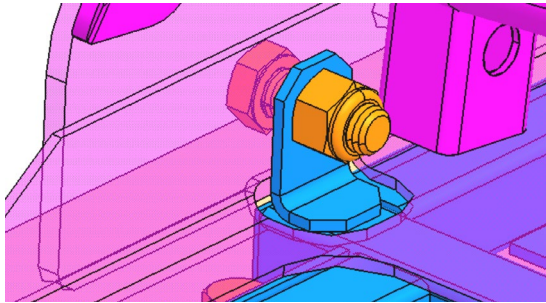
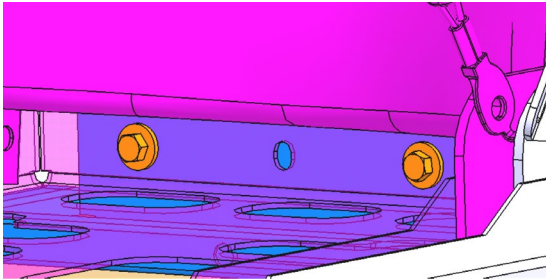
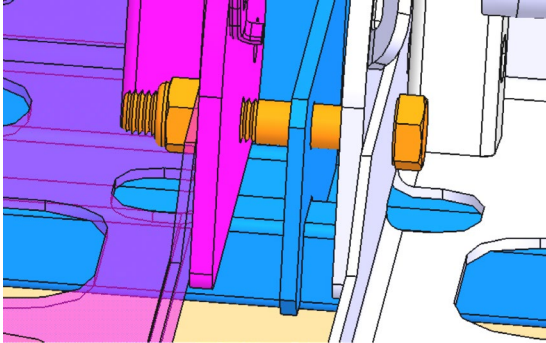
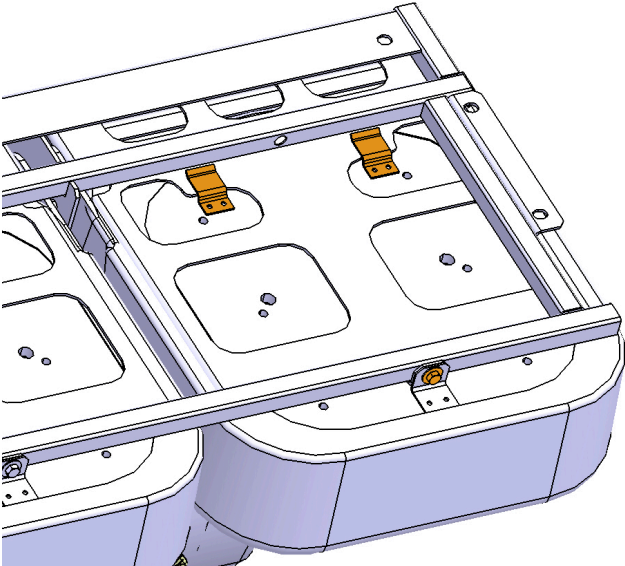

Figure 3 : HARDWARE POSITION KEY IMAGE

4	Backrest w/ RH belt, note number and position	qty 2	 <p style="text-align: center;"><b>Figure 4</b></p>
5	Backrest w/ LH belt, note number and position	qty 3	
6	<b>A) Side bolt</b> 1/2 x 1.25"	qty 2/seat	 <p style="text-align: center;"><b>Figure 5 : POSITION A</b></p>
7	<b>A) Nut</b> 1/2	qty 2/seat	
8	<div style="background-color: #4b0082; color: white; padding: 5px; display: inline-block;"> <b>A - Side Torque</b> (supplier value)         </div> <div style="margin-left: 20px; text-align: center;"> <b>60 lb-ft</b> <b>6x</b> </div>		
<u>Manual torque</u>			
9	<b>B) Back bolt</b> 3/8 x 1"	qty 2/seat	 <p style="text-align: center;"><b>Figure 6 : POSITION B</b></p>
10	<b>B) Flat washer</b>	qty 2/seat	
11	<div style="background-color: #008000; color: white; padding: 5px; display: inline-block;"> <b>B - Back Torque</b> (supplier value)         </div> <div style="margin-left: 20px; text-align: center;"> <b>25 lb-ft</b> <b>10x</b> </div>		
<u>Manual torque</u>			
12	<b>C) Middle bolt (long)</b> 1/2 x 3"	qty 1 /double seat	 <p style="text-align: center;"><b>Figure 7 : POSITION C</b></p>
13	<b>C) Nut</b> 1/2	qty 1 /double seat	
14	<div style="background-color: #ff0000; color: white; padding: 5px; display: inline-block;"> <b>C - Middle Torque</b> (supplier value)         </div> <div style="margin-left: 20px; text-align: center;"> <b>60 lb-ft</b> <b>2x</b> </div>		
<u>Manual torque</u>			
<p style="color: red; margin: 0;"><b>Caution: This is a soft joint!!!</b></p> <p style="color: red; margin: 0;">If you struggle to reach the desired torque, don't push it - you don't want to start bending the frames! Make sure the bolt is tight and cannot be moved with fingers whatsoever.</p>			

Reinstalling the Seat Cushions		
15	Seat cushion	qty 5/veh
16	<p style="color: red; text-align: center;"><b>Once everything is tight, torqued and torque sealed</b></p> <p>Slide the cushions back in place, making sure the 2 clips engage, and secure with the front bolt. (see below for upside down picture)</p>	
17	Bolt 5/16 x 1.25	qty 1/cushion
18	Split lock	qty 1/cushion
19	Flat washer	qty 1/cushion



**Figure 9**

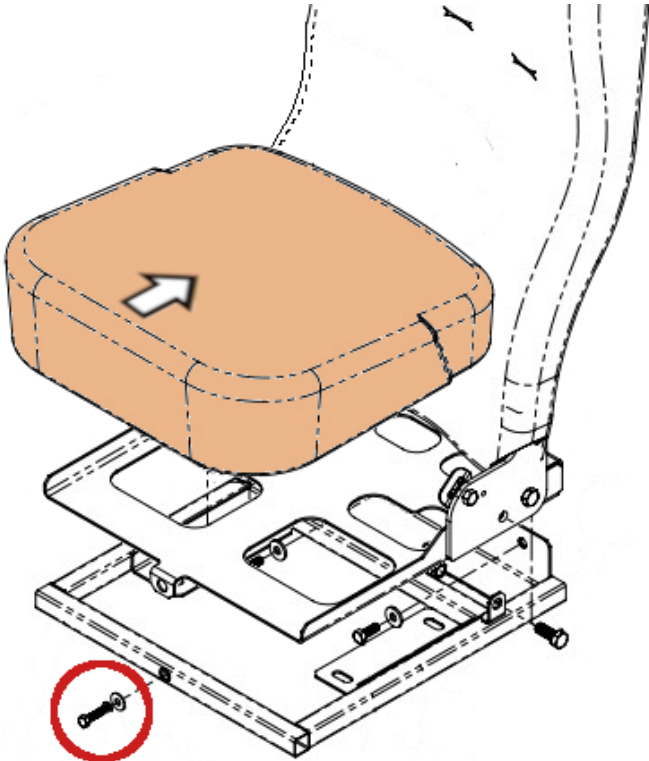

**Figure 8**

## PARTS DISPOSITION

DO NOT RETURN THE REPLACED PARTS. Discard waste according to applicable environmental regulations (Municipal/State[Prov.]/ Federal)

## WARRANTY

This modification is covered by Prevest's normal warranty. We will reimburse you the parts and thirty minutes (30 min) of labor upon receipt of a completed A.F.A. Please submit claim via our Online Warranty System, available at [www.prevestcar.com](http://www.prevestcar.com) (under service \ warranty section). Use Claim Type: "Bulletin/Recall" and select "Safety Recall 0BSR22-10".

Should you only wish to close the safety recall (without reimbursement), fill-in the "Safety Recall Certification Sheet" provided with this bulletin and return it to our warranty department by Email at [prevost.onlinewarranty@volvo.com](mailto:prevost.onlinewarranty@volvo.com) or by fax at 418-831-9301.

## OTHER

VBC Bulletin	N/A
Fail Code	18.03-2
Defect Code	09
Syst.Cond	R
Causal Part	868085

Access all our Service Bulletins on <http://techpub.prevostcar.com/en/> or scan the QR-Code with your smart phone.  
E-mail us at [technicalpublications\\_prev@volvo.com](mailto:technicalpublications_prev@volvo.com) and type "ADD" in the subject to receive our warranty bulletins by e-mail.





# Safety Recall Certification Sheet (Ref: SR22-10)

VEHICLE SERIAL NUMBER:

2	P	C																	
---	---	---	--	--	--	--	--	--	--	--	--	--	--	--	--	--	--	--	--

PERFORMED BY		OWNER/OPERATOR	
We hereby certify that Safety Recall Instructions with regard to Safety Recall SR18-XX have been performed.			
Name: _____		Name: _____	
Addr: _____		Addr: _____	
Phone: _____		Phone: _____	
Fax: _____		Fax: _____	
Signature :	_____	Signature :	_____
Date:	_____	Date:	_____

If the information mentioned above is incorrect or you are not the owner of this vehicle anymore, please fill this section and return to sender.

**NEW OWNER:**

**BUSINESS:**

**ADDRESS (including County):**

---



---



---



---



---

**TELEPHONE:** \_\_\_\_\_

**FAX:** \_\_\_\_\_

**Please return this completed document with your A.F.A. form**