

Operating Instructions

Seat safety belts

9700 US/CAN



T0015398

VOLVO

Foreword

These operating instructions contain information about the safety belts both of the passengers seats and of the driver seat.

Illustrations are used for reference only and may differ slightly from the actual vehicle. However, key components are represented as accurately as possible.

Volvo Bus Corporation

Göteborg, Sweden

Order number: 89316576

©2017 Volvo Bus Corporation, Göteborg, Sweden

All rights reserved. No part of this publication may be reproduced, stored in retrieval system, or transmitted in any forms by any means, electronic, mechanical, photocopying, recording or otherwise, without the prior written permission of Volvo Bus Corporation

Contents

Introduction	1
Reporting safety defects	2
Using the seat safety belt	3
Fastening and adjusting the belt	4
Driver seat safety belt reminder	6
Locking retractor modes in the passenger seat safety belts	7
Child restraint systems	8
Inspection of the seat safety belt systems	9
Inspection of the belt straps	10
Inspection of the buckles and latches	10
Inspection of the retractors	11
Inspection of the anchor (driver seat)	12
Inspection of the metallic fixing points	12
Final suggestions	13
Index	15

Safety Information

IMPORTANT: Before driving this vehicle, be certain that you have read and that you fully understand each and every step of the driving and handling information in this manual. Be certain that you fully understand and follow all safety warnings.

It is important that the following information be read, understood and always followed.

The following types of advisories are used throughout this manual:



DANGER

Danger indicates an unsafe practice that could result in serious personal injury or death.



WARNING

Warning indicates an unsafe practice that could result in personal injury.



CAUTION

Caution indicates an unsafe practice that could result in damage to the product.

Note: Note indicates a procedure, practice, or condition that must be followed in order for the vehicle or component to function in the manner intended.

The safety seat belt assemblies installed in the vehicle comply with the applicable motor vehicle safety standards at the time of vehicle manufacture. They are recommended for all persons measuring minimum 49" (1.24 m).



DANGER

A child restraint system should be used for each child measuring maximum 49" (1.24 m). Carefully read and follow the child restraint manufacture's instructions on installation and use of the child restraint system when in use. Make sure that the child remains in the restraint system at all times while the vehicle is in motion. Failure to do so can result in serious personal injury or death.

2 Reporting safety defects

If you believe that your vehicle has a defect which could cause a crash or could cause injury or death, you should immediately inform the National Highway Traffic Safety Administration (NHTSA), in addition to notifying Prevest.

If NHTSA receives similar complaints, it may open an investigation, and if it finds that a safety defect exists in a group of vehicles, it may order a recall and remedy campaign. However, NHTSA cannot become involved in individual problems between you and your dealer or Prevest.

To contact NHTSA, you may call the Vehicle Safety Hot line toll-free at 1-888-327-4236 (TTY: 1-800-424-9153), go to <http://www.safercar.gov> or write to Administrator, NHTSA, 1200 New Jersey Ave. SE., Washington, DC 20590.

To contact Prevest, in United States and Canada, call to Prevest Action System (PASS) at 1-800-463-7738, or visit <https://www.prevestcar.com/contact-us/regional-service-managers> to find a service manager. In Mexico, call to Volvo Action Service (VAS) at 01 800 90 94 900.

Using the seat safety belt is the single most important thing that can be done for protection in the event of a crash.

The seat must be adjusted before fastening or adjusting the belt. In the event of a collision, a correct position maximizes the effectiveness of the belt.

There are both Federal and State laws governing the use of seat safety belts. As laws differ from state to state, make yourself familiar with the current rules.



DANGER

Seat safety belts must be properly worn at all times while the vehicle is in motion. Failure to do so can result in serious personal injury or death in the event of collision.



DANGER

Never wear the shoulder portion of the belt under your arm or behind your back. Improper use will increase your chances of injury during a collision



DANGER

To prevent possible injury, the belt must be positioned low over the pelvis, below the abdomen. If the belt is buckled too high, it will apply force to the abdomen, not the pelvic region, and could cause serious internal injuries during a sudden stop.



DANGER

Do NOT wear seat belt loosely. Do NOT use one belt for more than one person.

4 Fastening and adjusting the belt

DANGER

Never try to adjust or fasten the seat belt in a different way than the described in this chapter. Failure to do so may cause serious personal injury or death in case of an accident.

DANGER

Fastening the driver's seat safety belt should only be performed when the vehicle is stationary, with the parking brake applied. Failure to do so may lead to an accident, causing serious personal injury or death.

To fasten the belt, pull the belt out from the retractor (1) and insert the latch into the buckle (2). The buckle clicks when the latch is engaged. In the driver seat, the retractor is mounted on the B-pillar, just behind the driver window. In the passenger seats, the retractors are mounted directly in the seats.

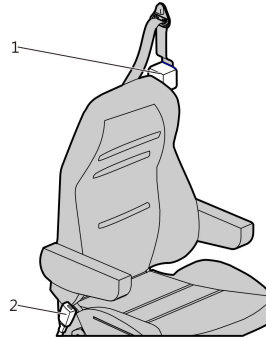

W0125791

Fastening the driver seat safety belt: retractor (1) and buckle (2).

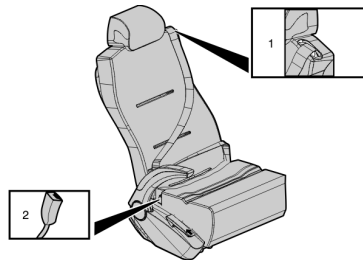

W0126187

Fastening the passenger seat safety belt: retractor (1) and buckle (2).

Fastening and adjusting the belt 5

Always confirm that the latch is engaged: Pull it to try to take it out. If it stays in the buckle, it is engaged.

After confirming that the latch is engaged, adjust the belt so that it is snugged against the body. Adjust the slack by pulling on the top part of the belt until the lap part is snugly adjusted. The top part should be worn over the shoulder and crossing the chest, away from the neck. The lap portion should be worn low across the pelvic region (hip bone). After adjusting the belt, release it and let the retractor pull it in.

Note: The safety belt should not be twisted or blocked when properly fastened.

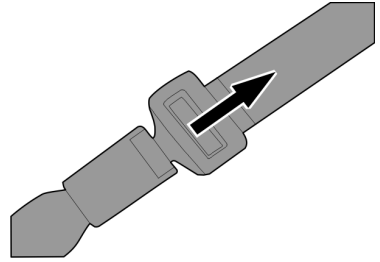

W0126197

Safety belt engagement confirmation.

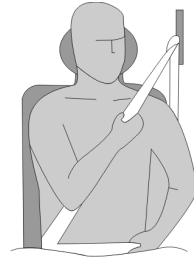

W0126287

Correct adjustment of the safety belt.

6 Fastening and adjusting the belt

To unfasten the belt, after the trip, use the push button on the buckle to release the latch.

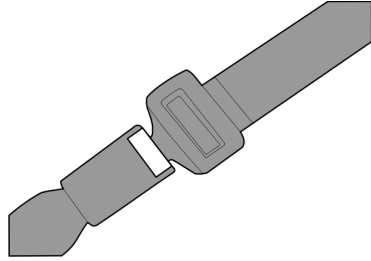

W0126200

Unfastening the belt.

Driver seat safety belt reminder

A reminder in the instrument cluster warns you if the driver seat safety belt is not fastened. This signal activates when you start the bus. When you move the bus, a sound signal activates if the safety belt is still not fastened. Stop the bus (if moving) and fasten the safety belt to deactivate both signals.



T0012001

Driver seat safety belt reminder.

Locking retractor modes in the passenger seat safety belts 7

The passenger seat safety belts are equipped with automatic/emergency locking retractor modes. The information below describes how the modes work:

- **Automatic Locking Retractor (ALR) mode:** Locks and maintains a fixed belt length during use (the belt cannot be extended further). It is intended for use with a child seat. To activate this mode, pull the belt all the way out, insert the latch into the buckle and let the belt to retract to the desired length. Check that the belt is fully tightened and the retractor is locked. Unbuckle the belt and allow it to retract to fully deactivate the ALR mode.
- **Emergency Locking retractor (ELR) mode:** Allows the belt to move freely. The belt locks only when the vehicle decelerates or stops suddenly, or when the passenger moves abruptly. It is intended for the passenger who sits directly in the seat or when a booster seat is used. It will not secure a child seat. To activate this mode, pull out only the necessary length of belt (do not pull it all the way out) and follow the instructions given in chapter “Fastening and adjusting the belt”, page 4.

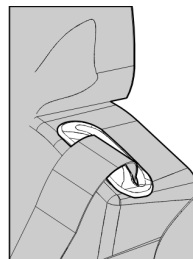

W0126203

Passenger seat safety belt retractor.



DANGER

When using a child seat, do not use the ELR mode. Failure to do so may lead to serious personal injury or death in case of an accident.



DANGER

When using a booster seat, do not use the ALR mode. Failure to do so may lead to serious personal injury or death in case of an accident.

8 Child restraint systems

Passengers under 49" (1.24 m) height must use a compliant (i.e. complies with applicable laws) child restraint system. To install the corresponding system, follow the child restraint system manufacturer's instructions.

For a child seat, activate the automatic locking retractor (ALR) mode.

For a booster seat, use the emergency locking retractor (ELR) mode.

For more information about the locking retractor modes, see chapter "Locking retractor modes in the passenger seat safety belts", page 7.

Note: If the ELR mode is to be used, follow the instructions given in chapter "Fastening and adjusting the belt", page 4 to fasten and adjust the belt correctly.



DANGER

When using a child seat, do not use the ELR mode. Failure to do so may lead to serious personal injury or death in case of an accident.



DANGER

When using a booster seat, do not use the ALR mode. Failure to do so may lead to serious personal injury or death in case of an accident.

Inspection of the seat safety belt systems 9

It is very important to inspect and maintain the safety belt systems. When inspecting, look for loose/damaged parts and check that the operation is correct. If there is any doubt about the effectiveness of any system, replace it completely.

In the passenger seat safety belt systems, check the belt straps (1), the buckles (2), the latches (3) and the retractors (4).

In the driver seat safety belt system, check the belt strap (1), the latch (2), the buckle (3), the anchor (4), the retractor (5) and the metallic fixing points.

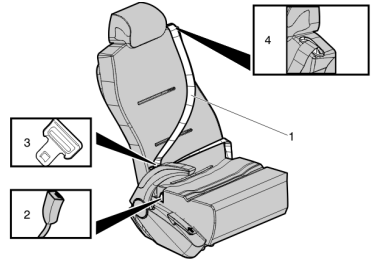

W0126228

Inspection of the passenger seat safety belt systems.

DANGER

Any time that a vehicle is involved in an accident, the entire safety belt system must be replaced. Failure to do so may result in serious personal injury or death in case of an accident.

DANGER

The safety belt systems should be replaced at least every five years. A damaged safety belt, whether visibly damaged or not, could result in serious personal injury or death in case of an accident.

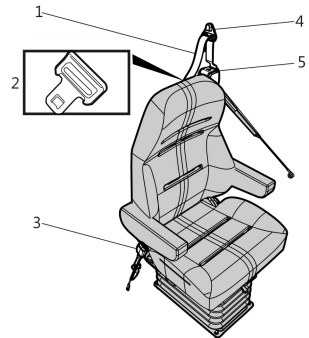

W0126234

Inspection of the driver seat safety belt system.

10 Inspection of the seat safety belt systems

Inspection of the belt straps

Check the web at the buckle/latch area. The web must be closely examined to determine if there are any cuts, fraying or extreme wear. These conditions indicate the need for replacement of the safety belt system. Check the web in areas exposed to ultra-violet rays from the sun or extreme dust or dirt. If the original color of the web in these areas is extremely faded, its physical strength may be deteriorated. If this condition exists, replace the safety belt system.

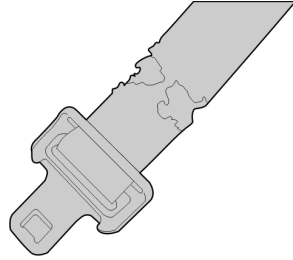

W0126288

DANGER

Do not bleach or re/dye the belt strap because it may cause a severe loss of strength. This loss of strength could lead the safety belt to break under stress. This in turn can result in serious personal injury or death in case of an accident.

Inspection of the buckles and latches

Check the buckle by inserting the latch and verifying a proper operation. Determine if the latch plate is worn or deformed. Check the buckle and latch casing for cracks or breakage.

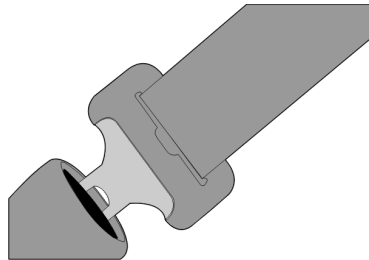

W0126289

Inspection of the retractors

The retractor is the heart of the safety belt system and can be damaged if abused, even unintentionally. Check the retractor operation to ensure that it is not locked and that it rolls and unrolls the belt strap properly.

In the driver seat, the retractor is mounted on the B-pillar, just behind the driver window. In the passenger seats, the retractors are mounted directly in the seats.

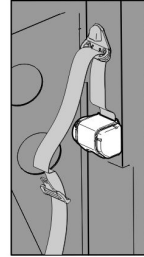

W0126241

Driver seat safety belt retractor.

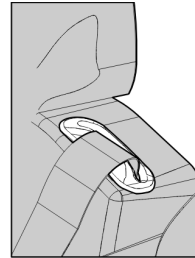

W0126203

Passenger seat safety belt retractor.

12 Inspection of the seat safety belt systems

Inspection of the anchor (driver seat)

Check that the anchor is well fixed and that it is not broken or cracked.



W0126244

Inspection of the metallic fixing points

All metallic fixing points for the seat safety belt systems must be evaluated for corrosion. Also check that the attachments of the systems are well tightened.

The high mileage associated with buses and the potential exposure of safety belts to severe environmental conditions make it crucial to inspect the seat belt systems regularly. It is recommended that the system be inspected every 15,000 miles (24,000 km) or more often if the vehicle is exposed to severe conditions. Any safety belt system that shows cuts, fraying, extreme or unusual wear, significant discolorations due to ultra-violet ray exposure, dusty-dirty conditions, abrasion to the safety belt webbing or damage to the buckle, latch plate, retractor, hardware or any other obvious problem should be replaced immediately, regardless of the mileage.

Once the replacement of the safety belt has been determined necessary, be certain that it is replaced only with a Volvo original replacement safety belt. Contact your authorized Volvo service supplier or, for Prevost supported vehicles, the Prevost service center/supplier for replacement. Replace the safety belt only with exactly the same design that the vehicle was originally equipped with. If the inspection indicates that any other part of the safety belt system requires replacement, the entire safety belt system must be replaced. It is very important that all components are mounted back in the same positions as the original components that were removed. This will maintain the design integrity of the mounting points for the safety belt assembly.

A

Adjusting the belt 4
Anchor (driver seat),
inspection 12
Automatic Locking Retractor
(ALR) mode 7

B

Belt straps, inspection 10
Buckles, inspection 10

C

Child restraint systems 8

D

Driver seat safety belt
reminder 6

E

Emergency Locking
Retractor (ELR) mode 7
Engagement confirmation 5

F

Fastening and adjusting the
belt 4–6

Fastening the belt 4
Final suggestions 13

I

Inspection of the seat safety
belt systems 9–12
Introduction 1

L

Latches, inspection 10
Locking retractor modes 7
Locking retractor modes in
the passenger seat safety
belts 7

R

Reporting safety defects 2
Retractors, inspection 11

S

Safety defects, reporting 2
Safety Information 5

U

Using the seat safety belt 3

VOLVO

Volvo Bus Corporation

Göteborg, Sweden